

City of Seward, NE

Tuesday, June 2, 2015

Regular Session

Item G6

CONSIDERATION OF A PLAN FOR STORM WATER RUNOFF AND SANITARY SEWER IMPROVEMENTS FOR ST. JOHN'S NEW DAYCARE CENTER TO BE LOCATED AT HILLCREST DR AND COLUMBIA AVE - John Hughes

Consideration of financial participation in the relocation of sanitary sewer line and improvements

Consideration of financial participation in the relocation storm sewer and consideration of constructing a new storm sewer line

Administrative Report: St. John's Church is constructing a new Child Development Center on the property to the north of St. John Church/School located at the intersection of Columbia Ave. and Hillcrest Drive.

They are proposing relocating a current storm drain and a sanitary sewer line that cuts across the property and have reviewed the storm drainage system in this area and are proposing a new line be constructed.

They are requesting the City consider participating in the financial aspects of relocating and constructing the infrastructure.

Following the presentation and discussion, Council to provide direction to staff.

Staff Contact:

Proclaiming and Practicing the Love of Christ

28 May 2015

City Council Members
C/o City of Seward, NE
142 N. 7th Street
Seward, NE 68434

Dear Council Members:

Thank you for this opportunity to present the attached information regarding storm sewer and sanitary sewer issues impacting the upcoming construction of our new Child Development Center.

We are happy to report that we will be proceeding with the construction of a new Child Development Center within the next few weeks on our site located just north of St. John Church/School located at the intersection of Columbia Ave. and Hillcrest Drive. This project will allow us to expand our current enrollment and provide the community with much needed child care space. We are excited about the opportunity to further our mission to children and their parents.

There are two issues impacting our construction at this site. First is the current size of the existing 30 inch reinforced concrete storm drain that cuts across the property from the northeast to the southwest (see attached site plan). According to calculations done by our Civil Engineer this line is undersized and will not handle a 5 year storm event which does not meet design standards. He also suggests that this line be upsized from its current size to a 48 inch reinforced concrete pipe. Installing this new 48 inch storm sewer now will prevent having to dig up the existing 30 inch storm sewer and installing the new 48 inch storm line under our proposed parking lot in the future.

Secondly the existing sanitary sewer line like the storm sewer cuts across the property and will need to be relocated to allow for the building construction as it currently located under our proposed building. The new line will be much more accessible and be upgraded with a new 8 inch PVC piping.

We feel that the relocation of these lines and the construction of the project would be of mutual benefit as it meets a large community need and the city receives new updated accessible utility lines. Therefore we are asking the City of Seward to share in the cost of the relocation of the sanitary sewer line. The sanitary sewer line plans have been approved by DEQ and the construction of this line is to begin soon. We will be prepared to share the amount of these costs at your upcoming council meeting.

With our engineers review of the existing 30 inch storm line, we are suggesting that in coordination with our construction schedule, that the city designs and constructs the new 48 inch storm line at this time. We are willing to provide the required easements to construct and maintain the city owned storm sewer. If it's of any benefit we are open to delaying the construction of our parking lot work to a later date to better align with your funding cycle.

It should be noted that we already have a contractor on board (Hampton Construction) and we have bids for the work to relocate these lines. We have been coordinating this work with your Utilities Department and this work will be done to City of Seward standards. We feel it may be more cost effective to have this work done in conjunction with the other site utilities work on our project than as separate projects. If you concur, we would be happy to coordinate this work with our contractor with City supervision.

One other issue we would like to address is the storm drainage system in this area. Our Civil Engineer has done some calculations of the drainage area served by this line and has confirmed that it is undersized. We understand that the City is aware of this issue and is looking into a long term solution. We further understand this will take significant resources and time to correct. In the interim we would like to offer an option that would mitigate the problem in this area. St. John would be willing to donate a parcel of land just to the east of the Child Development Center site to be used as a detention cell (see attached site plan). The City would have ownership and maintenance of this property and would provide the construction of the detention cell.

Finally we would also like to extend our willingness to provide the City an easement on the west end of the Child Development Center site for the placement of a new sanitary sewer. This would allow the abandonment of the current line that runs under the residence just west of our site on Hillcrest Drive. If accepted, we would expect the City to provide the construction of this line.

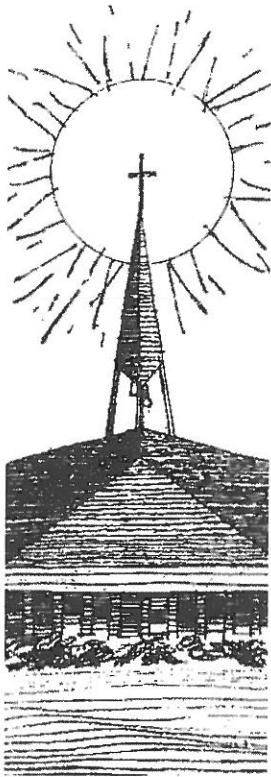

**The
Ministries
of
St. John
Lutheran**

www.stjohnseward.org

Church

919 N Columbia AVE
Seward, NE 68434
402-643-2983

School

877 N Columbia AVE
Seward, NE 68434
402-643-4535

Child Development Center

20 Main ST
Seward, NE 68434
402-643-3122

*The Lutheran Church—
Missouri Synod*

Proclaiming and Practicing the Love of Christ

We are planning on attending your next meeting on Monday June 2, 2015 and will be happy to answer any questions you might have at that time. If you have questions or need additional information before your meeting, feel free to call me at (402) 803-0589.

Thank you in advance for considering our request. We look forward to visiting with you on June 2nd.

Sincerely

Jeff Voehl
Trustee, Building Committee

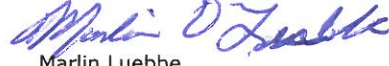
Marlin Luebke
Trustee, Building Committee

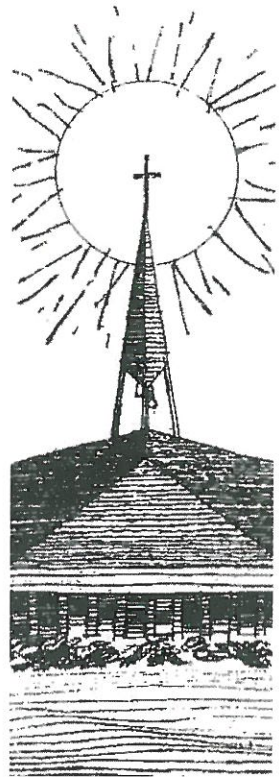

**The
Ministries
of
St. John
Lutheran**
www.stjohnseward.org

Church
919 N Columbia AVE
Seward, NE 68434
402-643-2983

School
877 N Columbia AVE
Seward, NE 68434
402-643-4535

**Child
Development
Center**
20 Main ST
Seward, NE 68434
402-643-3122

*The Lutheran Church—
Missouri Synod*



ARCHITECT
BAHR VERMEER HAECKER ARCHITECTS
440 N 8TH ST STE 100
LINCOLN NE 68508
V 402 475 4551
F 402 475 6726
bvh.com

CIVIL ENGINEER
REGA ENGINEERING GROUP, INC.
601 OLD CHENEY RD., SUITE A
LINCOLN, NE 68512
V 402 484 7342
F 402 484 7344
regagroup.com

STRUCTURAL ENGINEER
R.O. YOUNGER, INC.
1201 O Street, Suite 310
LINCOLN NE 68508
V 402 477 7640
F 402 477 7331
royounger.com

MECHANICAL/ELECTRICAL ENGINEER
ENGINEERING TECHNOLOGIES, INC.
315 N STREET STE 201
LINCOLN NE 68508
V 402 476 1273
F 402 476 1274
et-engineers.com

Revision Schedule	
Date	Description

ST. JOHN
CHILD DEVELOPMENT
CENTER
100% CONSTRUCTION SET
PROJECT: 117374-1 DATE: 07 APRIL 2015
© COPYRIGHT 2015 REGA

GMP RECORD SET
NOT FOR CONSTRUCTION

UTILITY PLAN

Project North



C1.4



NORTH
SCALE 1" = 20'

20 40 60

UTILITY NOTES:

- CONTRACTOR SHALL PROVIDE ALL BENDS, TEES, ELBOW, BACKING BLOCKS AND CORPORATION STOPS AS REQUIRED BY LOCAL CODES TO PROVIDE A FULLY FUNCTIONAL WATER SUPPLY SYSTEM WHETHER SHOWN ON THE DRAWINGS OR NOT. ALL WATER SUPPLY FITTINGS SHALL BE SUPPLIED, INSTALLED AND LOCATED IN ACCORDANCE WITH THE "TEN STATE STANDARDS" AND LOCAL CODES GOVERNING CONSTRUCTION. ADJUST FITTING LOCATION AS REQUIRED TO MEET CODE REQUIREMENTS. THE CONTRACTOR SHALL CONTACT THE SEWARD WATER SYSTEM FOR ITEMS PROVIDED BY THEM.
- ALL PIPE AND FITTINGS SHALL MEET THE CITY OF SEWARD PLUMBING CODES MOST CURRENT ADDITION.
- ALL WATER MAINS SHALL HAVE A MINIMUM COVER OF 5'-0" ABOVE TOP OF PIPE.
- BED ALL WATER LINES PER CITY OF SEWARD SPECIFICATIONS.
- DIMENSIONS SHOWN ARE TO CENTERLINE OF PIPES OR FITTINGS AND ARE FROM PROPERTY LINES, CENTERLINES OF DRIVEWAYS, BACK OF CURBS, EDGES OF SIDEWALKS OR FACES OF WALLS.
- ALL WATER MAINS SHALL BE HYDROSTATICALLY TESTED AND DISINFECTED BEFORE ACCEPTANCE.
- ALL GATE VALVES SHALL BE PROVIDED WITH ROADWAY SCREW TYPE CAST IRON VALVE BOX. BOXES FOR 3" AND SMALLER SHALL HAVE ARCH BASE.
- VALVES AND GATES SHALL MEET CITY OF SEWARD PLUMBING CODES MOST CURRENT ADDITION.
- UTILITY CONTRACTOR SHALL HAVE APPROVAL OF ALL GOVERNING AGENCIES HAVING JURISDICTION OVER THE SYSTEM PRIOR TO INSTALLATION.
- SANITARY SEWER CONSTRUCTION SHALL BE IN ACCORDANCE WITH THE LATEST EDITION OF THE CITY OF SEWARD STANDARD SPECIFICATIONS FOR MUNICIPAL CONSTRUCTION.
- THE "TEN STATE STANDARDS" FOR SEWER AND WATER SEPARATION SHALL BE CONFORMED TO.
- CONCRETE FOR MANHOLES SHALL BE 3500 PSI AS PER THE CITY OF SEWARD STANDARD SPECIFICATIONS.
- ALL SANITARY & WATER LINES TERMINATE 5'-0" OUTSIDE BUILDING FOR CONTINUATION SEE MECHANICAL PLANS.
- ALL SANITARY LINES SHALL BE SDR 35 PIPE.
- ALL HDPE STORM PIPE SHALL BE SMOOTH INTERIOR WALL PIPE.
- UTILITY CONTRACTOR SHALL COORDINATE STORM LINES UNDER THE BUILDING WITH FOOTING CONTRACTOR.
- BED ALL STORM/SANITARY LINES PER CITY OF SEWARD SPECIFICATIONS.

LEGEND

- S-S-SANITARY SEWER LINE (8 C2.1)
- W-W-WATER LINE (1 C2.1)
- P.I.V.-POST INDICATOR VALVE (3 C2.1)
- W-W-WATER VALVE
- A-SANITARY MANHOLE
- C-C-CLEANOUT (5 C2.1, 7 C2.1)
- A-AREA INLET (9 C2.1)
- SS-STORM SEWER LINE (8 C2.1)
- RD-ROOF DRAIN (10 C2.1)
- FOUNDATION DRAIN, SEE ARCHITECTURAL AND MECHANICAL PLANS FOR CONTINUATION.
- UGE-UNDERGROUND ELECTRICAL, SEE ELECTRICAL PLANS
- P-PARKING LOT LIGHTING, SEE ELECTRICAL PLANS
- A-TRANSFORMER LOCATION, SEE ELECTRICAL PLANS

Retain the Location Request Number for YDRS Dem Protection!

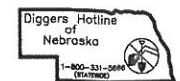

NOTE:
UNDERGROUND UTILITY LOCATIONS SHOWN ARE FROM INFORMATION PROVIDED TO US FROM UTILITY COMPANIES. UTILITY COMPANIES MAKE NO WARRANTIES OR GUARANTEES REGARDING THE ACCURACY OF THE INFORMATION CONTAINED IN THEIR DOCUMENTS AND PROVIDES IT ONLY AS GENERAL INFORMATION TO THE RECEIVER FOR SPECIFIC LOCATIONS DURING CONSTRUCTION CALL "DIGGERS HOTLINE" 1-800-331-5868 (STATEWIDE) PRIOR TO DIGGING.

BENCHMARK INFO:

BENCHMARK #1: CURB INLET MANHOLE AT S.W. CORNER OF PROPERTY ALONG HILLCREST DR. NORTH RM=1483.12
BENCHMARK #2: CURB INLET MANHOLE AT N.E. CORNER OF PROPERTY ALONG COLUMBIA AVE. NORTH RM=1485.33

REGA NO. 121180

ISSUED FOR:

100% CONSTRUCTION SET

DATE: 04/07/15

BY: SDB/NB

REVIEW BY: NB/DR

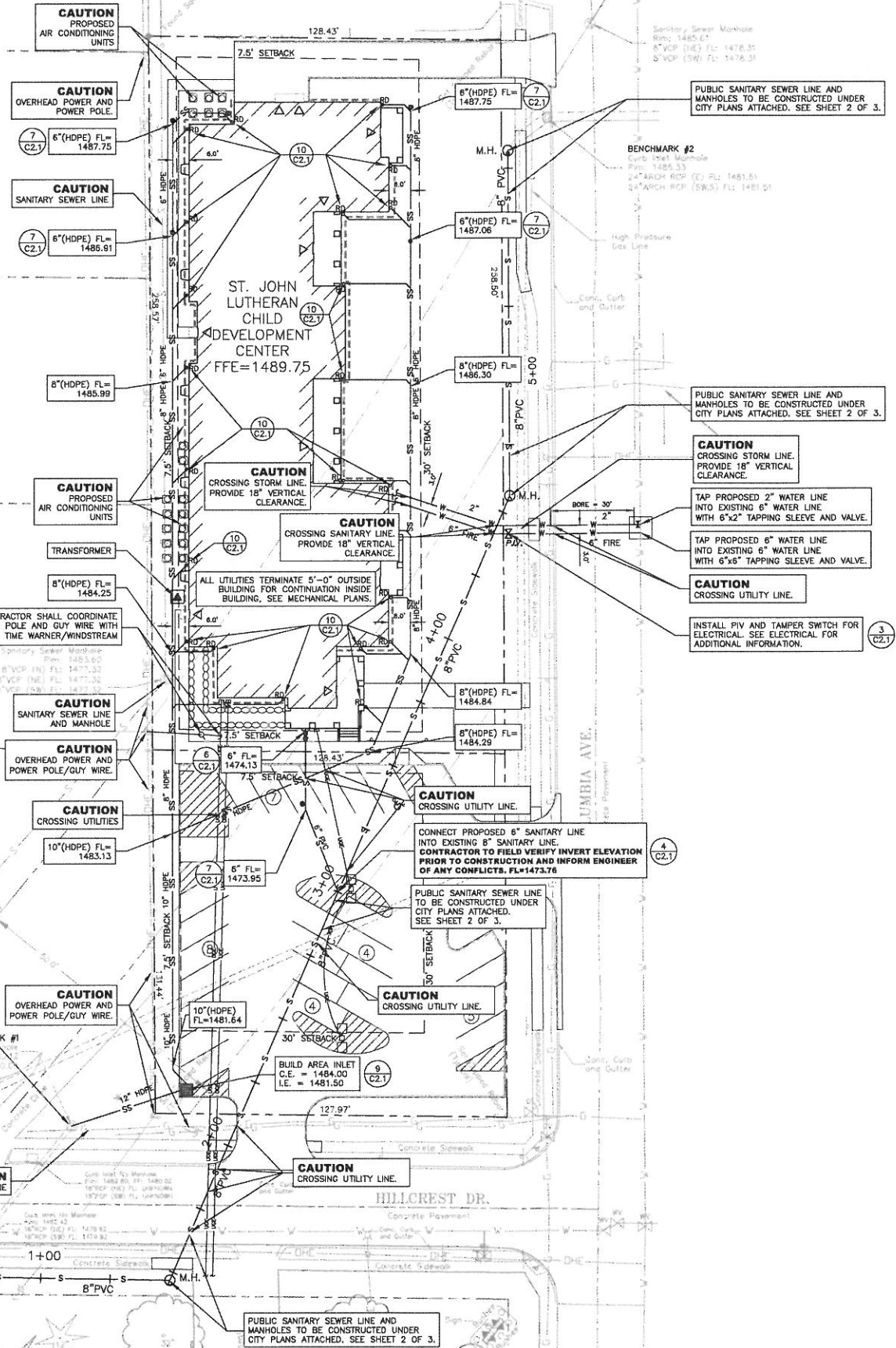

CONNECT PROPOSED 12" HDPE STORM LINE INTO EXISTING STORM MANHOLE INLET FL (8") = 1480.50
CONTRACTOR TO FIELD VERIFY INVERT ELEVATION PRIOR TO CONSTRUCTION AND INFORM ENGINEER OF ANY CONFLICTS.

CAUTION
OVERHEAD POWER AND
POWER POLE/GUY WIRE.

CAUTION
CROSSING UTILITY LINE.

CAUTION
CROSSING UTILITY LINE.

PUBLIC SANITARY SEWER LINE
TO BE CONSTRUCTED UNDER
CITY PLANS ATTACHED. SEE SHEET 2 OF 3.

PUBLIC SANITARY SEWER LINE AND
MANHOLES TO BE CONSTRUCTED UNDER
CITY PLANS ATTACHED. SEE SHEET 2 OF 3.