

City of Scottsbluff, Nebraska

Tuesday, February 16, 2016

Regular Meeting

Item Consent2

Approve Bids and Specifications for the Scottsbluff Intersection Bulb-Out Project and authorize city clerk to advertise for bids to be received by March 9, 2016 at 2:00 p.m.

Staff Contact: Mark Bohl, Public Works Director

**Advertisement for Bids
Scottsbluff Downtown Intersection Bulb-Out Construction Project**

Owner: City of Scottsbluff
Address: 2525 Circle Drive, Scottsbluff, NE 69361

Sealed Bids for the Scottsbluff Downtown Intersection Bulb-Out Construction Project for the City of Scottsbluff, will be received by Cindy Dickinson, City Clerk at City Hall, 2525 Circle Drive, Scottsbluff, Nebraska until 2:00 P.M., (Local Time) March 9, 2016, and then at said office publicly opened and read aloud.

The Contract Documents may be examined at the following locations:
City of Scottsbluff
2525 Circle Drive
Scottsbluff, NE 69361

M.C. Schaff & Associates
818 South Beltline Highway East
Scottsbluff, NE 69361

Copies of the Contract Documents may be obtained at the office of M.C. Schaff & Associates located at 818 South Beltline Highway East, Scottsbluff, NE 69361 upon payment of \$25.00 for each set, none of which will be refunded.

/s/ Cindy Dickinson
City Clerk

Publish three times:
2/19/2016
2/26/2016
3/4/2016

BID FORM FOR CONSTRUCTION CONTRACTS

Prepared by

ENGINEERS JOINT CONTRACT DOCUMENTS COMMITTEE

and

Issued and Published Jointly by



AMERICAN COUNCIL OF ENGINEERING COMPANIES

ASSOCIATED GENERAL CONTRACTORS OF AMERICA

AMERICAN SOCIETY OF CIVIL ENGINEERS

PROFESSIONAL ENGINEERS IN PRIVATE PRACTICE
A Practice Division of the
NATIONAL SOCIETY OF PROFESSIONAL ENGINEERS

Endorsed by



CONSTRUCTION SPECIFICATIONS INSTITUTE

EJCDC C-410 Bid Form for Construction Contracts
Copyright © 2007 National Society of Professional Engineers for EJCDC. All rights reserved.

Copyright © 2007 National Society of Professional Engineers
1420 King Street, Alexandria, VA 22314-2794
(703) 684-2882
www.nspe.org

American Council of Engineering Companies
1015 15th Street N.W., Washington, DC 20005
(202) 347-7474
www.acec.org

American Society of Civil Engineers
1801 Alexander Bell Drive, Reston, VA 20191-4400
(800) 548-2723
www.asce.org

Associated General Contractors of America
2300 Wilson Boulevard, Suite 400, Arlington, VA 22201-3308
(703) 548-3118
www.agc.org

The copyright for this EJCDC document is owned jointly by the four
EJCDC sponsoring organizations and held in trust for their benefit by NSPE.

BID FORM

Scottsbluff Downtown Intersection Bulb-Out Construction Project

Scottsbluff, Nebraska

TABLE OF CONTENTS

	Page
Article 1 – Bid Recipient.....	1
Article 2 – Bidder’s Acknowledgements.....	1
Article 3 – Bidder’s Representations	1
Article 4 – Bidder’s Certification.....	2
Article 5 – Basis of Bid	3
Article 6 – Time of Completion	5
Article 7 – Attachments to this Bid.....	5
Article 8 – Defined Terms.....	5
Article 9 – Bid Submittal.....	5

ARTICLE 1 – BID RECIPIENT

1.01 This Bid is submitted to:

City of Scottsbluff
2525 Circle Drive
Scottsbluff, NE 69361

1.02 The undersigned Bidder proposes and agrees, if this Bid is accepted, to enter into an Agreement with Owner in the form included in the Bidding Documents to perform all Work as specified or indicated in the Bidding Documents for the prices and within the times indicated in this Bid and in accordance with the other terms and conditions of the Bidding Documents.

ARTICLE 2 – BIDDER'S ACKNOWLEDGEMENTS

2.01 Bidder accepts all of the terms and conditions of the Instructions to Bidders, including without limitation those dealing with the disposition of Bid security. This Bid will remain subject to acceptance for 60 days after the Bid opening, or for such longer period of time that Bidder may agree to in writing upon request of Owner.

ARTICLE 3 – BIDDER'S REPRESENTATIONS

3.01 In submitting this Bid, Bidder represents that:

A. Bidder has examined and carefully studied the Bidding Documents, other related data identified in the Bidding Documents, and the following Addenda, receipt of which is hereby acknowledged:

<u>Addendum No.</u>	<u>Addendum Date</u>
_____	_____
_____	_____
_____	_____

B. Bidder has visited the Site and become familiar with and is satisfied as to the general, local, and Site conditions that may affect cost, progress, and performance of the Work.

C. Bidder is familiar with and is satisfied as to all Laws and Regulations that may affect cost, progress, and performance of the Work.

D. Bidder has carefully studied all: (1) reports of explorations and tests of subsurface conditions at or contiguous to the Site and all drawings of physical conditions relating to existing surface or subsurface structures at the Site (except Underground Facilities) that have been identified in SC-4.02 as containing reliable "technical data," and (2) reports and drawings of Hazardous Environmental Conditions, if any, at the Site that have been identified in SC-4.06 as containing reliable "technical data."

E. Bidder has considered the information known to Bidder; information commonly known to contractors doing business in the locality of the Site; information and observations obtained

from visits to the Site; the Bidding Documents; and the Site-related reports and drawings identified in the Bidding Documents, with respect to the effect of such information, observations, and documents on (1) the cost, progress, and performance of the Work; (2) the means, methods, techniques, sequences, and procedures of construction to be employed by Bidder, including applying the specific means, methods, techniques, sequences, and procedures of construction expressly required by the Bidding Documents; and (3) Bidder's safety precautions and programs.

- F. Based on the information and observations referred to in Paragraph 3.01.E above, Bidder does not consider that further examinations, investigations, explorations, tests, studies, or data are necessary for the determination of this Bid for performance of the Work at the price(s) bid and within the times required, and in accordance with the other terms and conditions of the Bidding Documents.
- G. Bidder is aware of the general nature of work to be performed by Owner and others at the Site that relates to the Work as indicated in the Bidding Documents.
- H. Bidder has given Engineer written notice of all conflicts, errors, ambiguities, or discrepancies that Bidder has discovered in the Bidding Documents, and the written resolution thereof by Engineer is acceptable to Bidder.
- 1. The Bidding Documents are generally sufficient to indicate and convey understanding of all terms and conditions for the performance of the Work for which this Bid is submitted.

ARTICLE 4 – BIDDER'S CERTIFICATION

4.01 Bidder certifies that:

- A. This Bid is genuine and not made in the interest of or on behalf of any undisclosed individual or entity and is not submitted in conformity with any collusive agreement or rules of any group, association, organization, or corporation;
- B. Bidder has not directly or indirectly induced or solicited any other Bidder to submit a false or sham Bid;
- C. Bidder has not solicited or induced any individual or entity to refrain from bidding; and
- D. Bidder has not engaged in corrupt, fraudulent, collusive, or coercive practices in competing for the Contract. For the purposes of this Paragraph 4.01.D:
 - 1. "corrupt practice" means the offering, giving, receiving, or soliciting of anything of value likely to influence the action of a public official in the bidding process;
 - 2. "fraudulent practice" means an intentional misrepresentation of facts made (a) to influence the bidding process to the detriment of Owner, (b) to establish bid prices at artificial non-competitive levels, or (c) to deprive Owner of the benefits of free and open competition;

3. "collusive practice" means a scheme or arrangement between two or more Bidders, with or without the knowledge of Owner, a purpose of which is to establish bid prices at artificial, non-competitive levels; and
4. "coercive practice" means harming or threatening to harm, directly or indirectly, persons or their property to influence their participation in the bidding process or affect the execution of the Contract.

ARTICLE 5 – BASIS OF BID

Bidder will complete the Work in accordance with the Contract Documents for the following price(s):

Scottsbluff Downtown Intersection Bulb-Out Construction Project

<u>Item</u>	<u>Description</u>	<u>Estimated Quantity</u>	<u>Unit</u>	<u>Unit Price</u>	<u>Total Estimated Price</u>
1	Mobilization	1	LS	\$ _____	\$ _____
2	Traffic Control	1	LS	\$ _____	\$ _____
3	Clear and Grub	1	LS	\$ _____	\$ _____
4	Remove Existing Pavement, Curb, Gutter, Sidewalk, Etc.	50,000	SF	\$ _____	\$ _____
5	Remove Storm Drain Inlet Grate and Frame (Salvage for Reuse)	3	EA	\$ _____	\$ _____
6	Remove Existing Bench (Salvage to Owner)	2	EA	\$ _____	\$ _____
7	8-Inch P.C. Concrete Pavement	1,350	SY	\$ _____	\$ _____
8	30-Inch P.C. Concrete Curb & Gutter	1,925	LF	\$ _____	\$ _____
9	5-Inch P.C. Concrete Sidewalks	25,250	SF	\$ _____	\$ _____
10	Handicap Ramp	400	SF	\$ _____	\$ _____
11	Standard Storm Drain Inlet (Salvage Grate and Frame)	3	EA	\$ _____	\$ _____
12	Install Manhole Ring on Existing Inlet Box	3	EA	\$ _____	\$ _____
13	12-Inch R.C.C.P. Storm Drain	120	LF	\$ _____	\$ _____
14	Tap Existing Structure	3	EA	\$ _____	\$ _____

15	4-Inch Schedule 40 P.V.C. Conduit	1,025	LF	\$ _____	\$ _____
16	Adjust Curb Stop to Grade	14	EA	\$ _____	\$ _____
17	Adjust Valve Box to Grade	12	EA	\$ _____	\$ _____
18	Adjust Roof Drain to Grade	2	EA	\$ _____	\$ _____
19	Adjust Pull Box to Grade	22	EA	\$ _____	\$ _____
20	Adjust Manhole to Grade	6	EA	\$ _____	\$ _____
21	Adjust Inlet Grate to Grade	1	EA	\$ _____	\$ _____
22	4-Inch White Wet Reflective Preformed Pavement Marking, Type 4, Grooved	450	LF	\$ _____	\$ _____
23	4-Inch Yellow Wet Reflective Preformed Pavement Marking, Type 4, Grooved	675	LF	\$ _____	\$ _____
24	6-Inch White Wet Reflective Preformed Pavement Marking, Type 4, Grooved	1,300	LF	\$ _____	\$ _____
25	12-Inch Yellow Wet Reflective Preformed Pavement Marking, Type 4, Grooved	75	LF	\$ _____	\$ _____
26	24-Inch White Preformed Pavement Marking, Type 4, Grooved	120	LF	\$ _____	\$ _____
27	Handicap Symbol Preformed Pavement Marking, Type 4, Grooved	2	EA	\$ _____	\$ _____

TOTAL ITEMS 1-27 \$ _____

PROPOSED STARTING DATE _____

Unit Prices have been computed in accordance with Paragraph 11.03.B of the General Conditions.

Bidder acknowledges that this contract is a lump sum contract for each schedule. No additional payment will be made for extras without an approved change order.

ARTICLE 6 – TIME OF COMPLETION

- 6.01 Bidder agrees that the Work will be substantially complete and will be completed and ready for final payment in accordance with Paragraph 14.07 of the General Conditions on or before the dates or within the number of calendar days indicated in the Agreement.
- 6.02 Bidder accepts the provisions of the Agreement as to liquidated damages.

ARTICLE 7 – ATTACHMENTS TO THIS BID

The following documents are submitted with and made a condition of this bid:

- A. Required Bid security in the form of a Bid Bond (EJCDC No. C-430) or Certified Check (circle type of security provided;
- B. List of Project References;

ARTICLE 8 – DEFINED TERMS

- 8.01 The terms used in this Bid with initial capital letters have the meanings stated in the Instructions to Bidders, the General Conditions, and the Supplementary Conditions.

ARTICLE 9 – BID SUBMITTAL

- 9.01 This Bid is submitted by:

If Bidder is:

An Individual

Name (typed or printed): _____

By: _____
(Individual's signature)

Doing business as: _____

A Partnership

Partnership Name: _____

By: _____
(Signature of general partner -- attach evidence of authority to sign)

Name (typed or printed): _____

A Corporation

Corporation Name: _____ (SEAL)

State of Incorporation: _____

Type (General Business, Professional, Service, Limited Liability): _____

By: _____
(Signature -- attach evidence of authority to sign)

Name (typed or printed): _____

Title: _____
(CORPORATE SEAL)

Attest _____

Date of Qualification to do business in NEBRASKA is ____ / ____ / ____.

A Joint Venture

Name of Joint Venture: _____

First Joint Venturer Name: _____ (SEAL)

By: _____
(Signature of first joint venture partner -- attach evidence of authority to sign)

Name (typed or printed): _____

Title: _____

Second Joint Venturer Name: _____ (SEAL)

By: _____
(Signature of second joint venture partner -- attach evidence of authority to sign)

Name (typed or printed): _____

Title: _____

(Each joint venturer must sign. The manner of signing for each individual, partnership, and corporation that is a party to the joint venture should be in the manner indicated above.)

Bidder's Business Address _____

Phone No. _____ **Fax No.** _____

E-mail _____

SUBMITTED on _____, 20____.

State Contractor License No. _____. *[If applicable]*

SCOTTSBLUFF DOWNTOWN INTERSECTION BUTTB OUT PROJECT CONSTRUCTION PLANS



DRAWING	SHEET	DRAWING
0-1	1	COVER SHEET
LEG-1	2	LEGEND, ABBREVIATIONS, NOTES, & SUMMARY OF QUANTITIES
RMV-1-5	3-7	REMOVAL PLANS
C-1-5	8-12	CONSTRUCTION PLANS
INT-1-5	13-17	INTERSECTION DETAIL PLANS
SWD-1-5	18-22	SIDEWALK DETAIL PLANS
DTL-1-5	23-25	STANDARD DETAILS
300-1-4		CURB RAMP DETAILS



M. C. SCHAFF AND ASSOCIATES, INC.
818 SOUTH BELTLINE HIGHWAY EAST
SCOTTSBLUFF, NEBRASKA 69361

ENGINEERS ♦ PLANNERS ♦ DESIGNERS ♦ LAND SURVEYORS
PH: 308-635-1926 FAX: 308-635-7807 INTERNET: WWW.MCSCHAFF.COM

Page 14 / 24

ENGINEERS • PLANNERS • DESIGNERS • LAND SURVEYORS
 M.C. SCHAFF & ASSOCIATES, INC.
 818 SOUTH BELTLINE HIGHWAY EAST
 SCOTTSBLUFF, NEBRASKA 69361
 PHONE: 308-639-1026 FAX: 308-639-7607 INTERNET: WWW.MCSCHAFF.COM

PROJECT: SCOTTSBLUFF DOWNTOWN
 INTERSECTION BULB OUT
 PROJECT
 SCOTTSBLUFF, NE
 REMOVAL PLANS
 CLIENT: CITY OF SCOTTSBLUFF

PROJECT NUMBER:
 RM140481-00
 PROJECT DATE:
 1/31/2016
 PROJECT MGR:
 D.A.S.
 PROJECT TEAM:
 A.V./D.B.

SEAL

DATE REVISION

SHEET 3 OF 20
 RMV-1

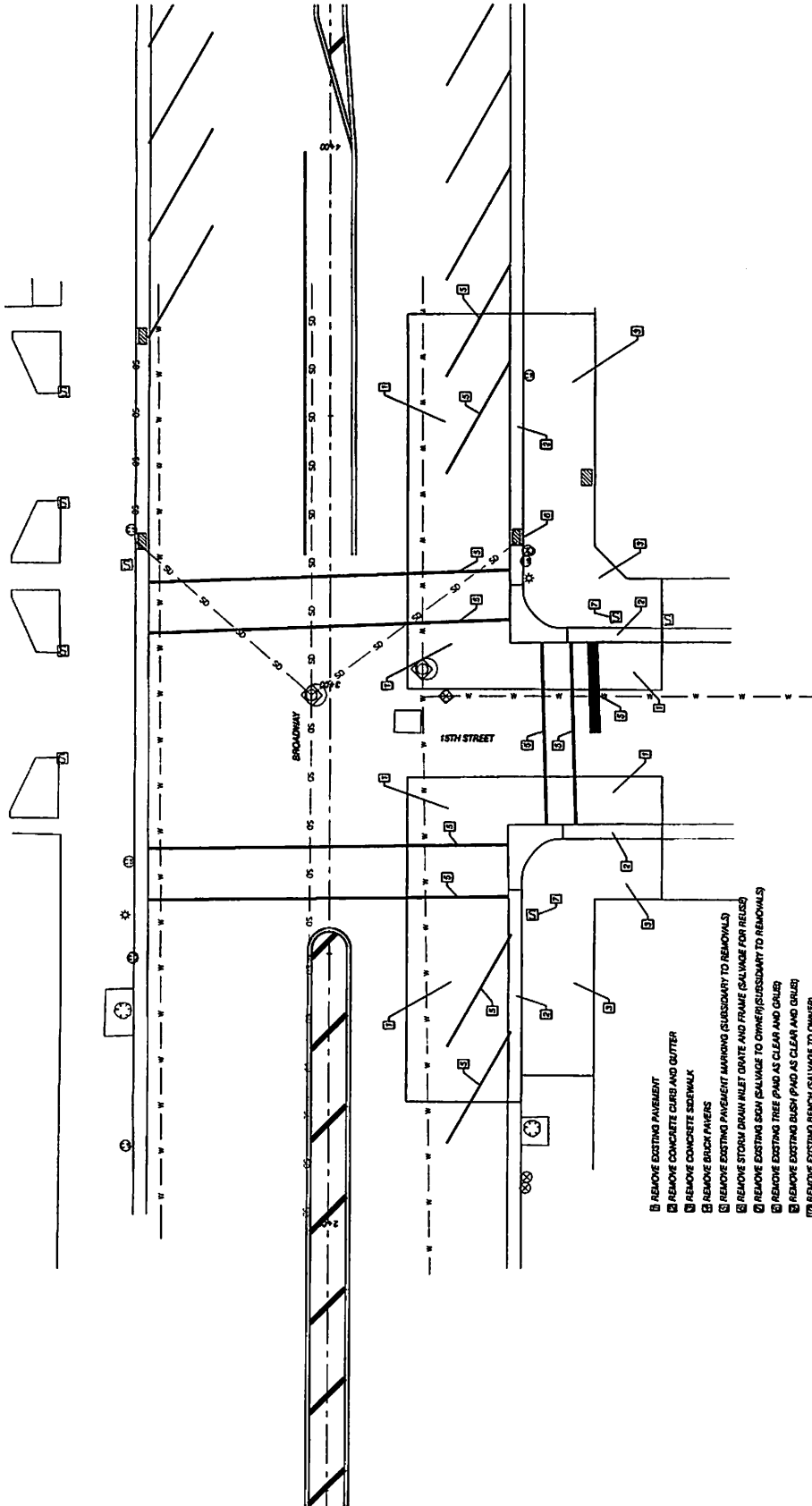

- 1 REMOVE EXISTING PAVEMENT
- 2 REMOVE CONCRETE CURB AND GUTTER
- 3 REMOVE CONCRETE SIDEWALK
- 4 REMOVE BRICK PAVEMENT
- 5 REMOVE EXISTING PAVEMENT MARKING (SUSSEY TO REMOVALS)
- 6 REMOVE STORM DRAIN INLET GRATE AND FRAME (SAVE FOR REUSE)
- 7 REMOVE EXISTING SIGN (SUSSEY TO REMOVALS)
- 8 REMOVE EXISTING TREE (PMD AS CLEAR AND GRUB)
- 9 REMOVE EXISTING BUSH (PMD AS CLEAR AND GRUB)
- 10 REMOVE EXISTING BENCH (SUSSEY TO OWNER)

NOTES:

THE CONTRACTOR SHALL PROVIDE AND KEEP ON THE WORK SITE A CONCRETE SAW WHICH WILL BE USED IN REMOVING EXISTING PAVEMENT, DRIVEWAY, CURB, GUTTER, AND SIDEWALK. TO THE MAXIMUM EXTENT POSSIBLE, REMOVALS OF EXISTING PAVEMENT SHALL BE MADE IN A MANNER THAT WILL BE FULL DEPTH TO PREVENT DAMAGE TO ADJACENT PANELS. THERE SHALL BE NO DIRECT PAYMENT FOR SAW CUTTING IT SHALL BE SUSSEY TO REMOVALS.

EXTREME CARE SHALL BE TAKEN BY THE CONTRACTOR TO PREVENT DAMAGE TO ANY ADJACENT CONCRETE PAVEMENT, EXISTING VEGETATION, AND ALL OTHER OBJECTS THAT ARE TO REMAIN IN PLACE.

Scale in Feet
 0 10 20
 15TH STREET
 REMOVAL PLAN

PH: 308-635-1926 FAX: 308-635-7807 INTERNET: WWW.MCSCHAFF.COM
 ENGINEERS • PLANNERS • DESIGNERS • LAND SURVEYORS
M. C. SCHAFF & ASSOCIATES, INC.
 818 SOUTH BELTLINE HIGHWAY EAST
 SCOTTSBLUFF, NEBRASKA 69361

CLIENT: CITY OF SCOTTSBLUFF
PROJECT: SCOTTSBLUFF DOWNTOWN
 INTERSECTION BULB OUT
 SCOTTSBLUFF, NE
 REMOVAL PLANS

PROJECT NUMBER: RM140481-00
PROJECT DATE: 1/31/2016
PROJECT NGR: D.A.S.
PROJECT TEAM: A.V./D.B.

SEAL

DATE REVISION

SHEET 4 OF 25
RMV-2

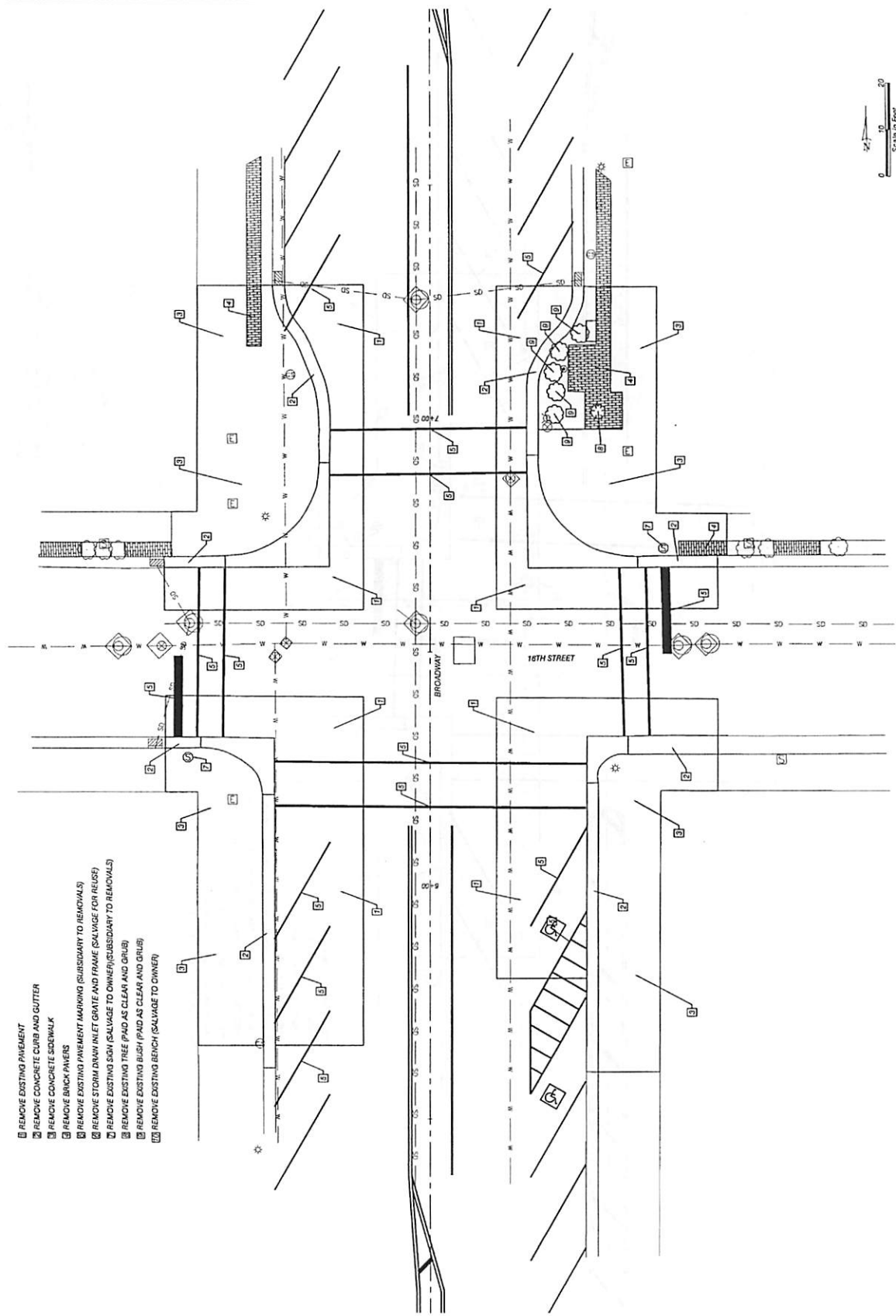

Scale in Feet
 0 10 20
 16TH STREET
 REMOVAL PLAN

- 1 REMOVE EXISTING PAVEMENT
- 2 REMOVE CONCRETE CURB AND GUTTER
- 3 REMOVE CONCRETE SIDEWALK
- 4 REMOVE BRICK PAVERS
- 5 REMOVE EXISTING PAVEMENT MARKING (SUBSIDIARY TO REMOVALS)
- 6 REMOVE STORM DRAIN INLET GRATE AND FRAME (SALVAGE FOR REUSE)
- 7 REMOVE EXISTING SIGN (SALVAGE TO OWNER)(SUBSIDIARY TO REMOVALS)
- 8 REMOVE EXISTING TREE (PAID AS CLEAR AND GRUB)
- 9 REMOVE EXISTING BUSH (PAID AS CLEAR AND GRUB)
- 10 REMOVE EXISTING BENCH (SALVAGE TO OWNER)

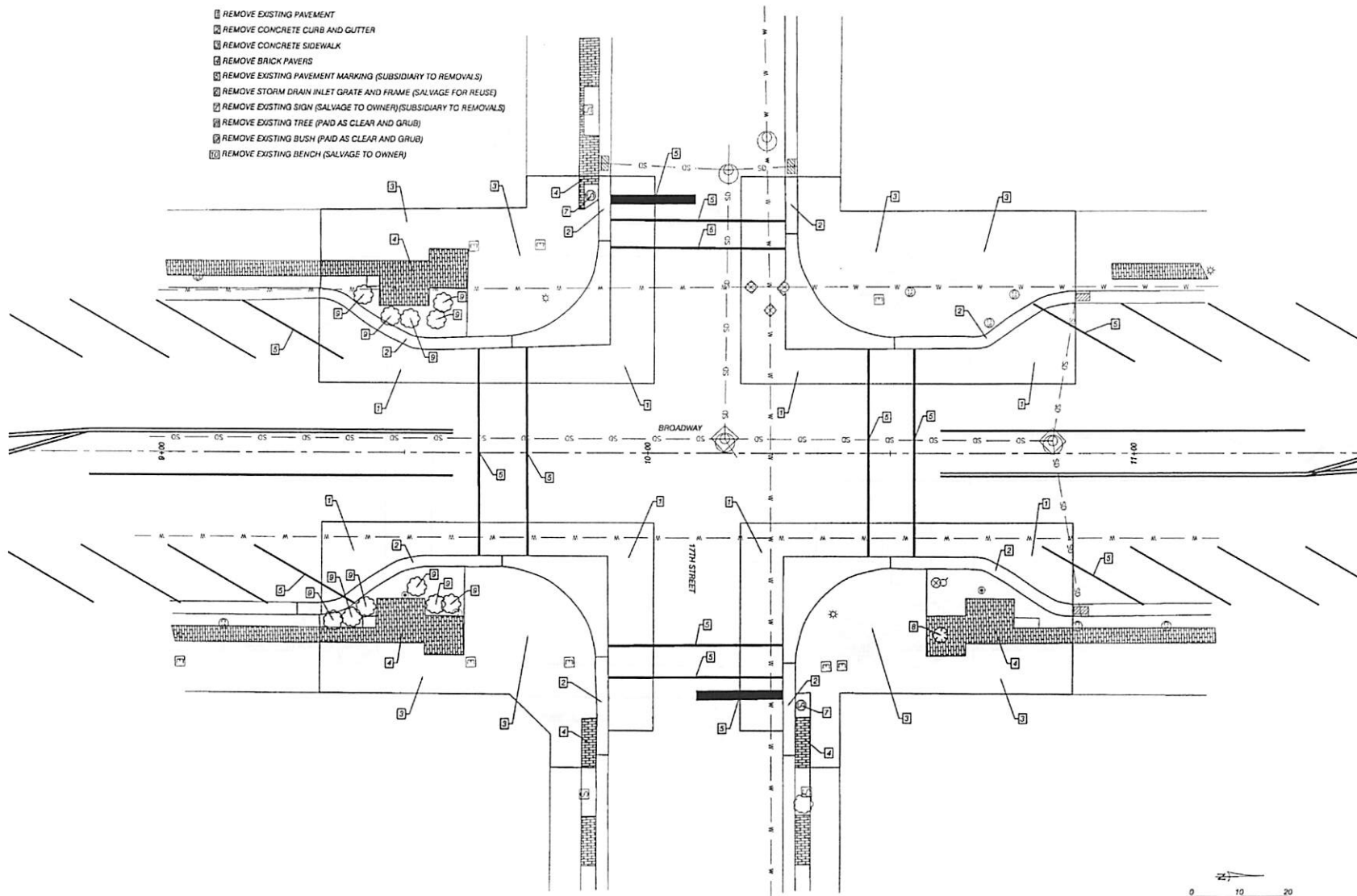

Scale in Feet
0 10 20
17TH STREET
REMOVAL PLAN

M. C. SCHAFF & ASSOCIATES, INC.
818 SOUTH BELTLINE HIGHWAY EAST
SCOTTSDUFF, NEBRASKA 69361



ENGINEERS • PLANNERS • DESIGNERS • LAND SURVEYORS
PH: 308-635-1926 FAX: 308-635-7807 INTERNET: WWW.MCSCHAFF.COM

PROJECT: SCOTTSDUFF DOWNTOWN
INTERSECTION BUILDS OUT
PROJECT
SCOTTSDUFF, NE
REMOVAL PLANS

CLIENT: CITY OF SCOTTSDUFF

PROJECT NUMBER:
RM140481-00
PROJECT DATE:
1/31/2016
PROJECT MGR:
D.A.S.
PROJECT TEAM:
A.V./D.B.



DATE	REVISION

SHEET 5 OF 25
RMV-3

RMV-4
SHEET 6 OF 25

DATE	REVISION

SCALE

PROJECT NUMBER: RM 140481-00
PROJECT DATE: 1/31/2016
PROJECT MGR: D.A.S.
PROJECT TEAM: A.V./D.B.

CLIENT: CITY OF SCOTTSBLUFF
PROJECT: SCOTTSBLUFF DOWNTOWN INTERSECTION BULB OUT PROJECT
SCOTTSBLUFF, NE
REMOVAL PLANS

M.C. SCHAFF & ASSOCIATES, INC.
818 SOUTH BELTLINE HIGHWAY EAST
SCOTTSBLUFF, NEBRASKA 69361
ENGINEERS • PLANNERS • DESIGNERS • LAND SURVEYORS
PH: 308-635-1926 FAX: 308-635-7807 INTERNET: WWW.MCSCHAFF.COM

18TH STREET
REMOVAL PLAN
Scale in Feet
0 10 20

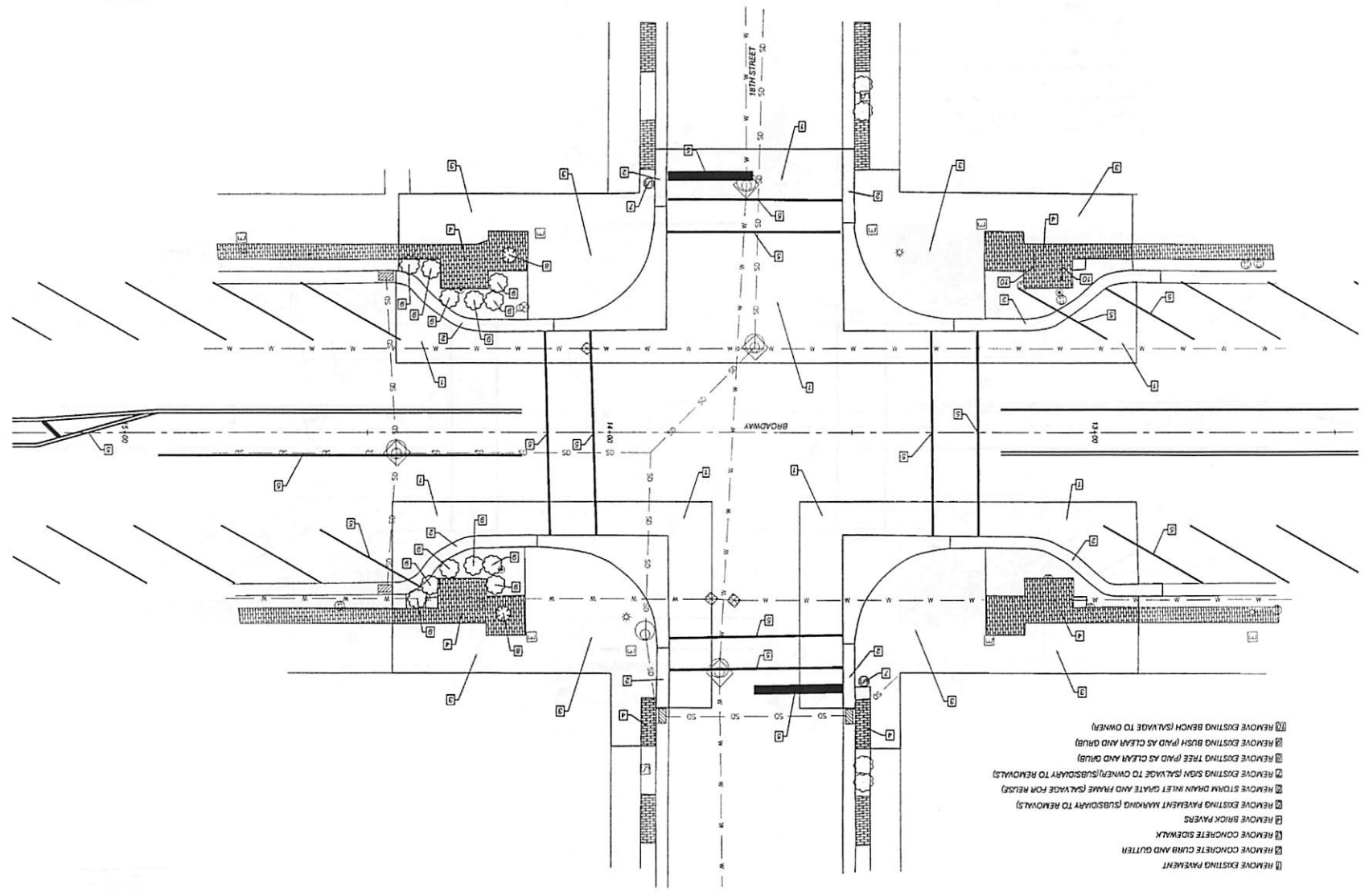

- 1 REMOVE EXISTING PAVEMENT
- 2 REMOVE CONCRETE CURB AND GUTTER
- 3 REMOVE CONCRETE SIDEWALK
- 4 REMOVE BRICK PAVEMENT
- 5 REMOVE EXISTING PAVEMENT MARKING (SUBSIDIARY TO REMOVALS)
- 6 REMOVE STORM DRAIN INLET GRATE AND FRAME (SALVAGE FOR REUSE)
- 7 REMOVE EXISTING SIGN (SALVAGE TO OWNER/SUBSIDIARY TO REMOVALS)
- 8 REMOVE EXISTING TREE (PAID AS CLEAN AND GRUB)
- 9 REMOVE EXISTING BUSH (PAID AS CLEAN AND GRUB)
- 10 REMOVE EXISTING BENCH (SALVAGE TO OWNER)

RMV-5
SHEET 7 OF 25

DATE	REVISION

SEAL

PROJECT NUMBER: RM140481-00
PROJECT DATE: 1/31/2016
PROJECT MGR: D.A.S.
PROJECT TEAM: A.V./D.B.

PROJECT: SCOTTSBLUFF DOWNTOWN
INTERSECTION BULB OUT
PROJECT: SCOTTSBLUFF, NE
REMOVAL PLANS
CLIENT: CITY OF SCOTTSBLUFF

M.C. SCHAFF & ASSOCIATES, INC.
818 SOUTH BELTLINE HIGHWAY EAST
SCOTTSBLUFF, NEBRASKA 69361
ENGINEERS • PLANNERS • DESIGNERS • LAND SURVEYORS
PH: 308-635-1926 FAX: 308-635-7807 INTERNET: WWW.MCSCHAFF.COM

Scale in Feet
0 10 20
19TH STREET
REMOVAL PLAN

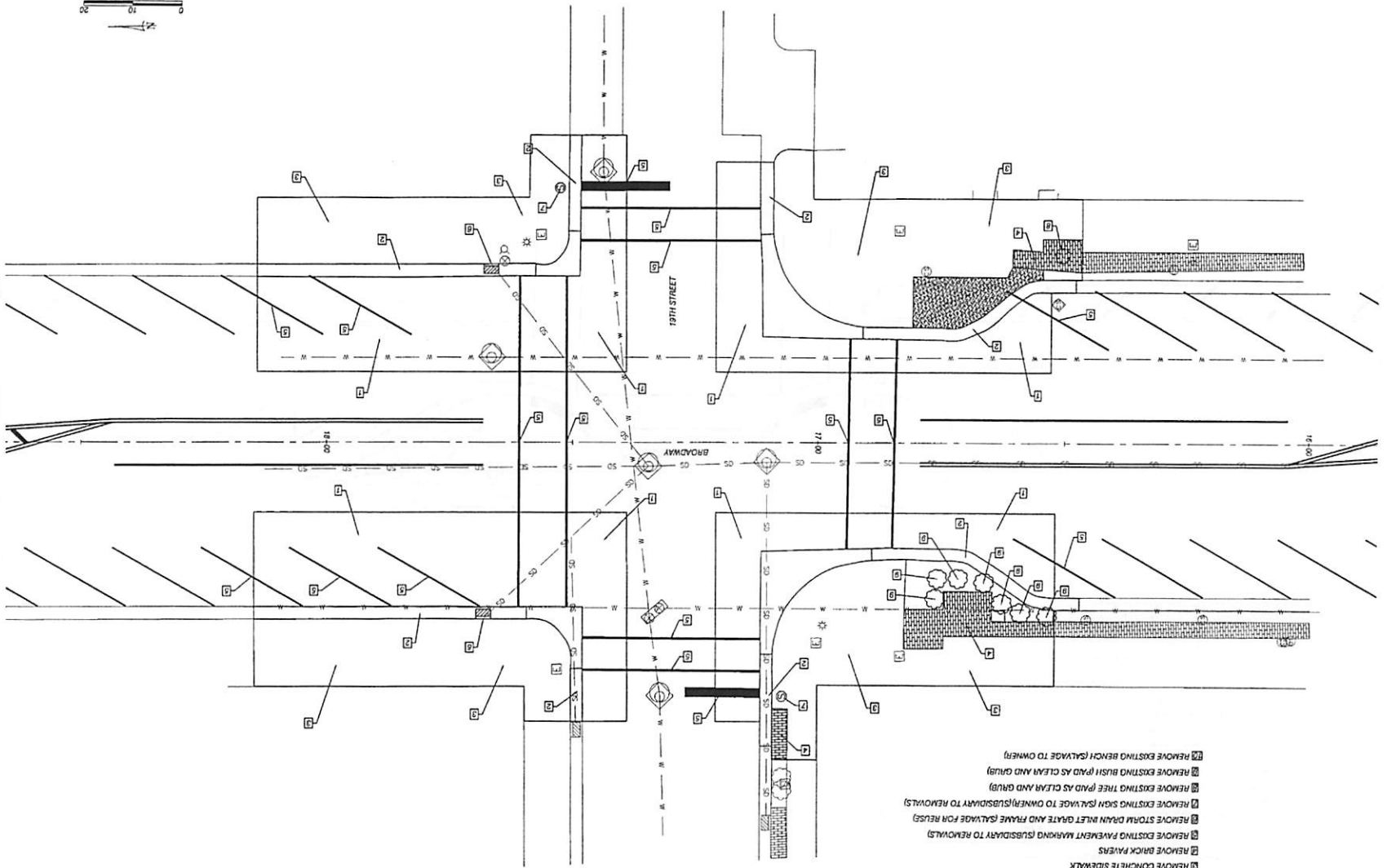

- 1 REMOVE EXISTING PAVEMENT
- 2 REMOVE CONCRETE CURB AND GUTTER
- 3 REMOVE CONCRET SIDEWALK
- 4 REMOVE BRICK PAVERS
- 5 REMOVE EXISTING PAVEMENT MARKING (SUBSIDIARY TO REMOVALS)
- 6 REMOVE STOP DRINK INLET GRATE AND FRAME (SALVAGE FOR REUSE)
- 7 REMOVE EXISTING SIGN (SALVAGE TO OWNER/SUBSIDIARY TO REMOVALS)
- 8 REMOVE EXISTING TREE (PAID AS CLEAR AND GRUB)
- 9 REMOVE EXISTING BUSH (PAID AS CLEAR AND GRUB)
- 10 REMOVE EXISTING BENCH (SALVAGE TO OWNER)

M. C. SCHAFF & ASSOCIATES, INC.
818 SOUTH BELTLINE HIGHWAY EAST
SCOTTSBLUFF, NEBRASKA 69361
ENGINEERS • PLANNERS • DESIGNERS • LAND SURVEYORS
PH: 308-635-1026 FAX: 308-635-7607 INTERNET: WWW.MCSCHAFF.COM

PROJECT: SCOTTSBLUFF DOWNTOWN
INTERSECTION BULB OUT
SCOTTSBLUFF, NE
CONSTRUCTION PLANS
CLIENT: CITY OF SCOTTSBLUFF

PROJECT NUMBER:
R1140481-00
PROJECT DATE:
1/31/2016
PROJECT MGR:
D. SCHAFER
PROJECT TEAM:
A.V./D.B.

SEAL

DATE
REVISION

SHEET 6 OF 25
C-1

0 10 20
Scale in Feet
CONSTRUCTION PLANS

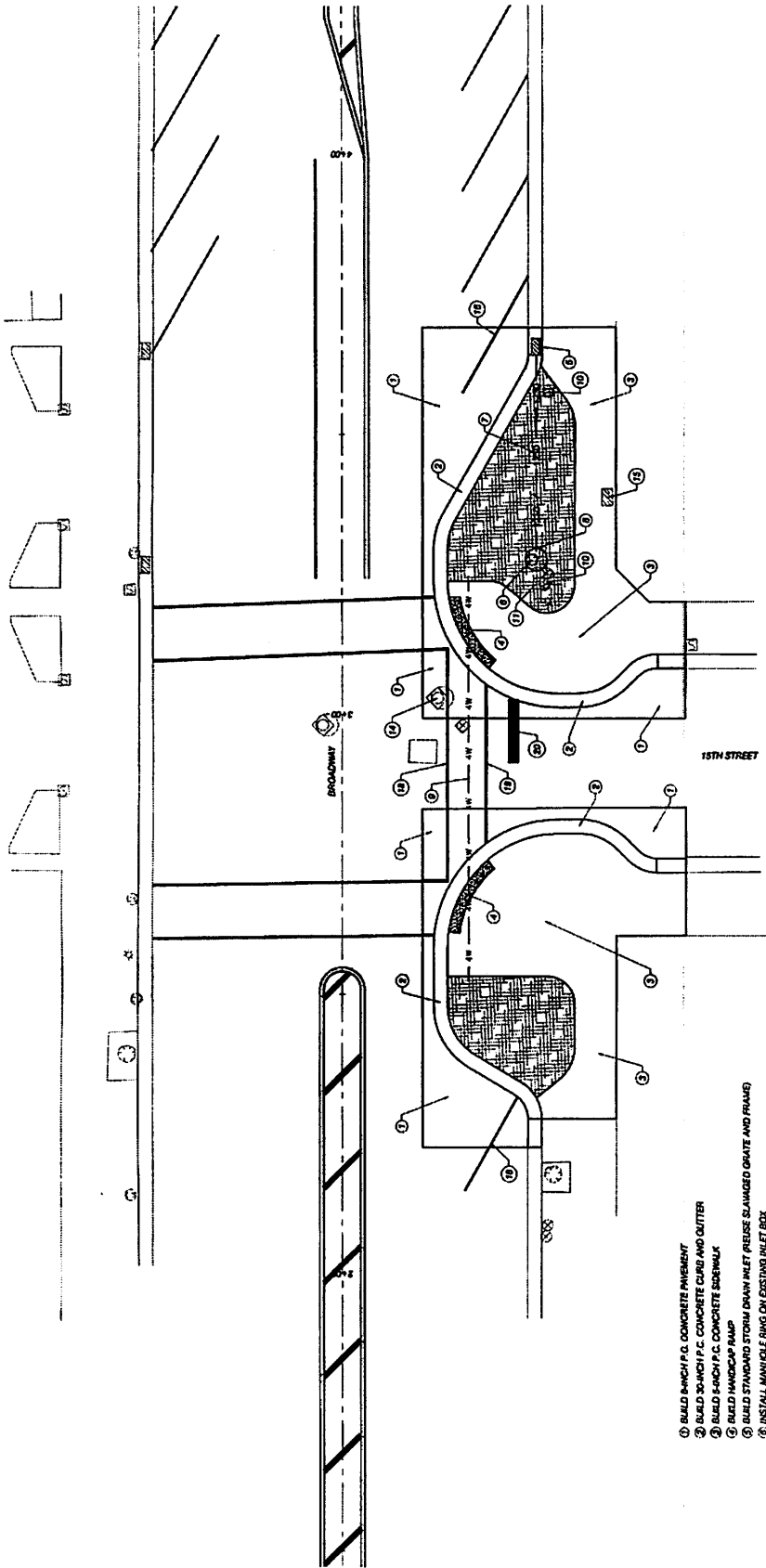

1. BUILD 8-INCH P.C. CONCRETE PAVEMENT
2. BUILD 30-INCH P.C. CONCRETE CURB AND GUTTER
3. BUILD 8-INCH P.C. CONCRETE SIDEWALK
4. BUILD HANDICAP RAMP
5. BUILD STANDARD STORM DRAIN INLET (FLEXIBLE SLANTED GRATE AND FRAME)
6. INSTALL MANHOLE RING ON EXISTING INLET BOX
7. INSTALL 18-INCH R.C.C.P. STORM DRAIN PIPE
8. TAP EXISTING STRUCTURE
9. INSTALL 4-INCH SCHEDULE 40 PVC CONDUIT AT 18-INCH DEPTH
10. ADJUST CURB STOP TO GRADE
11. ADJUST VALVE BOX TO GRADE
12. ADJUST HOOD DRAIN TO GRADE
13. ADJUST PULL BOX TO GRADE
14. ADJUST MANHOLE TO GRADE
15. ADJUST INLET GRATE TO GRADE
16. INSTALL 4-INCH SOLID WHITE NET REFLECTIVE PREFORMED PAVEMENT MARKING, TYPE 4, GROOVED
17. INSTALL DOUBLE 4-INCH SOLID YELLOW NET REFLECTIVE PREFORMED PAVEMENT MARKING, TYPE 4, GROOVED
18. INSTALL 8-INCH SOLID WHITE NET REFLECTIVE PREFORMED PAVEMENT MARKING, TYPE 4, GROOVED
19. INSTALL 12-INCH SOLID YELLOW PREFORMED PAVEMENT MARKING, TYPE 4, GROOVED
20. INSTALL 24-INCH SOLID WHITE PREFORMED PAVEMENT MARKING, TYPE 4, GROOVED
21. INSTALL HANDICAP SYMBOL PREFORMED PAVEMENT MARKING, TYPE 4, GROOVED

ENGINEERS • PLANNERS • DESIGNERS • LAND SURVEYORS
 PH: 308-635-1826 FAX: 308-635-7807 INTERNET: WWW.MCSCHAF.COM
M. C. SCHAF & ASSOCIATES, INC.
818 SOUTH BELTLINE HIGHWAY EAST
SCOTTSBLUFF, NEBRASKA 69361



PROJECT: SCOTTSBLUFF DOWNTOWN
INTERSECTION BULB OUT
SCOTTSBLUFF, NE
CONSTRUCTION PLANS
CLIENT: CITY OF SCOTTSBLUFF

PROJECT NUMBER:
 RM14048100
PROJECT DATE:
 1/31/2016
PROJECT NGR:
 D.A.S.
PROJECT TEAM:
 A.V./D.B.

SEAL

DATE	REVISION

SHEET 9 OF 23
C-2

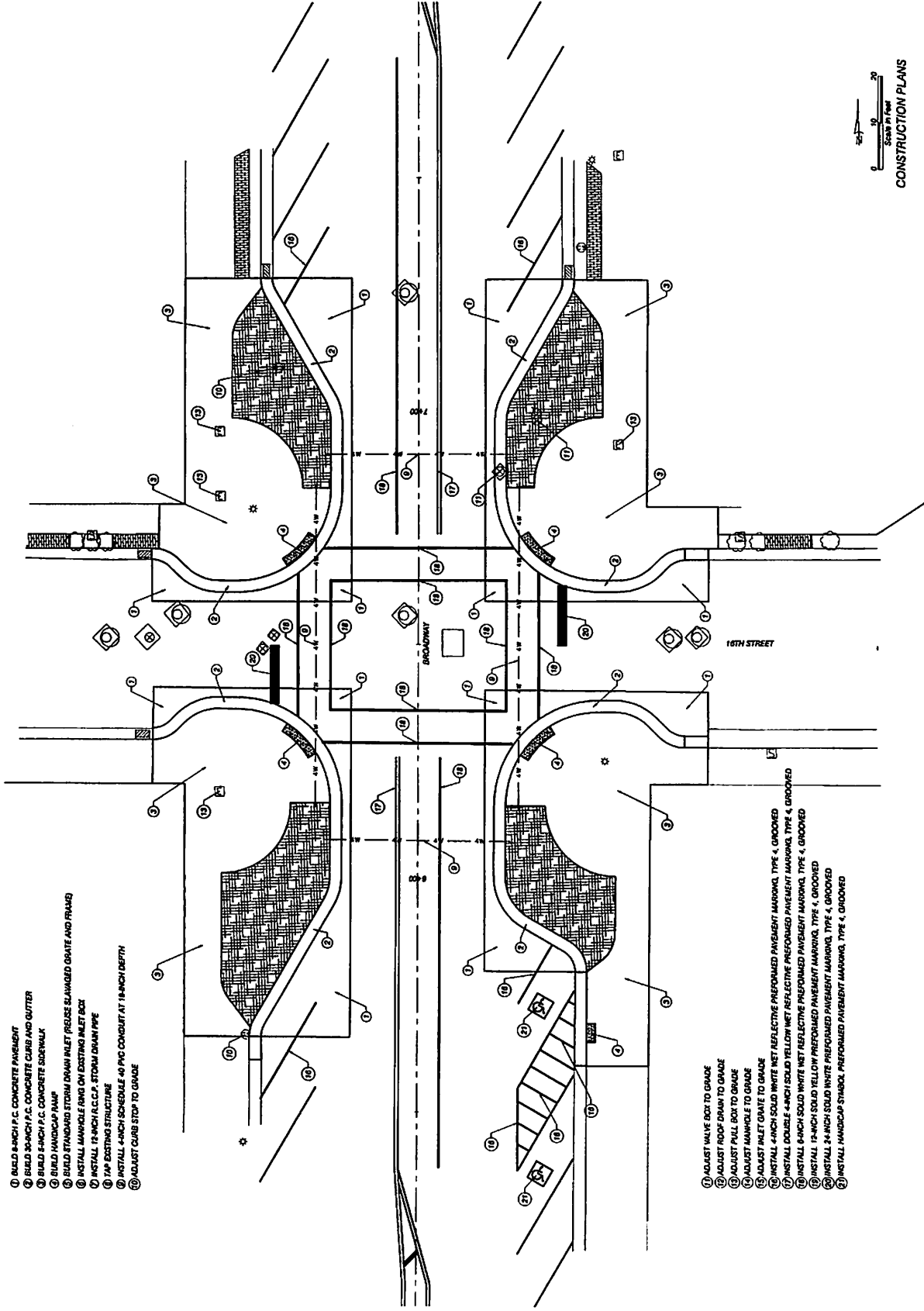

- ① BUILD 8-INCH P.C. CONCRETE PAVEMENT
- ② BUILD 30-INCH P.C. CONCRETE CURB AND OUTER
- ③ BUILD 4-INCH P.C. CONCRETE SIDEWALK
- ④ BUILD HANDCAP RAMP
- ⑤ BUILD STANDARD STORM DRAIN INLET PREPARE BLANKETED GRATE AND FRAME
- ⑥ INSTALL 18-INCH R.C.C.P. STORM DRAIN PIPE
- ⑦ 1/4" EXISTING STRUCTURE
- ⑧ INSTALL 4-INCH SCHEDULE 40 PVC CONDUIT AT 18-INCH DEPTH
- ⑨ ADJUST CURB STOP TO GRADE

- ⑩ ADJUST VALVE BOX TO GRADE
- ⑪ ADJUST HOOD DRAIN TO GRADE
- ⑫ ADJUST FALL BOX TO GRADE
- ⑬ ADJUST MANHOLE TO GRADE
- ⑭ INSTALL 4-INCH SOLID WHITE NET REFLECTIVE PREFORMED PAVEMENT MARKING, TYPE 4, GROOVED
- ⑮ INSTALL DOUBLE 4-INCH SOLID YELLOW NET REFLECTIVE PREFORMED PAVEMENT MARKING, TYPE 4, GROOVED
- ⑯ INSTALL 8-INCH SOLID WHITE NET REFLECTIVE PREFORMED PAVEMENT MARKING, TYPE 4, GROOVED
- ⑰ INSTALL 12-INCH SOLID YELLOW PREFORMED PAVEMENT MARKING, TYPE 4, GROOVED
- ⑱ INSTALL 24-INCH SOLID WHITE PREFORMED PAVEMENT MARKING, TYPE 4, GROOVED
- ⑲ INSTALL HANDCAP SYMBOL, PREFORMED PAVEMENT MARKING, TYPE 4, GROOVED

M. C. SCHAF & ASSOCIATES, INC.
818 SOUTH BELTLINE HIGHWAY EAST
SCOTTSBLUFF, NEBRASKA 69361
ENGINEERS • PLANNERS • DESIGNERS • LAND SURVEYORS
PH: 308-635-1026 FAX: 308-635-7807 INTERNET: WWW.MCSCHAF.COM

PROJECT: SCOTTSBLUFF DOWNTOWN
INTERSECTION BUILD OUT
SCOTTSBLUFF, NE
CONSTRUCTION PLANS
CLIENT: CITY OF SCOTTSBLUFF

PROJECT NUMBER:
RM146451400
PROJECT DATE:
1/31/2016
PROJECT MORE:
D.A.B.
PROJECT TEAM:
A.V./D.B.

SEAL

DATE
REVISION

SHEET 10 OF 28
C-3

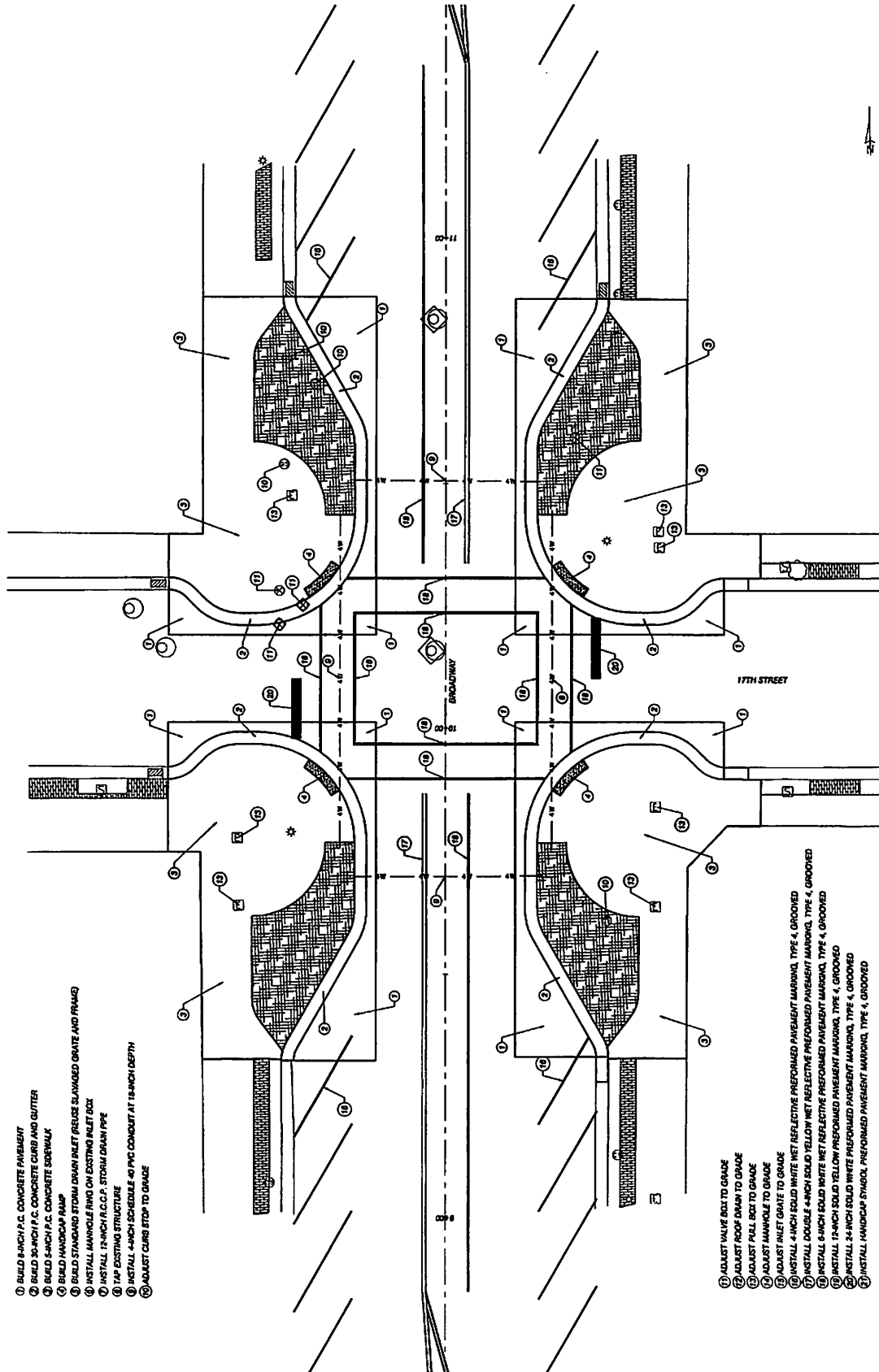

CONSTRUCTION PLANS
Scale in Feet
0 10 20

M. C. SCHAFF & ASSOCIATES, INC.
818 SOUTH BELTLINE HIGHWAY EAST
SCOTTSBLUFF, NEBRASKA 69361
ENGINEERS • PLANNERS • DESIGNERS • LAND SURVEYORS
PH: 308-639-1926 FAX: 308-639-7807 INTERNET: WWW.MCSCHAFF.COM



PROJECT: SCOTTSBLUFF DOWNTOWN
INTERSECTION BULB OUT
SCOTTSBLUFF, NE
CONSTRUCTION PLANS
CLIENT: CITY OF SCOTTSBLUFF

PROJECT NUMBER:
81140481-00
PROJECT DATE:
1/31/2016
PROJECT NGR:
D.A.S.
PROJECT TEAM:
A.V./D.B.

SEAL

DATE: _____
REVISION: _____

SHEET 11 OF 25
C-4

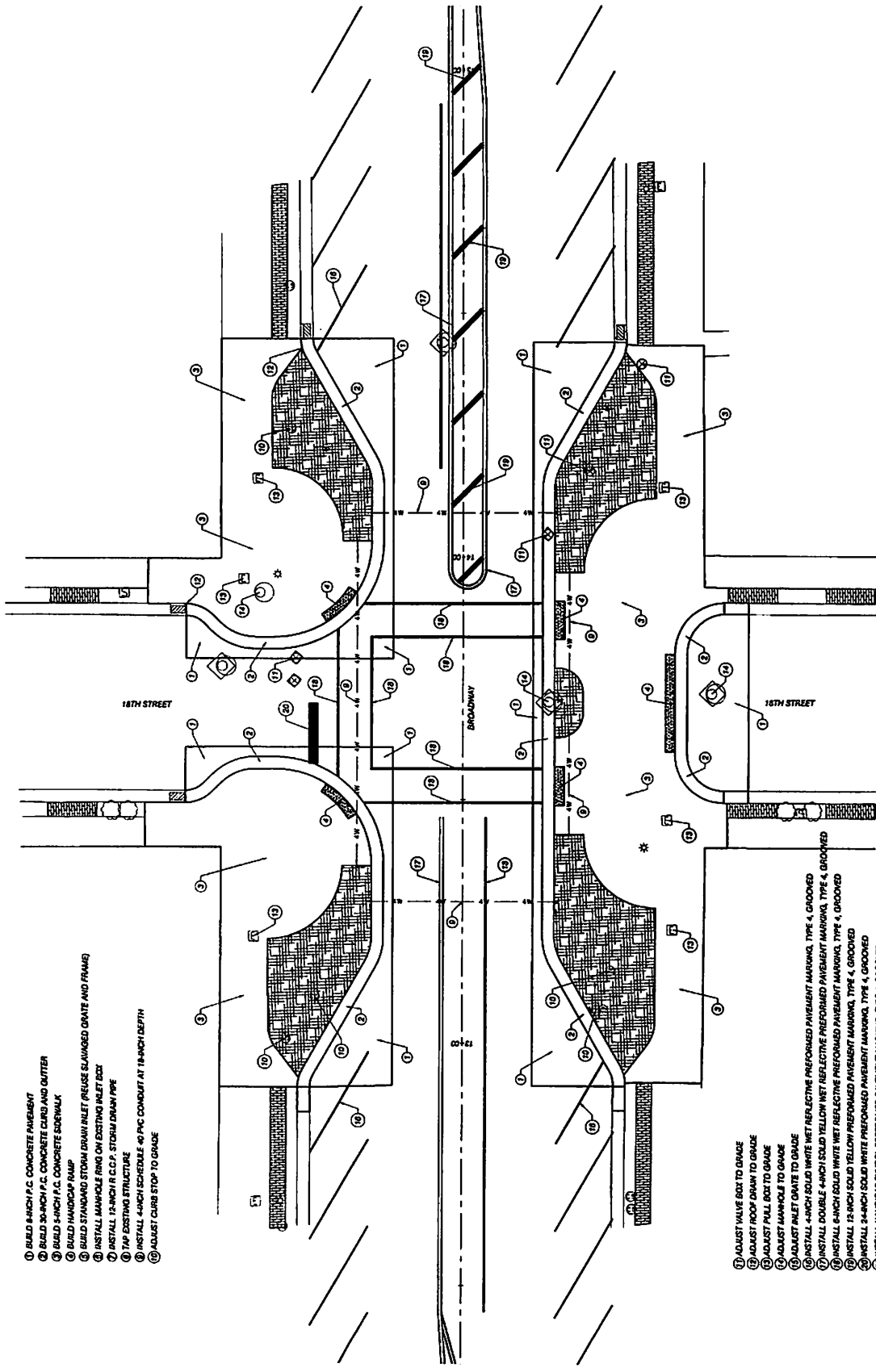

- 1) BUILD 8-INCH P.C. CONCRETE PAVEMENT
- 2) BUILD 8-INCH P.C. CONCRETE CURB AND GUTTER
- 3) BUILD 8-INCH P.C. CONCRETE SIDEWALK
- 4) BUILD MANHOLE RAMP
- 5) BUILD STANDARD STORM DRAIN INLET (REUSE SALVAGED GRATE AND FRAME)
- 6) INSTALL MANHOLE RING ON EXISTING INLET BOX
- 7) INSTALL 12-INCH R.C.C.P. STORM DRAIN PIPE
- 8) TAP EXISTING STRUCTURE
- 9) INSTALL 4-INCH SCHEDULE 40 PVC CONDUIT AT 18-INCH DEPTH
- 10) ADJUST CURB STOP TO GRADE

- 11) ADJUST VALVE BOX TO GRADE
- 12) ADJUST ROOF DRAIN TO GRADE
- 13) ADJUST FULL BOX TO GRADE
- 14) ADJUST MANHOLE TO GRADE
- 15) ADJUST INLET GRATE TO GRADE
- 16) INSTALL 4-INCH SOLID WHITE WET REFLECTIVE PREFORMED PAVEMENT MARKING, TYPE 4, GROOVED
- 17) INSTALL DOUBLE 4-INCH SOLID YELLOW WET REFLECTIVE PREFORMED PAVEMENT MARKING, TYPE 4, GROOVED
- 18) INSTALL 4-INCH SOLID WHITE WET REFLECTIVE PREFORMED PAVEMENT MARKING, TYPE 4, GROOVED
- 19) INSTALL 12-INCH SOLID YELLOW PREFORMED PAVEMENT MARKING, TYPE 4, GROOVED
- 20) INSTALL 24-INCH SOLID WHITE PREFORMED PAVEMENT MARKING, TYPE 4, GROOVED
- 21) INSTALL MANHOLE STUDS, PREFORMED PAVEMENT MARKING, TYPE 4, GROOVED

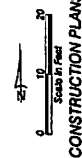

CONSTRUCTION PLANS

M. C. SCHAFF & ASSOCIATES, INC.
818 SOUTH BELTLINE HIGHWAY EAST
SCOTTSBLUFF, NEBRASKA 69361
ENGINEERS • PLANNERS • DESIGNERS • LAND SURVEYORS
PH: 308-635-1926 FAX: 308-635-7807 INTERNET: WWW.MCSCHAFF.COM



PROJECT: SCOTTSBLUFF DOWNTOWN
INTERSECTION BULB OUT
SCOTTSBLUFF, NE
CONSTRUCTION PLANS
CLIENT: CITY OF SCOTTSBLUFF

PROJECT NUMBER:
RM140481-00
PROJECT DATE:
1/31/2018
PROJECT MGR:
JANIS
PROJECT TEAM:
A.V./D.B.

SEAL
DATE
REVISION

DATE
REVISION

SHEET 12 OF 25
C-5

Scale in Feet
0 10 20
19TH STREET
CONSTRUCTION PLANS

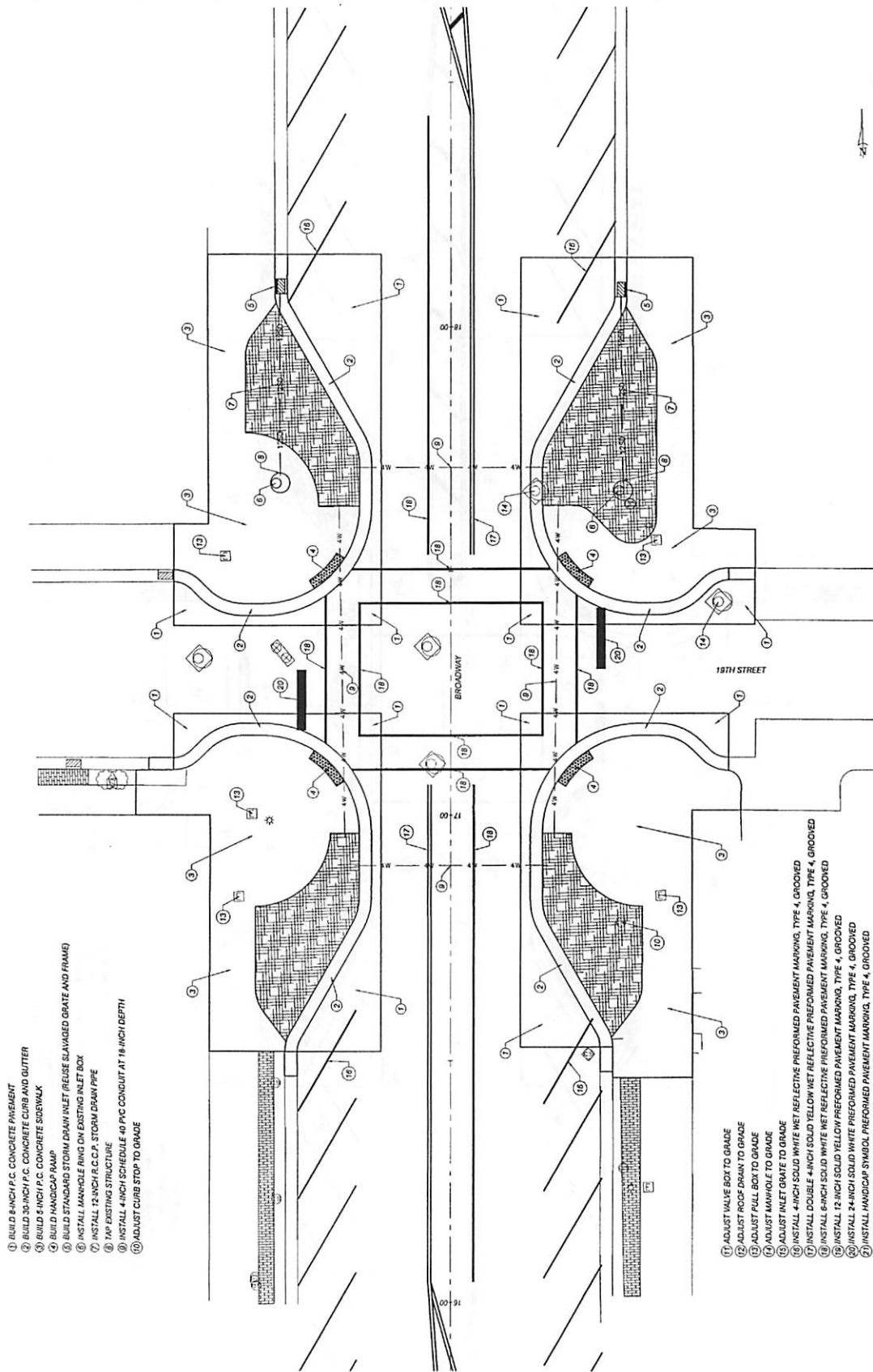

- (1) BUILD 8-INCH P.C. CONCRETE PAVEMENT
- (2) BUILD 30-INCH P.C. CONCRETE CURB AND GUTTER
- (3) BUILD 5-INCH P.C. CONCRETE SIDEWALK
- (4) BUILD HANDICAP WALK
- (5) BUILD STANDARD STORM DRAIN INLET (REUSE SLAUGHTER GRATE AND FRAME)
- (6) INSTALL MANHOLE RING ON EXISTING INLET BOX
- (7) INSTALL 12-INCH R.C.P. STORM DRAIN PIPE
- (8) TAP EXISTING STRUCTURE
- (9) INSTALL 4-INCH SCHEDULE 40 P.C. CONDUIT AT 18-INCH DEPTH
- (10) ADJUST CURB STOP TO GRADE

- (11) ADJUST VALVE BOX TO GRADE
- (12) ADJUST ROOF DRAIN TO GRADE
- (13) ADJUST PULL BOX TO GRADE
- (14) ADJUST MANHOLE TO GRADE
- (15) ADJUST INLET GRATE TO GRADE
- (16) INSTALL 4-INCH SOLID WHITE NET REFLECTIVE PREFORMED PAVEMENT MARKING, TYPE 4, GROOVED
- (17) INSTALL DOUBLE 4-INCH SOLID YELLOW NET REFLECTIVE PREFORMED PAVEMENT MARKING, TYPE 4, GROOVED
- (18) INSTALL 8-INCH SOLID WHITE NET REFLECTIVE PREFORMED PAVEMENT MARKING, TYPE 4, GROOVED
- (19) INSTALL 12-INCH SOLID YELLOW PREFORMED PAVEMENT MARKING, TYPE 4, GROOVED
- (20) INSTALL 24-INCH SOLID WHITE PREFORMED PAVEMENT MARKING, TYPE 4, GROOVED
- (21) INSTALL HANDICAP SYMBOL, PREFORMED PAVEMENT MARKING, TYPE 4, GROOVED