

# **City of Scottsbluff, Nebraska**

**Monday, November 2, 2015**

**Regular Meeting**

## **Item Public Inp1**

**Council to consider approval of the change of location for RMH Franchise Corporation/Applebee's Neighborhood Grill & Bar for a change of location for the existing liquor license from 2621 5th Ave. to 2302 Frontage Road.**

Staff Contact: Cindy Dickinson, City Clerk



**Pete Ricketts**  
Governor

**STATE OF NEBRASKA**  
**NEBRASKA LIQUOR CONTROL COMMISSION**  
**Hobert B. Rupe**  
Executive Director

301 Centennial Mall South, 5th Floor  
P.O. Box 95046  
Lincoln, Nebraska 68509-5046  
Phone (402) 471-2571  
Fax (402) 471-2814 or (402) 471-2374  
TRS USER 800 833-7352 (TTY)  
web address: <http://www.lcc.ne.gov/>

October 19, 2015

SCOTTSBLUFF CITY CLERK  
2525 CIRCLE DRIVE  
SCOTTSBLUFF NE 69361

Dear Clerk;

Please present this request to your board and send us the results of that action.

**RE: CHANGE OF LOCATION**

**LICENSE #:** I-101602  
**LICENSEE::** RMH FRANCHISE CORPORATION /  
**TRADE NAME:** APPLEBEE'S NEIGHBORHOOD GRILL & BAR  
**CURRENT ADDRESS:** 2621-5<sup>TH</sup> AVE  
**CITY/COUNTY:** SCOTTSBLUFF/ SCOTTS BLUFF  
**PHONE:** 308-635-7750  
**NEW ADDRESS:** 2302 FRONTAGE ROAD  
**NEW DESCRIPTION:** SINGLE STORY BLDG APPROX 86'X 57'

**APPROVED:\_\_\_\_\_DENIED\_\_\_\_\_NO RECOMMENDATION\_\_\_\_\_**

Sincerely,  
Randy Seybert  
Licensing Division  
NEBRASKA LIQUOR CONTROL COMMISSION  
RS

cc: file

**Janice M. Wiebusch**  
Commissioner

**Robert Batt**  
Chairman

**Bruce Bailey**  
Commissioner

*An Equal Opportunity Employer*

**APPLICATION FOR CHANGE OF  
LOCATION TO LIQUOR LICENSE**

NEBRASKA LIQUOR CONTROL COMMISSION  
301 CENTENNIAL MALL SOUTH  
PO BOX 95046  
LINCOLN, NE 68509-5046  
PHONE: (402) 471-2571  
FAX: (402) 471-2814  
Website: [www.lcc.nebraska.gov](http://www.lcc.nebraska.gov)

Office Use

**RECEIVED**

OCT 7 2015

**NEBRASKA LIQUOR  
CONTROL COMMISSION**

**Application:**

- Must include processing fee of \$45.00 checks made payable to Nebraska Liquor Control Commission (NLCC) or you may pay online at [www.ne.gov/go/NLCCpayport](http://www.ne.gov/go/NLCCpayport)
- Must include a copy of the lease, deed or purchase agreement showing ownership of new location. This document must read in the name liquor license is issued to, i.e. if license is issued to a corporation must read corporate name
- Must include simple hand drawn sketch of new location, must include outside dimensions in feet (not square feet), showing direction north  
NO BLUE PRINTS
- May include approval from the local governing body; new location shall not be approved unless endorsed by the local governing body
- Check with your local governing body for any additional requirements that may be necessary in making this request for addition
- Change of location application will not be accepted if moving to a different jurisdiction (i.e. city or county); a new application will need to be filed.

LIQUOR LICENSE # 101602 CLASS TYPE 1 Alcoholic Liquor On Sale  
LICENSEE NAME RMH Franchise Corporation  
TRADE NAME Applebee's Neighborhood Grill & Bar  
CURRENTLY LICENSED ADDRESS 2621 5th Avenue  
CITY Scottsbluff ZIP CODE 69361 COUNTY Scotts Bluff  
CONTACT PERSON Antonio Carranza  
PHONE NUMBER OF CONTACT PERSON 402-858-8325  
EMAIL ADDRESS OF CONTACT PERSON acarranza@rmhfranchise.com



1500023058

FORM 111  
REV APR 2015  
Page 1 of 3

**NEW PREMISE**

Street Address #1 2302 Frontage Road ("Monuments Mall")  
Street Address #2 Scottsbluff, Nebraska  
Zip Code 69361 New Premise Phone Number (308) 635-7750  
Business e-mail address ab06@rmhfranchise.com

**RECEIVED**

**MAILING ADDRESS FOR NEW LOCATION**

Street Address #1 RMH Franchise Corporation  
Street Address #2 P.O. Box 21960  
City Lincoln State NE Zip Code 68542-1960

OCT 7 2015

**NEBRASKA LIQUOR  
CONTROL COMMISSION**

1. Describe the new building to be licensed
  - ✓ Include sketch of building to be licensed with length & width in feet
  - ✓ If outdoor area to be licensed include on sketch with length & width
  - ✓ Indicate the direction north
  - ✓ Indicate single story building or give number of floors, how many are licensed
  - ✓ Indicate if there is a basement to be included in the licensed description
2. Include proof of ownership (must be in the name liquor license is issued under)
  - ✓ deed
  - ✓ purchase agreement 11/19/2035
  - ✓ lease; date lease expires \_\_\_\_\_
3. Is the new premise location within 150 feet of a church, school, hospital, home for the aged or indigent persons or for veterans, their wives, and children; or within 300 feet of a college or university campus?  
☐ YES ☒ NO

If yes, provide name and address of such institution and where it is located in relation to the premises (Neb. Rev. Stat. 53-177)(1).

Must include supplemental Form 134 found at this link: <http://www.lcc.ne.gov/formsdiv.html>

If proposed location is within 300 feet of a campus, the Commission may waive this restriction upon written approval from the governing body of the college or university. (Rev. Stat. 53-177)(1).

Must include supplemental Form 135 found at this link: <http://www.lcc.ne.gov/formsdiv.html>

4. When do you expect on moving into the new location? November 19, 2015

FORM 111  
REV APR 2015  
Page 2 of 3

I acknowledge under oath that the premises into which such move is made comply in all respects with the requirements of the act. Neb Rev Stat §53-129

**RECEIVED**

OCT 7 2015

**NEBRASKA LIQUOR  
CONTROL COMMISSION**

Margaret Schiefen  
Signature of Licensee or Officer

State of Nebraska

County of Lancaster

The foregoing instrument was acknowledged before me this

October 7, 2015  
Date

by Margaret Schiefen  
name of person acknowledged (individual(s) signing document)

S. A. Will  
Notary Public signature

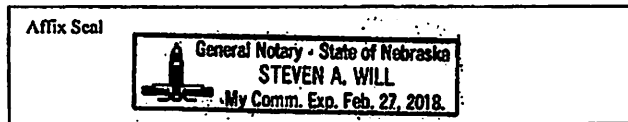

FORM 111  
REV APR 2015  
Page 3 of 3

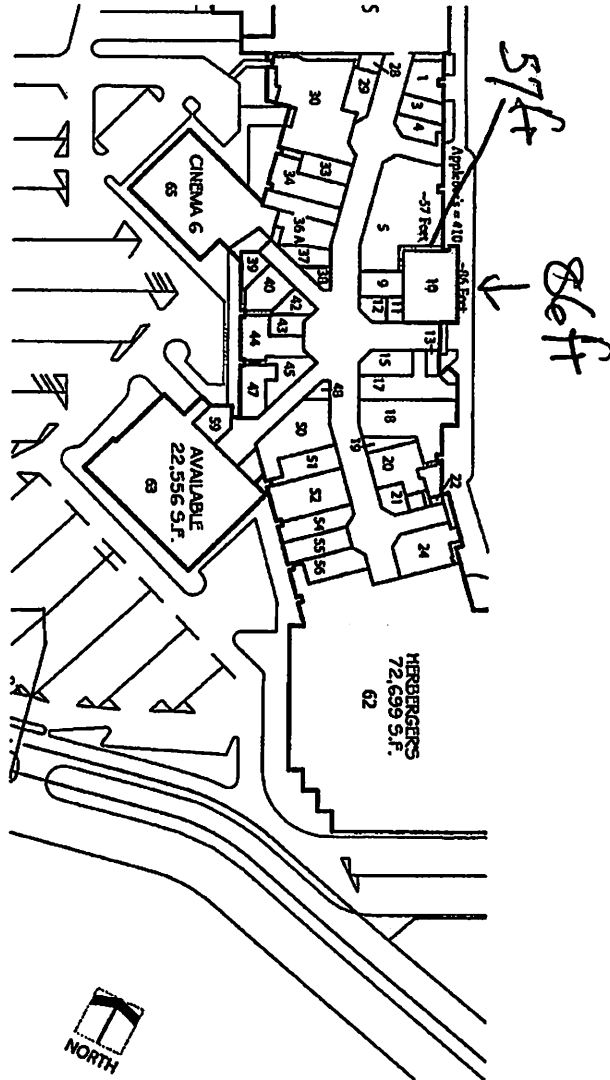

**RECEIVED**  
**OCT 7 2015**  
**NEBRASKA LIQUOR**  
**CONTROL COMMISSION**

# Memo

**Date:** October 20, 2015  
**To:** Honorable Mayor and City Council  
**From:** Annie Urdiales, Planning Administrator  
**CC:** Rick Kuckkahn, City Manager  
**Re:** Class "I" Liquor License Application for Change of Location  
Applebee's Neighborhood Grill & Bar  
2302 Frontage Road – space # 10  
Scottsbluff, NE 69361

**Action:**

---

Applebee's Neighborhood Bar & Grill have requested a change of location for their existing liquor license # 1101602 which is currently located at 2621 5<sup>th</sup> Avenue, this area is zoned C-2 (Neighborhood Retail and Commercial). The business is planning a move in November to a new location at the Monument Mall; the new address is 2302 Frontage Road.

The new location is situated in a PBC (Planned Business Center) zoning district where the use is allowed by right pursuant to the City's Zoning Ordinance, Chapter 25, of the City's Municipal Code of Ordinances. Adequate parking exists with shared parking with the other businesses at the Mall. The use of this property is consistent with the surrounding neighborhood as it relates to commercial activities, retail sales, and services. There are no schools or churches located within 500' of the property.

# Memo

**To:** Scottsbluff City Council  
**From:** Anthony J Murphy, Fire Marshal  
**cc:** Cindy Dickinson, City Clerk; Dana Miller, Fire Chief  
**Date:** October 26, 2015  
**Re:** Applebee's Change of Location – Liquor License

---

Regarding the Applebee's change in location, the Fire Department has been very active in the construction process. Any egress, fire, or other life safety issues will be corrected prior to our issuance of a Certificate of Occupancy. We do not anticipate any life safety concerns at our final walk-through.