



# City of Grand Island

Tuesday, July 15, 2003  
Special Mtg/Study Session

## Item -4

### Update Regarding Wasmer Detention Cell

*The item to discuss a future storm water detention cell at the old Wasmer School location adjacent to South Broadwell Avenue was on the agenda for the Council retreat in February 2003. The item was not covered due to time constraints.*

Staff Contact: Steve Riehle, City Engineer/Public Works Director

# Wasmer (School) Detention Cell

- Staff would like to use the old Wasmer School Property for construction of a detention cell
- We believe that GIPS is ready to dispose of the Property



Koenig & Monroe – Looking Northwest



Koenig & Monroe – Looking Northwest



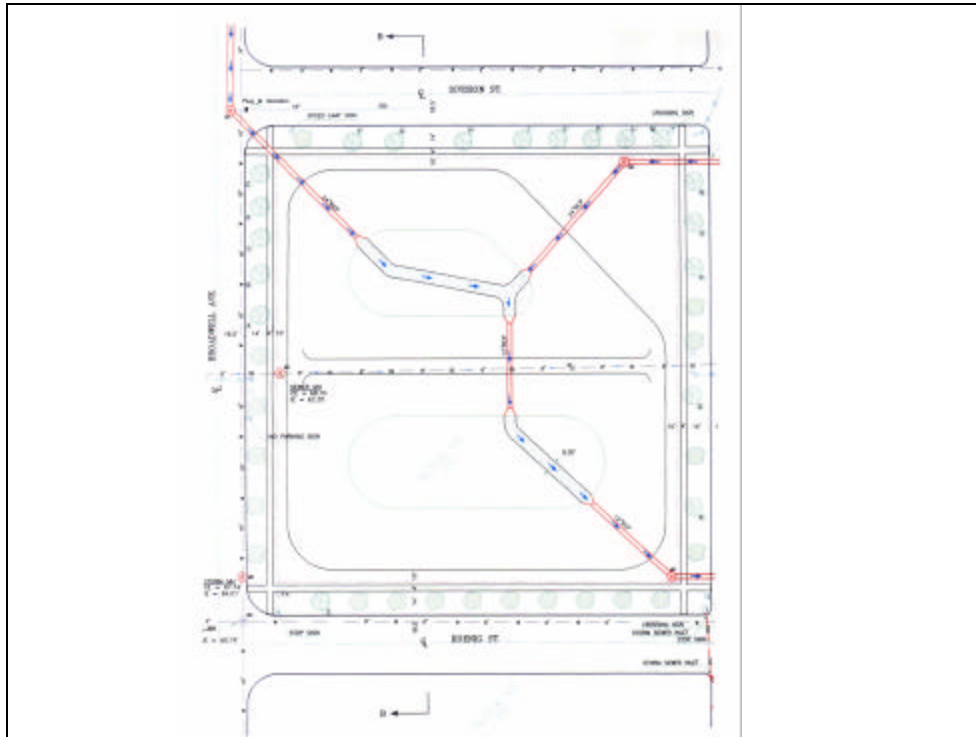

## Wasmer (School) Detention Cell

- Benefits of Cell
  - Alleviates flooding of Second Street
    - Current Storm Sewer has 2 year capacity
    - Design Standard is 10 year capacity
- Cell can be designed to not raise water level into basements
- Cell can be designed to minimize amount of time it is wet
- Building the cell is the best option to improve Second Street Drainage