



# City of Grand Island

Tuesday, October 11, 2011

Council Session

## Item G7

**#2011-298 - Approving Acquisition of Utility Easement - 4124  
North Webb Road - Leonard & Marlene Mader**

*This item relates to the aforementioned Public Hearing item E-2.*

Staff Contact: Tim Luchsinger

RESOLUTION 2011-298

WHEREAS, a public utility easement is required by the City of Grand Island, from Leonard and Marlene Mader, to survey, construct, inspect, maintain, repair, replace, relocate, extend, remove, and operate thereon, public utilities and appurtenances, including lines and transformers; and;

WHEREAS, a public hearing was held on October 11, 2011, for the purpose of discussing the proposed acquisition of an easement located in Hall County, Nebraska; and more particularly described as follows:

Commencing at the southeast corner of the Southeast Quarter (SE1/4) of Section Twenty Five (25), Township Twelve (12) North, Range Ten (10) West; thence running northerly along the easterly line of the said Southeast Quarter (SE1/4), on an assumed bearing of N0°45'57"W, a distance of eight hundred seventy seven and seventy five hundredths (877.75) feet; thence S89°14'03"W, a distance of thirty three (33.0) feet, to a point on the westerly right-of-way line of Webb Road being the ACTUAL Point of Beginning; thence S72°08'11"W, a distance of one hundred eleven and eleven hundredths (111.11) feet; thence S88°08'06"W, a distance of two hundred fifty (250.0) feet. The side lines of the above described tract shall be prolonged or shortened as required to terminate on the boundary of the Grantor's property.

The above-described easement and right-of-way containing a total of 0.166 acres, more or less, as shown on the plat dated 9/13/2011, marked Exhibit "A", attached hereto and incorporated herein by reference,

NOW, THEREFORE, BE IT RESOLVED BY THE MAYOR AND COUNCIL OF THE CITY OF GRAND ISLAND, NEBRASKA, that the City of Grand Island be, and hereby is, authorized to acquire a public utility easement from Leonard and Marlene Mader, on the above-described tract of land.

- - -

Adopted by the City Council of the City of Grand Island, Nebraska, October 11, 2011.

\_\_\_\_\_  
Jay Vavricek, Mayor

Attest:

\_\_\_\_\_  
RaNae Edwards, City Clerk

Approved as to Form  \_\_\_\_\_  
October 5, 2011  City Attorney

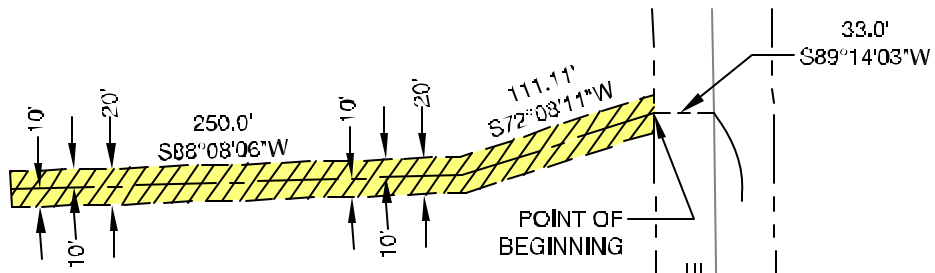

PART OF  
SE 1/4,  
SECTION  
25-T12N-R10W

PART OF  
FRACTIONAL  
SECTION  
30-T12N-R9W

WESTERLY R-O-W LINE-  
WEBB ROAD

ASTERLY LINE  
SE 1/4  
SEC. 25-T12N-R9W

HERMAN'S  
SUB.

LOT 1

SE CORNER  
SE 1/4  
SEC. 25-T12N-R10W

ABBOTT

ROAD

ROAD

WEBB



LEGEND

 INDICATES 20' WIDE  
UTILITY EASEMENT

CITY OF  
**GRAND ISLAND**  
UTILITIES DEPARTMENT

**EXHIBIT "A"**

DRN BY: K.J.M.	SCALE: 1" = 100'
DATE: 9/13/2011	FILE: SX 25.12.10