



City of Grand Island

Tuesday, June 28, 2011

Council Session

Item I5

**#2011-162 - Consideration of Approving a Resolution Authorizing
the Operation of the City Dewatering Wells**

Staff Contact: John Collins, Public Works Director

Council Agenda Memo

From: John Collins, Public Works Director

Meeting: June 28, 2011

Subject: Approving a Resolution Authorizing the Operation of the City Dewatering Wells

Item #'s: I-5

Presenter(s): John Collins, Public Works Director

Background

On December 21, 1998 the City entered into an agreement with the Central Platte Natural Resources District (CPNRD), which provided for the installation of test and monitoring wells. These wells were placed in the following areas, Cambridge Road, Sun Valley Avenue, and Phoenix Avenue, and allowed for studying the success of lowering groundwater levels.

Olsson Associates was the consulting engineering firm selected to conduct the study. The study recommended the installation of a series of vertical wells and a pipeline to carry the water to the Platte River. The study was completed in September 2000 and estimated the cost for the construction at \$13,063,000, with an annual cost to amortize these improvements at \$1,233,100. The annual operation and maintenance costs were estimated at \$341,000.

The agreement dated, December 21, 1998, transferred ownership to the City upon termination, stating: "All personal property and fixtures acquired and used in the demonstration project shall be owned by the District. In the event the demonstration project is terminated and is not superseded by a permanent dewatering project any remaining equipment and fixtures shall become the property of the City...."

The agreement places liability on the City, stating: "All cost of removal of the equipment and fixtures and abandonment and capping of wells shall be part of the actual expenses subject to reimbursement by the City ..."

The City Council authorized this demonstration project for a period not to exceed 36 months, as stated in the agreement: "The Interlocal Cooperation Agreement shall remain in full force and effect during the term of the demonstration project, this being a period not to exceed thirty-six (36) months from the date of execution by the City and District."

The agreement further stated: “In the event the City and District mutually agree that the demonstration project is successful and beneficial for the City and District, the Interlocal Cooperation Agreement may remain in full force and effect pursuant to amendment to be approved and adopted by the parties until superseded by a permanent dewatering project of some nature.” The only amendment made dealt with hiring a consultant, and reiterated the 36 month time limit.

When approving the resolution to approve the report, the City Council deleted 3 paragraphs and part of a fourth to avoid giving any hint that the Council was approving any implementation of the Study’s recommendations. Note that there were several letters published in the Independent indicating that this project was somewhat controversial. Comments attached to the 2007/2008 Dewatering Well Citizen Survey also indicate that this was controversial.

The language of the agreement set a 36 month limit on Public Works for operating these wells, and Council authorization was required to continue beyond the 36 months. For this reason, only specifically granting authorization would have allowed this activity to continue. Public Works was advised by the Legal Department that without authorization activities should cease.

The issue of authorization was presented at the June 7, 2011 Council Study Session, where most of the discussion centered on the benefits of dewatering wells, which was not in question.

Villa Mar Dee Avenue was installed to dewater the area so that water and sewer lines could be constructed, and was meant to be temporary. We can find no records on the installation of the Nevada Avenue well. Authorization is not needed for Public Works to operate these wells, but they are included so that a consistent operations policy can be implemented. Note that Public Works has received a number of calls from groups interested in having the City operate their wells.

Discussion

The issue of the City operating these wells was presented at the June 7, 2011 Study Session. For the Public Works Department to be in compliance a resolution must be approved, authorizing the City to fund these wells if that is the desire of the City Council.

Alternatives

It appears that the Council has the following alternatives concerning the issue at hand. The Council may:

1. Move to approve
2. Refer the issue to a Committee

3. Postpone the issue to future date
4. Take no action on the issue – note that this is equivalent to directing Public Works to discontinue
5. Direct Public Works to establish Dewatering Districts to fund these facilities
6. Direct Public Works to transfer these facilities to a party within each well's cone of influence.

Recommendation

City Administration recommends that the Council take action on the resolution authorizing funding of the City dewatering wells.

Sample Motion

Move to approve the resolution.

INTEROFFICE MEMORANDUM

From the



Public Works Department

*Working Together for a
Better Tomorrow, Today.*

DATE: June 22, 2011

TO: John Collins

FROM: Terry Brown

RE: Dewatering Wells replacement costs

This memo addresses the cost associated with replacement of the 5 dewatering wells installed by the Central Platte NRD for the groundwater dewatering study. The wells were installed in 1999 and were 5 hp submersible pumps typical to the temporary dewatering wells used during underground utility work. The expected life of a submersible pump is approximately 10-15 years. Public Works Engineering would assume these wells would need to be replaced and updated to more of a comparable well and pump already found within Public Works. At least two of the wells would need to be relocated to provide legal access for maintenance and installation. The replacement wells, with a much longer lifespan and higher energy efficiency, would consist of a 15 hp turbine pump with 16" casing piping. The estimated costs for replacement range between \$19,000 to \$26,000 for each well. The following table illustrates the three different well installation costs:

	Quote #1	Quote #2	Quote #3
16" casing; 60'	\$47.00'	\$50.00'	\$70.00'
Mobilize	\$500.00	\$750.00	\$2,000.00
6" Turbine 15-20 hp	\$10,750.00	\$8,450.00	\$12,000.00
Pump Panel	\$500.00	\$500.00	\$500.00
Register/Permit	\$200.00	\$230.00	\$200.00
Decommission Exist.	\$500.00	\$600.00	\$1,000.00
10% Electrical	\$1,500.00	\$1,350.00	\$1,990.00
OmniSite Crystal Ball	\$3,350.00	\$3,350.00	\$3,350.00
5% Contingency	\$840.00	\$750.00	\$1,100.00
Total	\$20,960	\$18,980	\$26,340

The wells installed for the CPNRD study had a very basic on/off control panel which would need to be upgraded to a municipal control/tracking remote management system. An OmniSite Crystal Ball remote wireless system would cost \$3,350 per well. This system would allow the Public Works Department to control and monitor the operation of the dewatering wells at all times. An additional annual \$276 per well (\$1,380 total for 5 wells) for data service would need to be included.

To help monitor the groundwater levels and help determine the controls of the dewatering wells, the Public Works Department would recommend adding remote monitoring to 12 of the 39 monitoring wells in the city. A solar power remote recording unit is estimated to cost \$6,550 for a total of \$78,600 for the twelve monitoring locations. The annual data service would be estimated at \$240 for twelve monitoring locations.

At least two of the existing dewatering wells discharge groundwater to unlined drainage ditches. An estimated 5,800 lf of drainage ditches would need to be lined to help with maintenance of the ditches because of the continued flow of water. An estimated amount for the concrete lining would be \$220,000.

The electrical service bill annual range for these wells depends on the duration of time they are in use. An estimated cost based on the last 5 year utility records would range between \$10,000 to \$17,000 per year for the five wells.

Total replacement costs:	\$100,000 for 5 replacement wells
	\$80,000 for monitoring well upgrades
	<u>\$220,000 for concrete lining of drainage ditches</u>
	\$400,000

Annual operational costs:	\$520 annual cost for data service
	\$10,000 to \$17,000 annual cost for electrical service
	*Annual Maintenance has not been included

JOINT CITY-NRD GROUND WATER DEWATERING PROJECT

**INTERLOCAL COOPERATION AGREEMENT
BY AND BETWEEN THE CITY OF GRAND ISLAND
AND CENTRAL PLATTE NATURAL RESOURCES DISTRICT**

THIS AGREEMENT is made on December 21, 1998 by and between the CITY OF GRAND ISLAND, NEBRASKA, a Municipal Corporation (City) and CENTRAL PLATTE NATURAL RESOURCES DISTRICT, a Political Subdivision (District).

1. STATEMENT OF PURPOSE. The purpose of this Interlocal Cooperation Agreement is to carry out a Demonstration Ground Water Dewatering Project in the City and to outline the respective responsibilities and duties of the City and District in connection with the project.

2. DISTRICT'S RESPONSIBILITIES AND DUTIES. The District's responsibilities and duties shall include:

- a. Planning, designing, administering, supervising and implementing the demonstration project.
- b. Acting as the "contracting agency" for the demonstration project.
- c. Informing the City on an ongoing basis of the data generated from and the status of the demonstration project.
- d. Establishing and maintaining a project budget.

3. CITY'S RESPONSIBILITIES AND DUTIES. The City's responsibilities and duties shall include:

- a. Reimbursement of the District for its actual expenses incurred in connection with the demonstration project including equipment and fixture purchases and installation, repair, maintenance, operation and removal of the same.

- b. Supplying electrical power and storm water sewer and drainage facilities for the demonstration project.
- c. Keeping the District informed concerning the City's analysis and conclusions concerning the demonstration project.

4. DURATION. This Interlocal Cooperation Agreement shall remain in full force and effect during the term of the demonstration project, this being a period not to exceed thirty-six (36) months from the date of execution by the City and District. The Interlocal Cooperation Agreement may be terminated earlier by either party notifying the other in writing of its intention to terminate participation in the project not less than thirty (30) days following mailing of said notification.

In the event the City and District mutually agree that the demonstration project is successful and beneficial for the City and District, this Interlocal Cooperation Agreement may remain in full force and effect pursuant to amendment to be approved and adopted by the parties until superseded by a permanent dewatering project of some nature.

5. ACQUISITION, OWNERSHIP AND DISPOSAL OF PROJECT PROPERTY. All personal property and fixtures acquired and used in the demonstration project shall be owned by the District. In the event the demonstration project, is terminated and is not superseded by a permanent dewatering project any remaining equipment and fixtures shall become the property of the City and may either be left in place at the various demonstration project sites or removed, whichever is mutually agreeable to the parties. All costs of removal of the equipment and fixtures and abandonment and capping of wells shall be part of the actual expenses subject to reimbursement by the City pursuant to paragraph 3a above.

6. SEPARATE ENTITY. The parties agree that separate entity is created by this Interlocal Agreement.

7. CHOICE OF LAWS. This Interlocal Agreement shall be construed in accordance with the laws of the State of Nebraska including, but not limited to, the Interlocal Cooperation Act, Neb. Rev. Stat. §13-801 et seq., as amended.

8. ENTIRE AGREEMENT. This Interlocal Agreement shall constitute the entire agreement between the City and District relating to the proposed Demonstration Groundwater Dewatering Project and may be amended only in writing duly approved and adopted by the respective parties.

9. EFFECTIVE DATE. This Interlocal Cooperation Agreement shall be effective upon approval by the Mayor and City Council of the City and the Board of Directors of the District and execution by the parties' respective executive officers.

CENTRAL PLATTE NATURAL RESOURCES DISTRICT

By *Richard Mercer*
RICHARD MERCER, Chairman

Attest: *John Tarrell*
JOHN TARRELL, Secretary

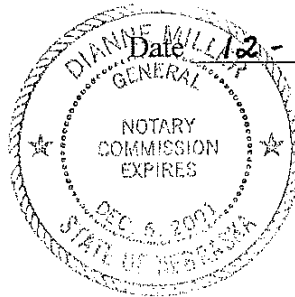

Date 12-17-98

CITY OF GRAND ISLAND, NEBRASKA

By *Ken Gnadt*
KEN GNADT, Mayor

Attest: *Cindy K. Johnson*
CINDY K. JOHNSON, City Clerk

Date 12/23/98

The contract is in due form according to law and hereby approved.

Charles Cygus
Attorney for the City

Date 12-28-98

**JOINT CITY-NRD GROUND WATER DEWATERING PLAN
AMENDMENT TO
INTERLOCAL COOPERATIVE AGREEMENT
BY AND BETWEEN THE CITY OF GRAND ISLAND
AND CENTRAL PLATTE NATURAL RESOURCES DISTRICT**

THIS AMENDMENT AGREEMENT is made on October 25, 1999
by and between the CITY OF GRAND ISLAND, NEBRASKA, a Municipal
Corporation (City) and CENTRAL PLATTE NATURAL RESOURCES DISTRICT,
a Political Subdivision (District).

1. **STATEMENT OF PURPOSE.** The purpose of this Amendment to the Interlocal Cooperation Agreement dated December 21, 1998 is to secure the services of a consultant to provide engineering services to plan a de-watering system for those parts of the City of Grand Island where water tables can rise to a level that allows water to enter basements. The proposed engineering services would include a preliminary plan for the location of wells or other de-watering works (tile drains, etc.); and alternatives available for the accumulation, transport and disposal of the excess ground water.

2. **DISTRICT'S RESPONSIBILITY AND DUTIES.** The District's responsibilities and duties shall include:

- a. Act as the "contracting agency" for the planning project.
- b. Provide three (3) members to an evaluation/selection team to review proposals and select a firm.
- c. Provide fifty percent (50%) of the funds for the engineering services, not to exceed \$50,000.00 (50% of \$100,000.00).
- d. Advance the balance of funds for the engineering services, subject to reimbursement by the City as provided below.

3. **CITY'S RESPONSIBILITY AND DUTIES.** The City's responsibilities and duties shall include:

- a. Provide four (4) members to an evaluation/selection team to review proposals and select a firm.
- b. Reimbursement of the District for fifty percent (50%) of actual expenses incurred in connection with the engineering services for the first \$100,000.00 total cost and 100% of all costs over \$100,000.00.

4. DURATION. This Amendment to the Interlocal Cooperation Agreement shall remain in full force and effect during the term of the planning period, this being a period not to exceed thirty-six (36) months from the date of execution by the City and District or the termination of the Interlocal Cooperative Agreement dated December 21, 1998, whichever is earlier. The Interlocal Cooperation Agreement may be terminated earlier by either party notifying the other in writing of its intention to terminate participation in the project not less than thirty (30) days following mailing of said notification.

5. SEPARATE ENTITY. The parties agree that separate entity is created by this Interlocal Agreement.

6. CHOICE OF LAWS. This Amendment to the Interlocal Agreement shall be construed in accordance with the laws of the State of Nebraska including, but not limited to, the Interlocal Cooperation Act, Neb. Rev. §13-801 et seq., as amended.

7. ENTIRE AGREEMENT. This Amendment to the Interlocal Agreement shall constitute the entire agreement between the City and District relating to the proposed Engineering Services and may be amended only in writing duly approved and adopted by the respective parties.

8. EFFECTIVE DATE. This Amendment to the Interlocal Cooperation Agreement shall be effective upon approval by the Mayor and City Council of the City and the Board of Directors of the District and execution by the parties' respective executive officers.

CENTRAL PLATTE NATURAL RESOURCES DISTRICT

By Charles B. Bica Date Sept 23, 1999
CHARLES BICAK, Chairman

Attest: John Tarrell
JOHN TARRELL, Secretary

CITY OF GRAND ISLAND, NEBRASKA

By Ken Gnadt Date October 25, 1999
KEN GNADT, Mayor

Attest: Cindy K. Johnson
CINDY K. JOHNSON, City Clerk

This contract is in due form according to law and hereby approved.

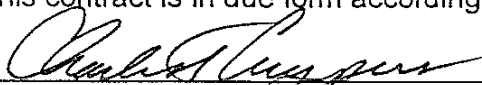

Attorney for the City

Date 10-26-99

2007/2008 Dewatering Well Citizen Survey

1. Survey Results
2. Survey Responses
3. Survey Comments

Groundwater Survey

Surveys Sent November 2007

Surveys Sent out	6,799
*Surveys Returned Undelivered	919
Actual Surveys Delivered	5,880
Responded to Survey	1,559
Response Rate (responded/actual)	26.51%

*Surveys sent to vacant lots

Responded to Survey

Question 1.	Do you have a basement?	
a.	Response that have a basement (yes)	1,218
b.	Response that Don't have a basement (no)	341
	Total surveys responded	1,559
Question 2.	Do you currently have groundwater intrusion problems in your basement?	
a.	Response that currently have water in basement (yes)	138
b.	Response that do not currently have water in basement (no)	1,075
	Answered this question	1,213
Question 3.	Have you had groundwater intrusion problems in your basement in the past?	
a.	Response that had water in past with a basement (yes)	498
b.	Response that had not had water in past with a basement (no)	693
	Answered this question	1,191
Question 4.	Have you taken measures to mitigate groundwater intrusion?	
a.	Taken measures to mitigate intrusion (yes)	322
b.	Not taken measures to mitigate intrusion (no)	207
	Answered this question	529
Question 5.	Have your mitigation measures worked?	
a.	Mitigations measures worked for intrusion (yes)	206
b.	Mitigation measures have not worked for intrusion (no)	91
	Answered this question	297

Microsoft Access

File Edit View Insert Format Records Tools Window Help

Typed a question for help

Flooded Basements

Comment

	Yes
I am opposed to the City taking any action.	<input type="radio"/>
Home was built with measures taken because of known water problems.	<input type="radio"/>
All we have is a crawl space.	<input type="radio"/>
We have filled in or are going to fill in basement.	<input type="radio"/>
Never had a problem.	<input type="radio"/>

First Name: Cheryl
 Last Name: Triplett
 Address: 4004 W/ Fardley Ave
 ZIP Code: 68601
 Phone Number: 381-1495
 Email:

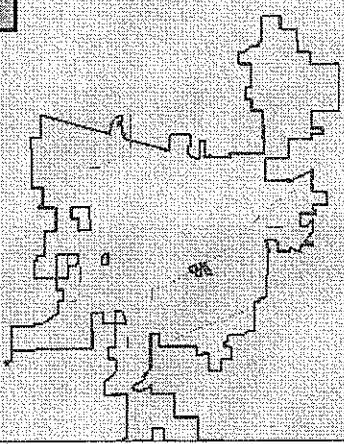

Form View

NUM

start Deleted Items - Micro Steven Riche - Calen MapSite 5.0: Land 5 Microsoft Access 1:53 PM

CITY OF GRAND ISLAND

October 29, 2007

Dear Resident

The issue of high water tables and groundwater intrusion into basements has a long history in Grand Island. It is for this reason that the City of Grand Island has commissioned the attached survey.

Please have the appropriate member of the household spend a few minutes to answer all the questions and return the survey with your utility bill or mail to the return address. Your answers will help us to fully define the extend of ground-water problems and the impact on your household and neighborhood.

Your participation in this survey is very important – especially since your household is one of only 4,500 households being surveyed. If you have any questions about this survey, please call Grand Island Public Works Department at (308) 385-5444 Ext. 260 or email us at publicworks@grand-island.com.

Thank you for your help and participation.

Respectfully,

Jeff Pederson
City Administrator

City Hall • 100 East First Street • Box 1968 • Grand Island, Nebraska 68802-1968

Out Here

Ground Water Survey

City of Grand Island

Please check the response that most closely represents your belief for each questions.

Do you have a basement?

☐ Yes ☐ No

Do you currently have groundwater intrusion problems in your basement?

☐ Yes ☐ No

Have you had groundwater intrusion problems in your basement in the past?

☐ Yes ☐ No

Have you taken measures to mitigate groundwater intrusion?

☐ Yes ☐ No

Have the mitigation measures worked?

☐ Yes ☐ No

Comments:

First Name

Last Name

Address *

Zip*

Phone Number

Email Address

*Required Information

Our basement had groundwater come up through the floor of 1 room this summer but would have probably in all the rooms except that most of the neighbors were pumping continuously (next door they had 2 hoses coming out of their basement). Our basement was completely finished when we moved here in 1983 but have had to remove the carpet at least 3 times through the years, and the last time did not even put any back down. So now the basement just has a cement floor and is basically unusable as a living space, mainly just used for storage. I would like to sell in a few years but am afraid no one will want to buy it because of the water problems. I would like to buy a condo but any newer ones that I look at have full finished basements--I don't want to go through all this again, and worry each time it rains. I am considering moving out of town because there is not much available. It seems like all the new houses being built in the northwest area also have finished basements. With the history of groundwater problems in that area it's like a disaster waiting to happen. It's going to be difficult to get new people to move to G.I. when they learn of the water issues.

Why do the building codes even allow full basements in this city with its high water table (especially northwest G.I.)? All houses should only have crawl spaces, then there would be no problems. 2530 Stagecoach Rd.

11-18-07

There been here over 30 yrs.
no water problem until, you
took all the water from
Capital Heights & put it in
a detention cell between 381
& sold an capital case that
was a big mess for all
basement out here. Taking
been done, you take us to
we're going to be that, &
you did the south side.
We took it into our own
hands & put in a pump.
The mess down when the
water will come in, our
basement is of no use
to us.

O'Flannagun

no house # given.

There is no way there is enough room on your small sheet to voice my opinion. We bought a house (many years ago) that was known NOT to have water problems. We have a basement but it is not one of the deep ones that have become so popular.

Why were the houses with basements EVER allowed to be built in an area that was known to be a "slough"? This is totally beyond my reasoning. Perhaps the developers should come in and take responsibility for their error. But they, like the city officials that were in office at that time, are no longer around. They made a profit and left.

We have lived at our address for 35 years and have watched as houses were built in places we knew the water would settle. I'm sure there were some "engineering" studies that showed us to be wrong.

In the time being we have managed to fight our way through many turbulent times with the City of Grand Island.

I think your bottom line is to try to talk all of us into paying for someone else's mistake. My husband & I have spent a small fortune to work out all our problems with the city of GI (considering we were in Hall County when we moved here - not the City of GI). The very latest being the sidewalks we were forced to put in. Yes, they are nice, BUT we paid the whole price for them.

I feel for the people that live the effected area. I'm sure they hate having the water in their basements and I do realize it is caused by the shut down of a well - but again, I ask you why these houses were allowed to be built. Nothing is forever. Things change at the drop of a hat! If the land is in a low area - the land is in a low area - what more can be said? Anyone buying a house in this area should have looked at where it sat!! That would tell you EVERYTHING!

If every GI resident should become responsible for part of the cost of fixing this problem will the City of GI reimburse everyone in my area for the expense spent for sidewalks? Will they reimburse the residents along Stolly Park Road for the widening of the street?

A handwritten signature in black ink, appearing to read "Connie".

417 W. Capital Ave

11-19-07

My wife and I were instrumental in getting the dewatering district stopped in 1993, that the council had passed. We went house to house and gathered approximately 300 signatures on a petition. If that would have stayed in place at the estimated annual cost, we would have spent over \$20,000 by now for a service that we didn't need.

When we built our home in 1977 we built about two rows of block higher than what was then the average elevation and it didn't cost us any more. We have full 8ft. ceilings in our basement.

How would you ever sell home in an area, when you tell the future buyer that in addition to taxes you had to pay another \$2,000 a year to keep your neighbors basement dry.

Don't try to fool mother nature.

Jay Determan

4248 Manchester

A handwritten signature in cursive script that reads "Jay Determan". The signature is written in dark ink and is positioned below the printed name and address.

We purchased our home in the spring of 1979. At the time of purchase, there was a sand point well (that we were told was used for watering the lawn), and a sump pump. The basement was unfinished, so the following spring when we noticed some moisture coming through the cracks, we were not too alarmed. We would just keep an eye on the basement every spring and would mop up the water if it became too wet. By 1987 (or 1988), as our boys were growing, we realized that we had a need for more living space, so we hired B-Dry from Omaha to install a dewatering system, which included breaking up the concrete and installing pipes all around the perimeter of our basement and several laterals across, which were then hooked into our existing sump system. After a years time when we realized that a damp basement was no longer a yearly event, we proceeded to completely finish our basement into living space.

In May of 2005, when we received the 7-9 inches of rain overnight, during which our sewer backed up, we experienced 15-17 inches of waste and groundwater in our basement. After cleanup and drying out, we tried to make our basement useable again. At this time we did not carpet because of the dampness. We tried an epoxy paint, but because of the dampness, it is now chipping and peeling. Area rugs that we layed down have had to be rolled up to prevent mold and mildew from growing. Fans have had to be run constantly to keep the areas as dry as possible. We are constantly finding areas of mold. Our basement is no longer place which can be used for anything other than storage and laundry.

We need help. We feel that if the city is not going to take action to alleviate the problem, we should, at the very least, have our property taxes decreased because of the decreased use of our basements. We appreciate the fact that you are at least appear to be looking into our situation; but please, don't let this process drag out into years and years of "studying" the problem. We need action now!

Vern Rempe
1739 South Arthur
Grand Island, NE 68803
308-381-1864

Dear Mr. Pederson:

I suggest This query was
poorly Executed, poorly
formatted, lacked quality,
and questionable in Value
due to whom it was mailed
and the number printed.

Respectfully

Resident In Hall,
Land owner Merrick
R.W.

Groundwater Survey

City of Grand Island

Please check the response that most closely represents your belief for each question.

Do you have a basement?

☒ Yes ☐ No

Do you currently have groundwater intrusion problems in your basement?

☐ Yes ☒ No

Have you had groundwater intrusion problems in your basement in the past?

☒ Yes ☐ No

Have you taken measures to mitigate groundwater intrusion?

☒ Yes ☐ No *Should ponds in fields*

Have the mitigation measures worked?

☐ Yes ☒ No *1998 - in water table of duplicate*

Comments:

*Land since 8 yrs -
has some water couple of years
just leakage - 3007 has been pretty
bad w/ both basements being 1-3 inches
of water 3 times during the year -
(over)*

First Name Shirley Last Name Nielsen

Address * 3819-21 Circle Dr Zip * 68801

Phone Number 381-1356 Email Address shirley.nielsen@565.com
Cell 380-4443

*Required Information

3) Believe that severe frosts
caused the problems in 2007

1) of course, the rainfall

2) Droughting of Richmond Ave's
being allowed to deteriorate to
build, droughting that water
to Brentwood which is
higher than our area.

3) Several wells being
capped thereby allowing
water levels to rise
more than other years
before the capping

4) Retention cells in Shady
Park have been filled
each time we flooded &
sometimes the retention
cells have overflowed.

5) The Lake behind us to
the South has been full
for the first time this
year - The lake is
much higher than our
area -

Shirley A. Nelson

Groundwater Survey

City of Grand Island

Please check the response that most closely represents your belief for each question.

Do you have a basement?

☒ Yes ☐ No

Do you currently have groundwater intrusion problems in your basement?

☐ Yes ☒ No

Have you had groundwater intrusion problems in your basement in the past?

☒ Yes ☐ No

Have you taken measures to mitigate groundwater intrusion?

☒ Yes ☐ No

Have the mitigation measures worked?

☐ Yes ☒ No

Comments:

We just moved in here May 2007.

there is a beaver system. We
have had water 3 times since
moving in. We did figure out a
couple of solutions. We are
sure we will have more problem
Monday 6/27 McCune (see back)

First Name

Last Name

4031 Sacramento Cir. 68803

Address *

Zip *

(308) 395-1546 mccune7@msn.com

Phone Number

Email Address

But that I think we can take care of them. The previous owner did a lot of work to solve the problem.

Personal note: I think the city should stop allowing basements in these lower areas of town on new developments. Grand "Island" is just that. The people who move into GI get "stuck" with major problems. We are from the area and at least knew what we were looking for i.e. Beaver System, etc. before we moved to this location.

Groundwater Survey

City of Grand Island

Please check the response that most closely represents your belief for each question.

Do you have a basement?

☒ Yes ☐ No

Do you currently have groundwater intrusion problems in your basement?

☐ Yes ☒ No

Have you had groundwater intrusion problems in your basement in the past?

☒ Yes ☐ No

Have you taken measures to mitigate groundwater intrusion?

☒ Yes ☐ No

Have the mitigation measures worked?

☒ Yes ☐ No

Comments:

We moved here in 1993 (Summer)

No one told us about past

ground water problems in Capital

Heights. We had problems in

93 & 98. After 98 (over)

Rick Ewald

First Name

Last Name

4182 Norseman Ave 68803

Address *

Zip *

381-2297

Phone Number

Email Address

we had to put in a Beaver
System at a cost of over \$6500.
After 98, the area experienced
a drought until this year. Of
course the City Council looked
at the issue back in 93-98, and
then forgot about it until this
year.

We are not natives of
this area. We feel that the
City should not have allowed
basements to be built, unless
they were (are) willing to
help alleviate the problem.

It seems to us, you only
look at it while it is a problem
and then ignore it during the
time action could have taken
place.

I would be happy to
meet with you in person,
if you have or want additional
information.

Groundwater Survey

City of Grand Island

Please check the response that most closely represents your belief for each question.

Do you have a basement?

☒ Yes ☐ No

Do you currently have groundwater intrusion problems in your basement?

☐ Yes ☒ No

Have you had groundwater intrusion problems in your basement in the past?

☒ Yes ☐ No

Have you taken measures to mitigate groundwater intrusion?

☒ Yes ☐ No

Have the mitigation measures worked?

☒ Yes ☐ No

Comments:

The reason I have no groundwater problems in my basement is because the city had a RD put in a 300-gallon pump one property east of mine. There would be water in my basement now had this not taken place, I have no sump pumps in my basement.

First Name

ROGER

Last Name

LINDY

Address *

923 E. Phoenix Ave. 68801

ZIP *

384-5946

N/A

Phone Number

Email Address

11/25/07

to whom if my concern, address the floors
I have lived at this address the floors
and two months I've lived in Grand Island,
I've had water in my basement two or three
times when we have had a lot of rain fall.
It is bad whether it be an inch or 6" in the
basement as it causes much damage to any
furnaces, water heaters, etc. And the mold
and mildew must be cleaned professionally,
since they can create a terrible health
problem. This can be very expensive and
stressful.

When the Burdick Power Plant was the
only source of power production in our
area no wet basement problems in our
area. Since the large leaks used for the water
level under ground down to 30 or more,
my neighbor, Matt (Island) had records he
had kept for years which showed the
depths when he measured from an open-
ing in his basement floor. This plant
was quite quickly as the Burdick plant
was replaced by the Coal-fired plant
south of the city. When the water level
plant is used sparingly, the water level
rises again. The pump across (west) from
Spauls Bowl will decrease water levels
in our area as much as 4" in a day.
(Major crisis ordered if turned on to help
the water out of our basements in the
early 1980s. He was a great leader!)
When ARI and the city officials decided
to try some test pumps like so I entered to
have one in our area. It has been a blessing,
it pumps 300 gpm into the storm sewer
and it will pull the water level down
greatly for quite some distance from the
pump's location. We have deep basements
because the homes were built when the
Burdick plant allowed very low water
levels under ground. Fight this cause and
many people will fight this cause as
honestly. I'm tired of some of the self-
concernedness. The city is so far from
us have safe and healthy environments and
which to live, water level reductions are
no different in my opinion. I hope no one
fire and police department to have them
none there, but you need us I urge, please

November 21, 2008

To: ----- City Hall - Public Works Department - Ground water survey
100 East First Street - Box 1968
Grand Island NE 68802

From: ----- R J Olson
2203 Woodridge Lane
Grand Island NE 68801

Subject: ----- Ground water survey

Gentlemen:

Attached is your survey sheet, which I am submitting under duress. I have no intention of ever being part of a ground water de-watering district. My, or our house butts right up against the City Cemetery, consequently we are on some of the highest ground of the city. My point is if we have any ground water in our basement a major part of Grand Island will be under water. Take 2203 Woodridge lane out of the district.

Signed: ----- R J Olson (former Director of Utilities City of Grand Island)

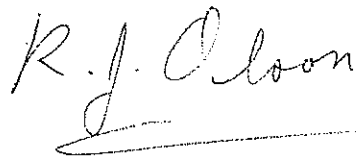
A handwritten signature in cursive script that reads "R. J. Olson". The signature is written in dark ink and is positioned above a horizontal line that serves as a baseline for the signature.

Dear Mr. Peterson,

The groundwater problem was discovered in 1999. So far all the city has done for us, is conduct surveys and hold meetings.

We feel the city has caused our problems by shutting down the 5 city wells. Mr. Mader and Mr. Rhiel have joined together to oppose any simple solution to alleviate our problems. When we would water our lawn last summer, the water level below our house would drop $\frac{3}{4}$ to 1 inch...at least temporarily. We think that they could turn on city wells for short intervals without moving the plume. The high groundwater may even make the plume more mobile.

Our house is over 50 years old and this is the first time that it has had water. The first time we had ground water in our basement was on May 29, 2007. We had just sold our home and it was to be inspected that day by the buyers. We were shocked when the water appeared and of course, the buyers backed out.

We had to remove and destroy 100 yards of expensive carpet. We had to hire people to remove furniture and possessions from the basement. We are still renting a storage unit (\$50.00 a month). We had to rent a dumpster for the wet carpet and other things that the water destroyed. We had to hire men to remove the carpet and pad. We spent the summer diligently cleaning the perimeters with disinfectant solutions hopefully to prevent mold. (We cleaned daily)

We had a sump pump installed. We ran several floor sumps. Pioneer Blvd. does not have storm sewers so the water has to run out on our once beautiful lawn. The water has come and gone several times since last May 29. We currently do not have water but the sump pump runs every 40 seconds and our "dry" well shows that the water is 7 inches below our basement floor. We have a terraced lot and should not have water.

It is expensive to buy and run dehumidifier, fans, sump pumps, etc; I am an artist and have lost the income because I lost my basement art studio. We didn't get to see our children in Montana because we were afraid to leave home last summer. We are retired folk and should enjoy our twilight years instead of worrying every time a cloud shows up in the sky.

We pay our taxes, have installed sidewalks, we were part of the new water district so we will receive a hefty assessment for that. The first estimate for bringing the new water line to our house from was \$6800. We think this is too high so we will shop elsewhere.

We do not want to advertise the fact that we have had water because we need to sell our home. The acre lot is just too much work for my retired husband who has back problems. (Of course, we will have to disclose our problem to potential buyers but we don't want to publish it in the newspaper!)

I hope something can be done. Dewatering wells or lower the assessed value of our home....

Groundwater Survey

City of Grand Island

Please check the response that most closely represents your belief for each question.

Do you have a basement?

☒ Yes ☐ No

Do you currently have groundwater intrusion problems in your basement?

☒ Yes ☐ No

Have you had groundwater intrusion problems in your basement in the past?

☒ Yes ☐ No

Have you taken measures to mitigate groundwater intrusion?

☒ Yes ☐ No

Have the mitigation measures worked?

☐ Yes ☐ No

(?) Don't know!!

Comments:

Please see attached

Paper.

house - 810

First Name

Last Name

2924

Linn

68803

Address *

Zip *

308-389-9167

Phone Number

Email Address

r.l.j.soto@hamilton.net

*Required Information

Comments -

Two years ago we had to add a drain + tile system. We just recently had to add a 2nd pump + additional drain + tile. We have had to replace carpet two times within the last 2 years and have spent over \$20,000. out of pocket in this time period because of this ground-water issue. Both pumps are currently running every 10-15 minutes 24-7 and the additions and changes we have made are an absolute NO guarantee.

This is a Huge problem.
We would expect the city to take responsibility since this is a city problem.

Thank you.

Louie + Renee Soto
2924 Lalar Ave.
68803

Groundwater Survey

City of Grand Island

Please check the response that most closely represents your belief for each question.

Do you have a basement?

☒ Yes ☐ No

Do you currently have groundwater intrusion problems in your basement?

☐ Yes ☒ No

Have you had groundwater intrusion problems in your basement in the past?

☐ Yes ☒ No

Have you taken measures to mitigate groundwater intrusion?

☒ Yes ☐ No

Have the mitigation measures worked?

☒ Yes ☐ No

Comments:

Depth to water on 11/17/07 was
8' 8" below the top of our
foundation - or 1.5' below our
basement floor - this is the highest
since 1997

First Name Last Name
Fred Chondarsky

Address * Zip*
822 E Delaware Ave 68501

Phone Number Email Address
352.1950

The rise in ground water levels is due to the fact that the city is no longer using many wells for various reasons.

Weather also plays a part in that periods of above normal rainfall contribute to ground water recharging.

What seems to be overlooked is the "missed" of down

Sprinkler systems. I see units running after we have had 2-3" of rain and it's still raining in mid Nov. We saw units

running every other day - or for August - but not Nov.

One inch of excess water on top of the ground can result in a 5" rise in G.W. levels. How to fix this? - education on the TV - lawn care providers

Overwatering can also result in G.W. Contamination of Fert. & Pesticides

Groundwater Survey

City of Grand Island

Please check the response that most closely represents your belief for each question.

Do you have a basement?

☒ Yes ☐ No

Do you currently have groundwater intrusion problems in your basement?

☐ Yes ☒ No

Have you had groundwater intrusion problems in your basement in the past?

☒ Yes ☐ No

Have you taken measures to mitigate groundwater intrusion?

☒ Yes ☐ No

Have the mitigation measures worked?

☒ Yes ☐ No

Comments:

Spent 2 weeks on B-dry system with corrugated pipe under basement floor. Also have decontaminating well on our street which helps immensely for all neighbors.

Sharon Over
Last Name

42916 Nevada Avenue
Address *

Zip *

384-1258

Phone Number

Email Address

When we purchased our home in 1975 we asked the builder and Real Estate representative if there were any groundwater issues.

They said no - this area will not get water.

In 1985 we had water on a portion of our 1st best floor for the 1st time.

I don't know the solution but I do feel the deteriorating wells definitely help, HOW EVER, most

people cannot afford another \$100-\$500 on their utility bills for deteriorating. This is insane. Who could even want to purchase a home that had high utility bills due to this purpose.

The City approved bldg in these areas and I think the City should definitely help.

We, as a city, have paid for items in other areas without living in those areas so I

November 26, 2007

We want to express our concern in our area. We bought a lot and built our home. We were the 3rd house on the street. There were no homes built adjacent to us. Over the last three years, other homes have been built on our street at different heights out of the ground. Specifically, the house to the west of ours is 1 - 2 feet higher than ours. To the best of our knowledge, the runoff of the subdivision is built to drain down the back of the properties & out to the street. This is what our contractor tried to achieve. Our lot & the two lots to the east of us are now the lowest point on the street. Our lots seem to take on the runoff. To compound the problem, when Craig street was put in, it was also at a higher level than us. All the houses to the south of us are higher & their runoff comes on to our property. On two occasions, we had water in our basement. We had to gut the basement & replace many things. The May 2005 storm broke our window & we had 2 feet of water in the basement. We have spent thousands of dollars putting in drainage, refinishing our basement & re-landscaping to protect our home.

It is frustrating when no one will take responsibility to this problem. The city blames the developer. The developer blames the city. The contractor blames everyone and so on. We do not understand why there are not plans developed for drainage & someone regulating this.

I realize you are surveying ground water problems. Ours is a surface water problem. When you build a \$200,000 home in a new subdivision, you assume that everything, including all planning & development is taken care of accurately.

Please contact us if there are any additional questions.

Kevin & Rosanne Rish
4067 Allen Ave
Grand Island NE 68803
308-384-2976

about May until three weeks ago. When I do have water, we turn on the fans, a dehumidifier and are liberal with putting Clorox in the standing water to prevent a smell or mold growth.

If I had known that I was having a house built in a wetlands area, I certainly would have raised it from the current elevation. However, I was a new resident in town, and the Building Department approved the plans without any comments about potential water problems. Since I did not have any problems in my previous experience with a basement, the thought never even crossed my mind.

I feel that the problem was exacerbated this year because a construction group west of Highway 281 was allowed to pump water into Brentwood Lake all winter long, which raised the water table in the whole Brentwood subdivision abnormally before we received additional rain this past summer. This should have been diverted to the big ditch south of Stuhr Museum instead of to Brentwood, as it taxes the whole city water system. In addition, since rain was plentiful, the farmer who farms the field south of our property did very little irrigating, which normally draws the water table down somewhat.

I would be happy to be on a committee of concerned citizens to work with the city to come to a reasonable solution for this periodic problem.

Sincerely,

A handwritten signature in dark ink, appearing to read "Richard Van Zyl", written over a horizontal line.

Richard Van Zyl

RV/mwk

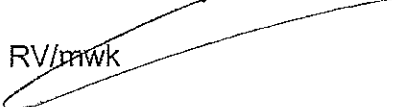
A long, horizontal, handwritten signature or flourish in dark ink, starting below the typed name "RV/mwk" and extending to the right.

**Richard Van Zyl
3111 W Brentwood Blvd
Grand Island, NE 68801**

November 29, 2007

City of Grand Island
Utilities Department
100 E First Street
PO Box 1968
Grand Island, NE 68802-1968

Gentlemen,

I recently received a letter from your department regarding the high water table in our community.

My wife and I moved to Grand Island shortly after the tornado, and at that time, there was no housing available at a reasonable price. A year later, we purchased a lot and had a house built. Previously, we lived in Sioux City, IA and Norfolk, NE. We had a basement in both of those communities, and since the weather is a real concern in this area, we decided that we would like a basement as well. We hired some contractors to build the house for us, and they proceeded to do so. I distinctly remember when the house was completed; they told me I should never have any water problems, because my basement was nine inches higher than my neighbor's basement.

Two to three years later, when we had some abnormal rain, I did have some water in my basement, and over the years, periodically have that same problem.

Sometime after having water in the basement, I contacted Bob Molly about a system he had to put in some pumps to keep the water out. However, since I had a poured sidewall with a brick façade, he was not able to seal it and said that he could not help me with the water situation. He also indicated that in the 1967 flood, the entire Brentwood area had three to four feet of water in it. This was the first that I knew that my property was in a very low part of town.

Over the years, I gradually changed the structure of my basement by putting in a false floor, which is about three to four inches above the actual concrete level of the basement. Since that time, I have periodically had water on the basement floor, but not on the second flooring that I built. I had water again this year from

Ground Water Survey Comment

Address	Comment
	we have a sump pump - partial basement
	If you have a basement in Grand Island it's your problem as ground water has always been high. The City of GI has other things more pressing.
1003 E Bismark Rd	had water in basement during 1967 flood
1003 E Oklahoma Ave	1/2 basement - lived here since 1981
1003 S Plum St	we recently moved to this address from 3306 andrew ave because of basement flooding at 3306 andrew ave. Groundwater is a severe problem in GI.
1005 S Vine St	once the water was 1/2 inch from my basement floor. My neighbor runs his pump & it lowers my water level. My basement was flooded in 1967 before I bought the house in 1968. no flooding since but it came very close about 8 or 10 years ago. Some of those basements which have flooded recently were built in the "old slew" area. Basements should never have been put there in many areas. Also the northwest area should have never had basements.
1007 E Oklahoma Ave	maybe where there's intrusions should not have basement
1007 S Vine St	no problems so far
1008 E Phoenix Ave	Split level house - semi basement. Flood of 1967 Doing Great!
1009 Sandalwood Dr	sump pump
1012 E Phoenix Ave	problems during flood of '67. the only time that we had water problems was during the 1967 flood
1013 S Adams St	business location - no basement to cause groundwater intrusion
1015 Sun Valley Dr	4' crawl space
1017 Pleasant View Dr	4' basement, not 8'
1020 S Cherry St	don't have basement in this area when houses were built. Can't have basements
1020 S Plum St	we've never had a problem with groundwater intrusion. Interior block was coated w/ dry lock masonry paint. Exterior moisture barrier as well.
1021 S Eugene St	last time I had water in the basement was during the flood in the 60's.
1023 E Bismark Rd	had water in 1967 put in pit & pumped out water. Have not had water since
1023 E Oklahoma Ave	problems spring '81. used vinegar to be sure to kill mold. We pumped it out. Approx 2" came in. No sump pump.
1023 S Pine St	We have a beaver system with large pump that has taken care of all water this year. The pump is still going.
1024 W Phoenix Ave	only time we have had water in basement when we had big rains of 2-3 inches or more
1027 S Eugene St	past problems were during flood of '67 -did have dampness - city turned on wells & it helped
1028 S Pine St	some of my neighbors pump 24 hrs a day
1033 S Pine St	water problem so bad this summer that I don't know what to do or how to try to fix the problem
1038 S Plum St	this summer had a little seepage into basement. 1st time in over 25 yrs
105 W South St	1 sump pump running & groundwater down a little. Helps but not completely if water level too high. I had 2 sumps running earlier this year & still had some water coming in. Better now but spring may bring problems
110 Seedling Mile Ct	crawl space
1103 E Nebraska Ave	We have not pumped water for 9 years. We only had water when the wood river would back up.
1103 Pleasant View Dr	measures have worked so far!

Address	Comment
1103 S Cherry St	we don't have a basement. Our crawl space gets damp - we bought this house with knowledge of groundwater problems in GI for years.
1103 S Plum St	have lived here for 10 yrs & have never had any problems. Keeping my fingers crossed!
1104 E Bismark Rd	water in 2003 - we have not had any problems except in 2003 when the drainage ditch was blocked & a field sand bagged which caused a backup
1104 N North Rd	when we built our home we had the basement floor put at one foot above the highest groundwater level ever recorded in our area
1104 S Eugene St	We have no problems or have had in the past. We have a sump pump in case
1104 S Sycamore St	as long as the sumps work, I'm okay. If the water table is really high & one sump quite I'll have a problem
1107 E Oklahoma Ave	has a working sump pump - not running though, no water to pump
1107 S Pine St	4 steps up to main floor
1107 Sun Valley Dr	since I'm a renter and have not been here long I am not sure if there has ever been a problem
1108 S Pine St	have installed dewatering system but it has ran since spring.
111 Villa Mar Dee Ave	raised basement floor 8"
1110 Hall Ct	Had no problems
1111 S Lincoln Ave	I personally believe spending that much money to lower the water table is BS. Instead lessen moratoriums & allow farmers to do so with irrigation.
1115 S Oak St	we have had no groundwater in our basement since the flood in 1967. however, there are 2 or 3 houses near us which are pumping from crawl spaces
1115 S Vine St	this past summer was the first time in 10 yrs. We have had groundwater seepage. I was not living in GI before then.
1116 Orange Rd	we only have a crawl space - no water problems so far
1117 S Eddy St	our basement is higher than our neighbors south of us & they are always pumping water when it rains.
1118 N North Rd	when we built our home in 1968 we made sure the basement floor was above the highest groundwater level at our location
1119 Pleasant View Dr	my home is seven years old. The previous owners did not have water problems, nor have i. In february I will have lived here 4 yrs
1119 S Adams St	manufacturing facility - no basement
1120 S Cherry St	we don't have a basement and we haven't had any water in our house or crawl space
1121 S Plum St	we have lived in this house since April 1973 and have never had groundwater intrusion problems in the basement
1123 E Nebraska Ave	crawl space
1123 S Eddy St	I think the city could install permanent water pumps in the areas that have water problems
1127 S Lincoln Ave	problems during flood of 1967. I only have water in basement when it rains hard. Have dehumidifier in use when rains & snows
1128 S Cherry St	split level
1131 S Eddy St	not lately - has worked so far
1131 S Lincoln Ave	had ground water during flood of 1967
1135 S Sycamore St	we built the basement 3 blks higher from base to keep from taking in water
1139 S Eddy St	sand point 5' beneath basement floor
1147 S Eddy St	measures have worked so far. When ground water goes up the city should automatically start their dewatering wells.
118 N Wetzel St	I have a crawl space under house.

Address	Comment
1211 S Lincoln Ave	we only had slight water problems after a big rain storm - wet carpet & floors. We put more dirt against the house & seemed to take care of it.
1215 S Lincoln Ave	have had no groundwater intrusion problems
122 Voss Rd	since we do not have a basement - we have no ground water problems.
125 Villa Mar Dee Ave	when it rains a lot water levels come up. I bought a second pump besides water sump to keep water down, but not 100% effective. Mold problems.
1304 Grand Ave	only water in basement I'm aware of was in 1967 flood
1311 S Lincoln Ave	installed backflow & the groundwater problem vanished. We still carry flood insurance as a precaution
1316 Mansfield Rd	our toen house is built with a higher grade to the land, so we've never had any water problems
1322 Mansfield Rd	no groundwater intrusion yet!! We will have some if we don't do something about standing water behind our house & in church yard. Need help from the city!
1328 Hagge Ave	have only been in this house 3 yrs
1407 S Newcastle Rd Apt 1	I have not had any problems since I moved. I have only lived here a little over a year
1409 Stagecoach Rd	None
1410 S Lincoln Ave	I DO NOT believe or support any of your ground water non sense. It is what it is - you cannot do anything about it by stealing more of our dollars
1411 Mansfield Rd	I would like to know why the water in certain sinks in my house - as well as several of my neighbors-smells bad. I would love for someone to investigate this for our neighborhood.
1411 Stagecoach Rd	5' deep storm shelter - no problems
1411 Sylvan St	only 2 times when heavy rains and groundwater is very high!
1413 Sylvan St	the water isn't always in the basement, but the wall is saturated with moisture & it gets to the floor with heavy rain
1414 S Harrison St	we need all the water. Farmers can't put in any more wells so don't pump water back to the platte river. That's a waste. Cheaper to fill in basements after all this is the old Platte River
1414 Windsor Rd	we moved into our house in April '07. I can not comment on groundwater intrusion prior to that date. The basement does not appear to have any damage from groundwater.
1415 Coventry Pl	this summer had problems, but not always. I installed a sand point & motor in the early 80's. I still have problems yearly when the groundwater is high.
1416 Mansfield Rd	longer drain spouts away from the house
1418 Rosemont Ave	we do not have wter in our basement, but our sump pump is still running - that's a problem! Measures worked until this spring. We installed our sump pump in 1992 and since that time it ran only once until this spring when the city water wells were shut down in this area. We feel immediate action needs to be taken to address the raised water levels due to the lack of draw from the wells. We have not had rain in GI for 29 days but our sump pump continues to run
1421 Stagecoach Rd	no water problems since diversion of wood river
1427 S Newcastle Rd Apt 1	this is an apartment complex
1428 Mansfield Rd	only lived here one year
1503 Rosemont Ave	under basement floor drain system with sump pump - haven't need to use it
1503 S Lincoln Ave	my intrusion was at least 10 yrs ago. I lost my carpet but have no problems since
1504 S Lincoln Ave	had water in basement when raining hard outside
1508 Ando Ave	I would not support a dewatering project
1511 Spruce Pl	split level
1512 Grand Ave	this spring we had groundwater in 2 bedrooms on the south side of our basement - no current problems
1512 Parkview Dr	any expense for dewatering project should be shared by the ENTIRE community. This is a quality of life issue for everyone!

Address	Comment
1515 Hagge Ave	we have a split level - our lower level is only about 4' below grade
1516 Mansfield Rd	husband says no - it was rain, lack of gutters, not ground water
1516 Stagecoach Rd	Installed sump pump, but it has never run. Never have had water in the sump
1516 Windsor Rd	constructed a sump pump pit. Observe water levels pump when needed
1518 Hagge Ave	problems in 1967 flood - 1 inch. Never seem to have problems
1519 Stagecoach Rd	do not have basement in this area
1520 Windsor Rd	our home is a split level - we do not have a full basement, only garden level
1521 W Stolley Park Rd	our basement is dry - people shouldn't build a house with a basement if groundwater is a problem - buy some dirt & fill it in.
1522 Mansfield Rd	the only time we had problems was with the big rain in May of 2005
1522 Parkview Dr	don't know if problems in the past - just moved here March 2006. The former resident from whom we bought had no problem either since flood control measures were implemented.
1522 Stagecoach Rd	I really don't know, because I just bought the house, but talking with neighbors they said that no problem arised since they moved in.
1524 Coventry Ln Apt 20	this is for normandy apts we have 24 units all are dry
1524 Coventry Ln Apt 22	we rent, so I don't know if there were problems prior to 1/07. we have't had any problems since then.
1524 Coventry Ln Apt 54	lived here 5 yrs. Not sure about it before we moved here
1524 Coventry Ln Apt 64	I live in an apartment complex
1524 Coventry Ln Apt 84	I rent a basement apt & had no water problems
1528 Allen Ave	I'm getting run off water that backs up onto our property & goes in through egress window.
1528 Mansfield Rd	we have a drainage system, basement floor pits & sump pumps. They have never activated
1529 Allen Ave	with hight groundwater 2 sump pumps could not keep basement dry
1529 Stagecoach Rd	not sure about the past - may have before I moved here in 1997 - have a sump pump
1603 Parkview Dr	built high enough per building code requirements to be out of 100 yr flood plain. Will Not support a dewatering district if created. Home already has pipes installed under the basement floor leading to a sump. This system has never been needed as water tables have not been high enough.
1603 W Stolley Park Rd	some seepage. Gorundwater has risen to within several inches of basement floor. When it rises I moniter it regularly.
1604 Parkview Dr	new home built about flood plain plus two sumbmersible sump pumps installed to drain any unusual high water
1605 Church Rd	1994 July- groundwater filled sump pit and was auto pumped to grade 2007 August - groundwater entered sump pit - no pumping
1607 Windsor Pl	Has a crawl space, but no water problems. Does have drainage problems - rain water from church floods his backyard.
1609 Roberta Ave	past problems are unknown - recently purchased home
1609 Stagecoach Rd	utility room have sump pump that keep floor dry.
1609 W Stolley Park Rd	can you send me the results of this survey
1610 S Blaine St	we have lived here 5 yrs & have never had water in the basement. We have spoken with a family that lived here in the late 70's & they never had problems either
1611 Stagecoach Rd	we have 2 sump pumps in our basement - one is still running
1612 Grand Ave	We have a sump pump area but have never had to use it. I believe the wood river project helped too.
1612 S Arthur St	8" below floor. Our dewatering system is comprised of 2 sump pumps. Extremely high groundwater will dampen the floor farthest from sumps even when they are pumping

Address	Comment
1613 Grand Ave	heavy rains this summer caused water to appear in sump pump pit. Sump pump kept it down. House was built with sump pump. A spec home we purchased in 1961. except for 1 foot of water during 1967 flood we haven't had problems. Except for the flood of 1967 a few times when we have had heavy rainfall we have had water in sump pump pit. Not in basement - not high enough for basement flooding - sump pump kept it contained in the pit.
1613 Spruce Rd	have no basement so no problems
1615 S Arthur St	Our sump pump has been able to handle groundwater problems
1615 S Blaine St	people shouldn't build homes where the water table is high
1616 Stagecoach Rd	We have a drainage system under basement floor & sump pump pit have not seen water in pit
1619 Zola Ct	no water even got on the floor! No problem as long as I keep the pump running when necessary. Why don't we get a stamped prepaid envelope?
1620 Coventry Ln	concerned about rising groundwater. Basement very damp this year & for the first time signs of mold. Water in basement 84, 94, 05, 07.
1629 Lariat Ln	we have a dewatering system or beaver system in our basement but in the past few years it has not run yet
1703 Curtis St	sometimes measure taken work. In the past we've only got an inch deep of water after prolonged periods of rain or after a rain even of 4 inches. Generally inly in spring this year we had to pump for the first time ever in the fall. We run 2 sump pumps when water is 6" below basement floor. This year it is still close to 6" below. Usually in the fall/summer there is n' even water in the pit that is 30" deep
1703 S Arthur St	I have not had groundwater problems this year but did after the 7" rain in 5/05
1704 Garland St	my problems have increased dramatically since the city has shut down wells south & west of GI. Maintaining drainage valves has also become an area of concern.
1704 Idlewood Ln	we have lived in what the old timers tell me is "polywog town"! We were here in the flood of 1967 & had 5 1/2 feet of ground water in the basement. Several other years we had an inch or 2 of ground water and several years of wet cracks in the floor. As long as the city keeps the detention cell by the church of christ along stolley park rd at a normal level we do not have water problems. As for the people in circle dr & on arthur st don't they have warm slough underneath them? Why not lower the level on the lake in brentwood and see if that would help their basement water levels? If it worked it would be less expensive way of control than what the city plans
1704 Roberta Ave	at one time we were on our own well & septic system - since hook-up to sewer, problems subsided. After on city water we continued on our own well for irrigation - no problems since
1704 S Blaine St	people with basement water problems should bear the extra dewatering expense because they bought these properties cheap for that reason. If dewatering is active their properties will be worth more when sold.
1705 Gretchen Ave	we have a drain system & a sewage pump that cycles every 5-10 seconds in the spring and every 15-25 seconds throughout the year. If it fails, we have water through the floor - this happened in the spring of this year.
1708 Grand Ave	had water only during 1967 flood. Water is within 18" of basement floor now.
1709 Columbia Cir	we don't want to pay to dewater other people's homes
1710 Garland St	we are having a dewatering system installed. So we do not know if it will take care of the problem until there is a problem.
1710 Hanover Ln	If the city can help find a solution to the high water talbe it would be much appreciated.
1711 Spring Rd	ground water was at the base of the basement floor. No problems since we bought the house in 1999. will be looking into mitigation this winter.
1712 Ando Ave	thrasher basements fixed - cost \$9490
1714 Coventry Ln	Since the upgrading of the Sucks Lake & park area it doesn't take much rain to cause the west end to go over the bank. Also east end of cell retains more water.
1714 Freedom Dr	only time I get water is when it rains hard and a lot
1715 Mansfield Rd	live in newer division of town. We are built higher than existing divisions.
1715-1717 Curtis St	1/2 basement. Problem only once about 1982. have a sump pump. When home was being built it was determined there would be a water problem so only built with 1/2 depth.
1715-1717 Curtis St	1/2 basement. Problem only once about 1982. have a sump pump. When home was being built it was determined there would be a water problem so only built with 1/2 depth.

Address	Comment
1717 Allen Ct	I was told there was water in the basement in the early 90's. But has been dry since.
1717 Bridle Ln	we put in a sump pump but on the past it didn't keep the water out
1718 Ingalls St	we would have little or no problem in our neighborhood if we did not have the detention cell on Stolley Park Rd
1720 Gretchen Ave	with no rain it's better - when it rains the problem returns. Thank you for the survey. If one could look back, no basement built over the slough!!
1720 Lariat Ln	only lived here for 1 1/2 yrs
1721 Idlewood Ln	have homeowners run sand point wells to water lawns - if enough people are allowed to pump the water table will go down
1725 Ingalls St	split level 4 or 5 foot below ground level. Our lower level is about 4-5 foot below ground level. We have had no problems recently with seepage. Half block north on Lamar all kinds of problems with basements,
1727 S Arthur St	don't currently have water, but we have to pull up carpet & put furniture on blocks constantly in case. We have had water 2 times in the last 14 yrs & came close many times. We don't currently have water but we have to worry everytime we get more than an inch of rain. We don't understand why the city pumps in our area are not on regularly.
1730 Gretchen Ave	water came through basement floor during flood of 1967 - none since
1730 S Arthur St	there is now ay to keep it out, so we don't use our basement except for storage on plat forms. Years ago we had carpeting & a nice finish for a family room but the wtaer would come back in every few years - about 1/2" - 5"
1733 S Arthur St	still needs help
1736 S Arthur St	still have high water - we pump - but doesn't always lower water enough
1739 S Arthur St	measures have partially worked - attached letter sent to Groundwater committee
1742 Curtis St	I feel as long as the water table continues to be high I will have wet mud, mold and unhealthy conditions in my crawl space. Please help alleviate this problem.
1742 S Arthur St	never this bad - we have lived here 17 1/2 yrs. 2 systems in our basement. Measures have worked somewhat - we have been able to keep up the last 2 1/2 yrs. Please help! We can pump 60k gallons/day with our 2 systems & it's not enough. We still have water at or above floor level.
1748 S Arthur St	intrusion creates unlivable space. City should consider impact on property valuations. Recently purchased 2/06. one city recommendation to fill in basement is NOT acceptable. Previous owners indicated surface water intrusion in 2005. private contractor dewatering systems quoted at approximately \$13k.
1760 S Arthur St	I have had water in my basement 3 different times this summer alone. Frustrating & taxes keep going up
1802 Stolley Park Cir	small pit w/ furnance & water softner
1803 Garland St	lived here since 1978 middle of block east side never had problem house built in 1964
1803 S Arthur St	1/2 basement
1803 Stagecoach Rd	we pumped water most of the summer
1804 1808 S Eddy St	no problems
1804 S Blaine St	problems during flood of 1967
1805 Stagecoach Rd	measure were already in place when we moved in. No problem since 1993 & since diversion channel is in
1807 Stagecoach Rd	I have a sump pump
1809 Ingalls St	not willing to pay any amount to correct somebody else's headache
1809 Spring Rd	never have had a groundwater problem
1810 S Garland St	we have people pumping with in 4 houses of ours
1810 Spring Rd	Sump Pump runs constantly - never happened last 20 years since owned home.
1812 Idlewood Ln	no groundwater intrusion in 21 years we have lived here at this address

Address	Comment
1813 S Arthur St	problems in 1967 flood. This year has been the highest groundwater level since we have lived here (1970). It has been from 1 1/2 - 3' below basement level all year
1814 Freedom Dr	have a sump pump in basement
1816 Stolley Park Cir	Our sump pump system ran for a small number of times this summer, and our sump still has water.
1818 Garland St	very minor history last year. New gutters - partial help. Had 2 incidents this year. 1st was when gutters were off & had 5" rain. This resulted in minor flooding. 2nd was seepage in basement floor - very minor.
1818 S Blaine St	we only had water in our basement during the '67 flood. The water table did get fairly high this summer but remained below the basement floor
1818 S Ingalls St	split level
1820 S Arthur St	our street has problems but our home is at least a foot higher than everyone else due to a wise builder
1824 Garland St	no such intrusion has occurred at this address since Oct '04. no problem with groundwater to date
1905 Stolley Park Cir	I have a sump pump
1905 W Oklahoma Ave	no basement - no problems.
1910 Spring Rd	thrasher basement is scheduled to fix my basement on 11/27/07. we'll see if it works then. It will cost me \$11,800. I would not have bought this house if I had know of this problem
1911 Stolley Park Cir	have a sump pump - I have only lived here since 2005
1912 Stolley Park Cir	in my opinion steps need to be taken to reduce ground water since 1-2 yrs future wet spring/summers will force some homeowners to be pumping out water 12 mos. per year
1913 W Oklahoma Ave	we are about that low lying area south of us
1914 Spring Rd	on September '07 we called a specialist from Thrasher Co. to fix our groundwater problem. We spent about \$21k
1917 Stolley Park Cir	in areas where homes are being built (where there is even a SLIGHT chance) of groundwater becoming a problem - either no basements, or basements with a depth limit!
1920 Barbara Ave	we had groundwater in our crawl space briefly during the 2005 flooding caused by the 9" rain
1923 Lamar Ave	basement is reinforced concrete w/ copper dam between floor & walls
1934 Freedom Dr	only owned home 2 yrs. Gutters need installed on home with dirt work also. Need to improve washout.
2009 Stagecoach Rd	small amount of water about 15 yrs ago - not enough to require corrective action
2010 Pioneer Blvd	we are pumping constantly. Pollution is a shameful thing. The groundwater damage was extensive and very expensive. I lost my family room & bedroom wall board, carpets & furniture all gone. Better planning by officials needed. We never had ground water problems at this address before. This disaster has lowered the value of my home! Added to the expense of maintaining it! Stress has taken it's toll on me.
2011 Stagecoach Rd	was told the way basement was formed and poured that no sump should be installed
2014 Barbara Ave	I don't have water problems now, only when we have 6-10 inches at one time It gets in my crawl space, but drains quickly
2017 S Adams St	problems in 1960's
2018 Pioneer Blvd	seepage in cracks & mold growth still occurs
2019 Park Dr	We are on "Park Drive" and we want city water- Please!! All the way around us. Not on Park Dr!
2019 Pioneer Blvd	if you have a basement it's your problem not city's - you built it you live in it.
2024 W Stolley Park Rd	sump pump
204 Beachwood Dr	I don't support tax payer funds being used to mitigate groundwater problems for individuals
205 Villa Mar Dee Ave	we installed a 2nd pump 3 yrs ago. This year we had a small amount of water on the floor. Once we finally got the city to turn on the NRD pump the water lowered enough for our pumps to keep up.
206 Brookline Dr	I have well pits at present there is 1 foot of water. I keep sumps. At present it's no problem.
206 Wainright St	had problems in crawl space

Address	Comment
2101 Stagecoach Rd	problems in 1993. have a sump pump to outside yard. 2007 water in sump pit 6" below floor- haven't turned sump pump on since 1993.
2104 Mansfield Rd	unknown if mitigations work
2106 Circle Dr	sump pumps will only work partially. Cannot keep entire floor dry
2109 Topeka Cir	basement problems are personal, not city
2111 Bantam St	we have only been here since 6/15/07
2111 Sherwood Rd	had ground water 3 times before putting in gravel beaver system. Water table has been lower so can't say for sure if system will be 100% effective.
2115 Independence Ave	jim reed ran a french drain in NE corner to drain water that collects after a 2" rain. I had Herman Plumbing install a sump pump on 4/22/98 and ran a pipe outside to keep water out. Worked. That was only time.
2115 Pioneer Blvd	this house was originally a basement house, therefore it was built higher to accommodate the windows, before the main house was built on top - 15 yrs later.
2117 Macron St	we have installed 7 french drains along back lot line after 1" of rain still takes 4 hrs for water to go away
2121 Atlanta St	our problems are contained to backyard drainage issues after rainfall. We are told that poor grading of land & the clay layer are the underlying causes.
2122 Circle Dr	I wouldn't want to spend \$44 a month to fix groundwater problems
2122 Mansfield Rd	I don't feel I should be taxed for someone else's problem. People should read disclosure of house or use honest realtor
2122 Nashville St	no problems. We have a submersible pump in a pit and has always been dry
2125 Sherwood Rd	we bought this house in 5/06 we have yet to have problems with water in our basement. We do have a sump pump. The house is 30 yrs old - I don't know if there were past problems
2127 Viking Rd	Survey should be on-line
213 Voss Rd	measures worked most of the time 'til this year. Would like info on detention cells on Seedling Mile access road. Please call.
2130 Viking Pl	our house sits on a small rise. That has prevented any ground water intrusion in the 15 yrs of our ownership - including 1993.
2131 Riverside Dr	tri level house w/ a lower level
2132 Viking Pl	It's been 7 or 8 years ago since water table was threatening and about 4 yrs ago City of GI put down a 4 or 6' dewatering well about 1000' west of our house. No problems now.
215 W South St	we had intrusion of water in 1967 during the flood and twice during the extra wet early to mid 1990's, also twice this year. We have sump pumps and a well and it couldn't pump it out fast enough. We'll need city wells pumping again.
216 Beachwood Dr	had water in the basement about 13 years ago when the groundwater was very high. Have had no problems since.
218 N Wetzel St	measures have worked to some degree. When the water table is high, I still get water in my basement.
220 Oxnard Ave	basement floor originally 2' below original grade. Raised grade for flood plain exclusion.
2202 Pioneer Blvd	the city used to pump the well east of us. Pumped it out.
2203 Atlanta St	don't know about past problems - just purchased the house in March 2007. there is a sump pump in the basement. Nothing has happened since we purchased the house.
2203 Bantam St	problems prior to the wood river diversion
2203 Park Dr	had water problems June 1967 @ 427 E Sunset. Next door neighbor @ 2115 Park Dr and 2207 Park Dr had basement water, measure in a few inches
2203 S August St	not in favor of water district
2203 Woodridge Ln	Have lived here 26 years - no problems at all - sent letter
2204 Macron St	basements that have water problems need to be raised or filled in. You can't pump water from one side of a sand pit and into the other and gain anything - it's that simple

Address	Comment
2204 S August St	I bought the house 6 yrs ago. There is a sump pump. However, to date I have had no water.
2204 Woodridge Ct	however we live by the cemetery which is one of the highest points in SW GI.
2207 Park Dr	very bad in 1967 at least 3 inches this year. Had to remove everything from the basement at this time.
2207 Pioneer Blvd	I believe the people having the problem are the ones that the city put water lines in front of their homes.
2207 Woodridge Pl	not in favor of major dewatering wddoer in SW GI - thanks for all the great work the city does.
2208 Chanticleer St	Outside basement walls should be coated with polyurithane, then tar, then plastic, and then about 2 feet of gravel. The downspout from the gutter should empty into a splash block that carries water 3-4 feet from house.
2209 Arrowhead Rd	basement room utility only. Do have a pit and did put the sump pump in once - probably 12 years ago. Pumped for a short time.
2210 Circle Dr	I'm only renting & have only been here since the middle of September
2211 Lamar Ave	measure worked somewhat in the crawl space we have. I have to run a dehumidifier regularly. I am considering sealing the space. Thrasher gave me a \$5k estimate
2211 Park Dr	this is the first time in 20 years
2211 Riverside Dr	our basement floor is 18-24" higher than neighbors. The only intrusion we had happened when one main sump failed & the other secondary sump pump filled the mail pit and overran to partially cover our floor
2213 S August St	we do not feel that a large scale city developed water mitigation system is the answer
2215 Del Mar Ave	no basement - no water in basement
2215 Macron St	no problem - has been dry since purchasing the home in '01
2215 N Engleman Rd	it has been at least 16 yrs since we have had any water. I have a pit 5' deep below the floor and has been dry for a long time. No more taxes!
2215 Stagecoach Rd	not really water in basement but ran sump pumps quite often during summer
2216 Circle Dr	I rent from D & D Investments & they have done nothing!
2216 Circle Dr	I rent from D & D Investments & they have done nothing!
2219 Riverview Dr	we have only lived here for 18 mos
2221 Macron St	we have a sump pump but it has never had to be used.
2222 Bellwood Dr Apt 46	I live in an apartment building on the 3rd floor. If it gets to me I have a real problem!
2223 S August St	when sprinkler system well was serviced this past summer, serviceman indicated water level was at 7 ft.
2224 Woodridge Ln	have a beaver system in basement when house was built. Did a hole & water was 18" below ground surface. Beaver system does drain excess water.
2226 Viking Rd	we've lived here 5 yrs - no water yet - thank god. We do have 2 pumps in the basement
223 N Shady Bend Rd	I only have a crawl space. When we have lots of rain & flooding in GI it does get wet & muddy from seepage.
2249 Cochin St	when my father built the house he knew about & understood ground water issues. He built accordingly. 1967 only had small sewer back up less than 2". Your survey process should have taken into account of us who have auto pay
2302 Gateway Ave	split level home - have owned 11 1/2 yrs. Neighbors say previous owners have had groundwater problems
2303 N Engleman Rd	Have had 5' of water a few years ago. All was ground water.
2305 Stardust Ln	the former owners installed a drainage system but it hasn't been wet enough in the 4 yrs we have lived here for water to collect in pits
2306 Apache Rd	I would support any efforts to reduce ground water
2307 Stagecoach Rd	when we built our home approx. 20 yrs ago we brought in dirt & elevated our basement so we could have windows down there.
2309 Stardust Ln	it is a split level so basement isn't very deep but there has never been a problem

Address	Comment
2309 W Phoenix Ave	we have a dry basement. We have lived here 37 years. We do not have, nor do we need a sump pump. We use our basement mostly for storage now & if we had water problems, we couldn't do that.
2311 S Locust St	with GI ground water problem it would be best if GI had an anti-basement ordinance.
2311 Viking Ct	split level home - our home is split level - no water problems to date.
2315 S August St	we recently moved into the home and the previous owner was an investor that didn't live in the home. He said he didn't know if water had been a problem. There is a sump pump. Also, the basement had been redone by the investor prior to our purchasing the home
2315 W Phoenix Ave	last time we had water in the basement it was when the city was working on sewer- backup in the basement drain & plumbing fixtures
2316 Pioneer Blvd	our basement is not a deep basement. The house was built on ground level & dirt brought in
2318 Stagecoach Rd	We only have trouble when the Wood River flooded into Riverside Golf Course. No problem since diversion procedure was completed.
2318 Stardust Ln	we have lived here since 7/07
2319 Independence Ave	had problem 2 times after - small scale. Installed beaver system - cost of this & basement repair \$18k. Best thing that happened they got North Rd!!!!
2319 Stardust Ln	we haven't had a problem since extra pumping & more detention cells dug
2323 Bellwood Dr #127	None
2323 Bellwood Dr No. 114	I live in a mobile home so no basement.
2323 Bellwood Dr No. 172	None
2323 Bellwood Dr No. 81	none
2323 Bellwood Dr No. 96	do not have a basement. I live in a mobile home court.
2324 S August St	I've lived here 10 yrs & have not had any water in basement. I hope it stays that way!
233 S Main St	we have 2 pumps just depends on how high the water table gets
2403 Pioneer Blvd	the building dept should never have let the developers build in the first place
2404 Gateway Ave	I have sump pumps but that is because of the ground water. I believe the city has installed wells around Engleman some place. I have had water coming even w/ 2 sump pumps running
2404 S August St	we have not had any water in the basement since we moved here 4 1/2 yrs ago.
2405 Lakewood Dr	have 3' crawl space
2405 Parkview Dr	Really not interested in any more taxes, surcharges or fees for some project to perhaps solve a couple of home owners water issues. - Storm Shelter floor elevation same as basement.
2407 W Oklahoma Ave	extended roof gutters away from house
2409 Del Monte Ave	yes, but only minimal damage in recent years we did have sewer backup from city's fault. We had to pay for damage, about \$2,000.
2409 S Blaine St	partial basement. Using a floor pump to remove water since April. Temporarily helps, but ongoing for several months. Never had a problem before. This water problem is the result of city of GI's decision to turn off all city wells in this area - no water at present time.
2409 Santa Fe Cir	I have a drainage system in my basement but have not needed to use it. The groundwater has risen approx 7' since I built in 1991 when we dug utilities
2410 Gateway Ave	moved in house in 6/07. do not know history or last time water was an issue. But evidence of past water is evident.
2410 Pioneer Blvd	I have groundwater at times in my well pit. I use a 1/6 HP pump to spot water lawn.
2410 Santa Fe Cir	I believe that individuals should be responsible for their own basement water problems
2411 Lakewood Dr	have approx. 2 1/2 feet deep crawl space. Crawl space is dry. Have resided here 3 yrs this Jan 2nd within 1st 6 mos. had 2" standing. Today is 1st time I've looked - been in basement since)
2411 S Blaine St	this is an abominable situation that none of you seem to care about. What would you be doing if it was YOUR basement??

Address	Comment
2411 Stagecoach Rd	I live beside a city detention cell when it gets so full my pump in the basement runs, they city has a pump in it that can keep it down
2412 Cochran St	no water problems since the wood river project
2414 Brahma St	tri level home - day lite basement
2414 Pioneer Blvd	never had a problem. Wasn't the wood river project suppose to eliminate any problems? What happened?
2415 Lamar Ave	sealed all cracks used sealer on all walls & floors
2415 S August St	I have a crawl space under my house
2415 Sothman Dr	have no water problems!
2416 Cochran St	my house is a split level - 1/2 basement never had any water. I'll move out of GI before I'll pay any additional tax to dewater basements. Lived in north platte for 20 yrs. Built home with crawl space. City code: no basements on account of ground water.
2416 Sothman Dr	problems are small compared to some. The solution to our groundwater problem would be to turn the city pumps on. I understand we can't do this due to contamination of the wells. Has the city sought reimbursement from the industry that put the pollutants in our groundwater??
2417 Arrowhead Rd	crawl space - no basement
2417 Lakewood Dr	we have a beaver system that eliminates any intrusion. When the lake is up it does run....or with 4 inches of rain.
2420 Del Mar Ave	Our sand pit use to keep the water under control to a point. Since dredging lake on Harrison St & not using City wells around the City - basement worthless either water or mold or both.
2421 Commerce Ave	my basement is only 4' deep - below ground
2422 Pioneer Blvd	We do not need a dewatering system in our area. It would mean a waste of money.
2422 Riverview Dr	no water problems
2424 Commerce Ave	storm protection - this home has a dry cemented crawl space - 4 1/2 ft deep
2424 Commerce Ave	storm protection - this home has a dry cemented crawl space - 4 1/2 ft deep
2424 Pioneer Blvd	I have an irrigation well down 33 feet. Water is 9 feet - when wet spots appeared in the cracks on basement floor I ran the pump 8 hours a day for a week
2424 W Phoenix Ave	may 2005 was our last problem and we were able to clear it out
2425 Pioneer Blvd	floor is dry but sump runs every 40 seconds. We have lived here 10 yrs - measures have worked somewhat - sent letter
2426 Lamar Ave	measures work sometimes. Set up districts and assess the benefiting property owners for the costs. I would be willing to pay \$40-\$60 per month to correct the problem.
2426 Pioneer Blvd	Not as long as we've lived here - our water has been close & we had a plumber install pumps that run & keep the water down. The plumber says it is right under the basement floor.
2427 Commerce Ave	had groundwater in basement during 1967 flood
2429 Commerce Ave	we have a 5' crawl space. Crawl space is molding because of water table being very high. No sitting water, but ground is wet. For me this survey is hard to answer because I don't have a basement. However I have a deep crawl space that the ground is wet & is causing mold to grow all over. When I walk into my house after being gone my house smells like mold & mildew; which is unhealthy. I have bad water to drink & a mold issue.
2429 Park Dr	we used a submersible water pump
2430 Pioneer Blvd	the city should not give a building permit for a basement. Home owners should pay for their own repairs - I do.
2431 Del Monte Ave	I have the B dry system. It has been helpful, but I did have water in the basement during the May '95 flood
2434 Lamar Ave	we have a sump pump but doesn't help if level gets high enough. We live on hike/bike trail the pump on it does seem to help some
2448 Lamar Ave	May '05 we had water coming into our window wells, up thru the basement drains and finally the groundwater! The test well behind helped this year we think.

Address	Comment
2502 N Webb Rd	commercial building - no basement
2502 N Webb Rd Ste A	commercial building - no basement
2502 N Webb Rd Ste B	commercial building - no basement
2503 Commerce Ave	moved here in '07- don't know about any past problems. Would like to have the problems fixed. It's terrible having standing water in the basement - health problems
2503 Parkview Dr	no problems - have a sump pump pit not ever had water in it - check often.
2505 Mill River Rd	we came very close to having water in our basement. Our sump pump worked this time.
2505 W Oklahoma Ave	when we bought the house 8 yrs ago they had told us that it had water at one time.
2507 Park Dr	we had groundwater & septic backup after the heavy rains in August. It took 2 weeks for water to stop coming in
2507 Pioneer Blvd	only had a problem in 1967. I measure how far down the ground water is. Didn't have any this year - close, but none. When my husband was alive he would measure & when it was getting high he would call the city to turn on the city well near us. When they did the water level went down immediately.
2507 Sothman Dr	None
2508 Commerce Ave	we built our own house & know about water levels. People should not have had basements or not put them in so deep I feel I shouldn't have to pay for other people's mistakes.
2508 Stagecoach Rd	Spending \$23 million & \$350k a year on a dewatering plan is CRAZY!!
2508 W Phoenix Ave	I have lived in this house for 10 yrs. I have had water a few times - one time my gutters were not cleaned so water came in window. I do not believe dewatering is the answer to this problem. I can live with mine. I believe building new homes in this area should be stopped or put up with the problems at their own expense. The water was there before any of these homes were built. This is a very expensive project plus water is a precious product and should not be wasted by dewatering.
2509 Commerce Ave	in Aug we had 3" of water in our basement for the 1st time since we built our house 5 yrs ago. We put in a sump pump which runs a lot, but is doing the job keeping our basement dry.
2509 Cottonwood Rd	4' crawl area only
2509 Pioneer Blvd	water started running in on 4/27/07. have had problems late winter, spring, summer, fall, not at present. Contracted to purchase thresher basement system - very costly. We will have a basement dewatering system installed. Scheduled for 12/5/07
2509 S Blaine St	have dehumidifiers & fans. We didn't get much water but it is the 1st time in over 20 yrs we've had any water in our basement
2509 W Phoenix Ave	city put well along bike trail - no problems
2510 Brahma St	I have lived in two houses (Bismark Rd & Memorial Dr) that had basements. Because of water problems I won't live in a house with a basement.
2511 Park Dr	we have had this home since 1976. we do not have a finished basement, but we have water tanks in a small shelter under our bedroom & we have had water since April.
2511 W Phoenix Ave	the sewer backedup during the big storm. And it became my problem! We lost our whole basement & the city did nothing.
2512 Commerce Ave	Filling in basement - has put in a beaver system & 3 sump pumps are running - water level hasn't changed.
2513 Commerce Ave	dry around foundation & coated w/ water proofing. Can't say if measure have worked- no water at this point. Our house was built in 1951. we have lived here since 1995. no evidence of water from previous flooding. Previous owner never mentioned problems
2514 Pioneer Blvd	crawl space - GI needs to do something about the well situation
2515 Park Dr	this spring was the first time we have had a water problem in our basement
2515 Riverview Dr	sump - never had to use it
2515 W Phoenix Ave	former owners had raised basement floors. Have not had problems until 2 yrs ago when we had 7-8 inch rainfall then had water seep into basement. When dewatering well turned on water table went down. I suppose it would take the city as long to fix the problem as it has to take care of the water pollution. How many gallons has been cleaned so far after all these years.
2516 Apache Rd	crawl space - one in awhile have water in crawl space if we get a heavy rain

Address	Comment
2516 Commerce Ave	we've had to have city water put in so we could have safe drinking water
2516 Parkview Dr	GI/ Hall County does not seem to have an effective long term storm drainage plan
2516 Pioneer Blvd	yes we have water in basement now. The last time we had water was 4 years ago. City turned on well west & north of us, then to help & it did
2516 W Phoenix Ave	mitigations usually work
2517 Apache Rd	we had to install a sump pump in our storm shelter
2517 Mill River Rd	split level home
2517 Park Dr	measures are in planning stage
2517 Riverside Dr	we had water one time 8-9 yrs ago
2517 S August St	this correction was made in spring/summer 1996
2517 W Phoenix Ave	there is a dewatering well behind my house on the hike/bike trail that takes care of any water problems when it is started
2519 Cochran St	in early 90's heavy spring rain caused oozing in basement for a few hours. No problems since
2519 Commerce Ave	I think the only reason we had water is because Starostka dug big holes in front of our house and left them for 2 weeks while we had several inches of rain. I have never had water before or since.
2519 Park Dr	when contractors know it is a flood plain the city should not have given permission for basements!!!! They wouldn't have problems now.
2520 Cochran St	No basement - no water
2521 Park Dr	people who have no basement shouldn't have to pay for this problem. We basically live in a river bottom and can't expect not to have high groundwater
2522 Commerce Ave	past problems were April - October '07. I have lived here since 1970. this is the only time I've had water. I think it's because of shutting off the well on Blaine St. Why don't you use the Blaine Street well & pipe it to the generating plant & proposed ethanol plant for industrial use. I understand the ethanol plant recycles 80% of it's water usage. Like I said before I have not had any water problems in the almost 38 yrs I've lived here. We have no storm sewer to pump any water - what are we to do????
2522 Stagecoach Rd	split level home with moisture rising up in the crawl space & finished areas. Installed dehumidifier & replace gutters w/ larger size
2524 Stagecoach Rd	we have a garden level basement
2525 Del Monte Ave	occasionally have a problem - measures work up to a certain point
2525 Mill River Rd	please turn the pump on to the holding cell on Stagecoach Rd & leave it on. It's still full of water because I pump 1k gallons + a day to it.
2527 Stagecoach Rd	measures usually work. I have installed a sump pump. It usually takes care of the problem but this spring it did not. My sump pump continues to work 24/7!!!!
2528 Stagecoach Rd	we have 2 sumps they ran from June to September. Not running now, still low water in sump holes
2529 Mill River Rd	we had water at it's high point up to a level about 1 - 2 inches below the bottom of the basement concrete floor slab. It never soaked into the concrete.
2530 Stagecoach Rd	sump pump pit is 1/2 full & water was only 3" below top level of pit this summer. Beginning in 1983 & several times since then even after wood river flood project - sometimes measures taken work, but often not - sump pumps couldn't keep up. Snt Ltr
2531 W Phoenix Ave	sometimes measures taken work
2603 O Flannagan St	I don't think the city is responsible for people who have water in their basements
2606 Jan St	measures haven't been put to the test
2607 O Flannagan St	haven't needed measures that were taken. House has sump pump under basement but I haven't used it
2607 Riverside Dr	most people don't know what to do. a landscaper has tried 2x at a high cost to me. i am a single woman trying to make it on my own. the 1st yr here '02 no problems. now I get water under & around egress window as well as the concrete blocks getting damp. I run a de-humidifier constantly & put down towels when it rains. I don't know what to do.

Address	Comment
2608 Cochran St	Buyer Beware
2608 LaMar Ave	we have minimal leakage. As long as the next door neighbors keep their sump pump going we are usually ok. We are just slightly higher than they are
2611 August St	I have lived here only 3 mos. but I moved from Gretchen Ave, where we had 3' of groundwater in the flood of 1967.
2616 Arrowhead Rd	we have a crawl space - only approx. 4' tall
2616 Chanticleer St Apt A	Due to the construction of this townhome (2 story w/ no basement) they will not have groundwater issues.
2616 Lamar Ave	water everytime in spring
2617 Arrowhead Rd	6' feet in ground - water in outdoor gravel bottom - storm shelter 2-3 times in 30 yrs.
2617 Lakewood Dr	problems once in 25 yrs
2617 S August St	None
2618 Jan St	problems once in 1983
2620 Oflanagan St	some water in basement may 2007 after 9" rain
2620 S Blaine St	we had our basement filled in. We then had an addition added on to the house to make up for the lost basement
2628 O Flannagan St	Our main problem is sanitary sewer backup from flood waters getting into sanitary sewer & not adequate pipe size of lift station
2632 N North Rd	had water in basement once for about 10 days several years back
2636 Carleton Ave Apt 1	I rent my apt. from Oconnor Enterprises
2636 Jay St	home is 14 yrs old, foundation tilted with sump pump. The sump has always been dry we've never had to pump
2648 N Webb Rd	only measure was to apply waterproof coating near top of wall
2670 St Patrick Ave	we have had water within 10' of our house with seepage in our 4' crawl space
2680 St Patrick Ave	we have a beaver system - never had to use it
2703 Riverside Dr	at the time of the flood we had about 2' of water in the crawl space. Since then it's completely dry - we service the septic tank yearly - no evidence of water.
2706 Brentwood Blvd	patrial for furnace & air conditioner and storm shelter. There is a sump pump. We have only owned this home since 6/1/06
2706 Lamar Ave	when the detention cell west of us is overflowing the water table is so high our basement floods - pumps can't keep up
2706 Wagon Rd	no problems before this summer, expect measures to work but won't know until next spring. The city's decision to shut down city wells w/out compensating for the impact to the water levels was quite damaging to the area.
2707 W Stolley Park Rd	we have lived in this house for 3 yrs & have had water problems since the heavy rains in May of '05. The basement shows water damage from past years. Approx. 18" from the floor
2707 W Stolley Park Rd	we have lived in this house for 3 yrs & have had water problems since the heavy rains in May of '05. The basement shows water damage from past years. Approx. 18" from the floor
2708 Arrowhead Rd	storm shelter below first floor. Sump pump installed no history of water. Also 4' crawl space under entire home - no history of water
2709 Riverview Dr	we have a sump pump but have never had to use it, and the sump well is okay
2710 Parkview Dr	we installed a beaver system when we built in 1995, but never had to use it
2711 Lakewood Dr	have not had to use the sump pump drain system since I built the house in 1995
2711 Riverside Dr	no basement - have crawl space - no water problems
2712 O Flannagan St	had sewer backup in '05 or '06 when all the area flooded

Address	Comment
2713 Stewart Dr	have 2 pumps what a mess when the ground water comes up family room, storage, son's bedroom, & computer room all get wet & smell
2715 O Flannagan St	we just bought this house in May 2007. we don't know if there has been any previous problems
2715 S Wagon Rd	we have never had ground water in our basement so mitigate? We purchased this house in 1985 & have never had water in the basement.
2716 Sunny Brooke Rd	None
2717 Brentwood Blvd	other homes around us have some groundwater problems, but luckily our home is built up
2717 Sunny Brooke Rd	I rent this duplex - there is a partial basement but I can't get to it. Mrs. Kay Grimminger owns these
2720 Sunny Brooke Rd	crawl space. Don't know of any problems only lived here 6 mos.
2721 W Stolley Park Rd	basement is 3' deep. My husband & I are vehemently AGAINST a dewatering plan! It's too expensive! Let the farmers drill new wells
2722 Sunny Brooke Rd	have heard some neighbors complain about water in basements. Sometimes rains water stands in little creek close by Stewart & Sunny Brooke Rd on Circle Dr - off of Stolley Park RD
2727 W Us Hwy 34	Grand Island is built on the Platte River. This should be an online survey. Offer \$60k to affected homeowners to fill in basement/add on - will be cheaper in the long run.
2729 Brentwood Blvd	people didn't build high enough - otherwise most in my neighborhood have no problems. Good luck
2735 Lakewood Dr	during our new construction we raised our ground level of the house. We have a sump pit in basement and in 15 yrs it has never been wet.
2736 Brentwood Blvd	I have a beaver system in the basement floor - never needed to be pumped
2739 St Patrick Ave	crawl space 4 1/2 foot - not aware of any problems
2740 O Flannagan St	only on big rains - 7" on
2742 N Webb Rd	we have a crawl space under our house - no problems
2763 Oflannagan St	I'm in the flood plain and pay a lot of insurance, taxes are high and GI should take measures in getting all of GI out of the flood plain
2771 St Patrick Ave	our house is built above the flood plain.
2772 O Flannagan St	the problem we have is when the water drains out of the state ditch into storm sewer & floods the street
2802 Lamar Ave	rent duplex from Lamar Enterprises (Omaha) Jim Rector owner. Have no idea on last 2 questions.
2804 Brentwood Blvd	we haven't had groundwater intrusion for a number of years since the wood river was channeled
2805 Circle Dr	I still have water on floor in my basement. My sump pump is running steadily. I have had water since April. If my pump quits the sump will overflow bad.
2805 Stagecoach Cir	mitigation installed 1985. controlled groundwater until 2007. in the 28 years we lived in this house we have not pumped/had groundwater past June. Pur pump still runs several times daily to date in 2007.
2807 N Engleman Rd	built house high enough to avoid
2807 N Engleman Rd	built house high enough to avoid
2807 Stagecoach Cir	the basement flooded the year before we moved into the house 1994. use sump pump to keep it down others in near by house have also done the same
2808 Lakewood Cir	we have a sump pump and a drainage pipe around the outside of our basement. We have only lived here 4 mos. but the town house is about 10 yrs old & no problems so far.
2808 Northwest Ave	basement is 4' in ground
2808 Stagecoach Cir	I have a large concern about the continuous pumping of my neighbor. My concern is related to this pumping in th winter and the effect that this winter will have on the street as the water begins to freeze. I understand the need to pump water to keep her basement dry but I fear a great build up of ice near my house. Has the city made any plans to address this ice issue across the city? This may become a larger issue in the future.
2809 W Stolley Park Rd	not sure on other questions. We rent & there is a sump pump down there. Never really had much of any water get in.

Address	Comment
2811 Circle Dr	now plagued with mold & medical bills. Have had water since 4/07 - still have 5 1/2 inches with 3 pumps running. About \$300 electric bills in summer
2812 Pioneer Blvd	we have a beaver system under our basement
2813 Lakewood Cir	drain tiles & pit were built with condo
2815 Dallas Ave	we put in a sand pump (point) and punched 2 holes in basement floor to syphon water to a temporary sump pump
2815 Stagecoach Pl	previous owner installed a sump pump. I ran it only once since 1994. it filled up after heavy rains this summer
2816 Brentwood Blvd	Molle system in place - 2 sump pumps
2816 Lakewood Cir	just moved into this house 2 wks ago. Don't think there were past problems, not sure.
2817 Northwest Ave	all water drains from street & neighbors houses right into my yard. I must do \$5k of landscaping to fix it.
2817-21 Circle Dr	sand point installed 1998 - in both sides of duplex. Lived here 9 yrs. Has some water couple of years, just leakage. 2007 has been pretty bad w/ both basements having 1-3 inches of water 3 times during the year.
2820 Brentwood Blvd	I've only lived here 8 mos. I pumped water for 6 weeks. Everyone in this condo area has water problems
2820 Lakewood Cir	no problem
2824 Fort Worth Ct	surface measure taken
2825 Lakewood Cir	Oakwood condos were built with systems under basement floors - water has never entered system. We have never had water in our basement system. Our builder didn't put our basement as deep as others in the area.
2826 Brenwood Blvd	nover had any water problems
2827 Brentwood Blvd	we live in a condo - our common wall neighbor has a beaver system. Groundwater is not too far from our basement floor - I'm guessing a foot to a foot and a half - so far so good.
2827 Cross Pointe Dr	these O'Connor one story duplexes have tornado shelters in ground. 2827 Cross Ponte where we live is dry at present but we have had wet walls & floor.
2827 Dallas Ave	the city of grand island should not dewater any area having ground water problems. Individuals should be responsible for their own problems
2828 Lakewood Cir	We had issues with groundwater when living in our previous home at 4227 Utah Ave, but none while in our present home.
2830 Northwest Ave	sump pump in basement
2905 Circle Dr	we own & have lived in our duplex at 2905-2911 Circle Dr for 30 yrs. Over the years we have experienced some seepage in both units. This past spring and summer was the longest stretch of time that we had it occuring off and on. We were able to keep it at bay by using a dehumidifier.
2906 Idaho Ave	storm cellar 9x9. we have a sump pump in our small cellar. We've lived here 10 yrs. When we lived at 2748 Oflannagan we had a terrible problem of basement flooding. If you're interested please call
2906 Lamar Ave	have crawl space. This is a rental that belongs to Rector Families LLC
2907 Independence Ave	Water problems were due to plugged gutter - no further problems once gutter was cleaned. Basement is only 4 ft below ground level
2909 Circle Dr	we raised our house in 1973 four feet to get out of the water.
2917 N Webb Rd	measures have worked so far! Put in a dewatering system in 1996 - drought conditions helped keep water level down until the City let developers put a lake in across the road. Now ground water is continually chased.
2922 & 2924 Circle Dr	I did not appreciate my land & business being devalued by sloppy reporting. Owner & landlord since '77. never had water. Please don't do us "dry" owners another disservice by grouping us all together as the Independent did.
2924 Circle Dr	I did not appreciate my land & business being devalued by sloppy reporting! Owner & LL since '77. nwever had water. Please do not do us "dry" owners another disservice by grouping us all together as the Independent did.
2924 Lamar Ave	sent letter
2929 N Webb Rd	sump pump keep swater level down to basement floor

Address	Comment
3002 Circle Dr	just moved here - it looks like there is some water damage in one room. Have a sump pump
3004 Brentwood Sq	our house is built up about 2 1/2 - 3 feet. Our crawl space is 6 cement blocks. Our neighbors (back door) Jim Roberg- Sothman Dr has pumped water from their basement
3007 Brentwood Blvd	haven't yet taken measures, but will need to
3007 Brentwood Ct	we have a sump pump & after heavy rains do get water in the pit. We have never had water flow into the basement but the water level has been close to the basement.
3007 Sothman Dr	If new cracks occur then we have more problems. Installed a Molley Beaver System in 1993
3009 W Stolley Park Rd Ap	I live on a 3rd floor apartment
3011 Brentwood Blvd	sump pump has not stopped running since 7/07. not sure how well measures are working
3011 Brentwood Pl	3 inches or more floods the park south of our house. Brentwood Pl drains west instead of east to the ditch causing most of the flooding.
3012 Brentwood Pl	minimal problems in the past
3013 W Stolley Park Rd Ap	people build new houses around sand pits, near lakes & rivers & know that the problems exist or can occur. The public should not have to pay for the homeowner's or builder's disregard for common sense.
3016 Brentwood Ct	when the sump pump needed repaired we had groundwater problems. The people that lived in this home before I did had problems & had a sump pump put in
3017 W Stolley Park Rd Ap	apartment - 3rd floor
3021 W Stolley Park Rd Ap	live in apartment - no basement. Going to move - no opinion on subject.
3023 Idaho Ave	Knowing we were in a flood plain the house was built w/o a basement & above flood plain levels. No public money should be spent for people who bought or built in these areas without taking that into account.
3025 W Stolley Park Rd Ap	I currently live in an apartment building (ground level) and I have had no problems with this!
3027 W Capital Ave Apt 38	I have no basement
3027 W Capital Ave Apt 8	I do not feel that I should have to pay for water removal in some one else's basement
3028 Brentwood Pl	problems on 2 occasions since 1996
303 Dodge St	we have no basement at this address
303 E Nebraska Ave	partial bsmnt-mold in house-measures have worked somewhat it's still a mess. Thrasher (Omaha) wants \$2500 to fix things up I paid the fee to drain water into storm sewer. Seems like a waste of resources- please turn the wells on & pump to the Platt
3031 Idaho Ave	I have a crawl space and built it to flood level specs according to city code. There has been major water in our area but my crawl space stayed dry with out sand bagging
3033 W Capital Ave #23	I live on the 3rd floor of an apartment building.
3033 W Capital Ave Apt 1	basement apartment - measures have worked so far.
3033 W Capital Ave Apt 19	we live in an apt buidling on the 2nd floor. My boyfriend & I share an apt at this address. It is on the 2nd floor of the Chalet Apts so we don't have a problem with a basement.
3033 W Capital Ave Apt 40	lived in basement apt for 8 yrs - no problems so far
305 N Shady Bend Rd	the housees in our area of town do not have basements due to high groundwater levels. Neighbors say they have had it in crawl spaces before, but we haven't since buying the house in '95.
305 N Wetzel St	the only time we get water is when we get a big amount of rain & the groundwater is already high. We use a sump pump when necessary.
305 Oxnard Ave	we installed a system to pump from under basement. With the wood river project we are mostly dry. This wet summer was an exception we were damp but no water in basement
306 S Main St	crawl space
307 Dodge St	I have no water on the floor but would have if the pump failed
309 S Plum St	The people that have water problems can vote for dewatering wells. I have no problem so do not TAX me for their misfortune.

Address	Comment
310 Shady Bend Cir	we do not have a basement. However we do have flooding problems in our garage, living room, and utility room. This is fault of HCA. They will not fix problem
3102 E Seedling Mile Rd	we would like to put in a basement, but we know that the neighbors have pumped water out of theirs all summer.
3103 Briarwood Blvd	By law I could have put in a basement, but ground water in area has ALWAYS been a problem. DON'T BAIL OUT ANYONE! NOT CITY'S PROBLEM!
3103 Woodridge Blvd	we do not hav a basement
3104 S Blaine St	have a beaver system that's worked well in the past
3106 Brentwood Blvd	specific areas of GI should not be permitted to have basements
3109 Briarwood Blvd	crawl space
311 E Stolley Park Rd	we had an expensive system put in but we worry about the electricity going out which oeprates our system. It also is expensive to run the system.
311 Holcomb St	use sump pump have had water twice during 16 yrs highest 1/2-3/4 inch
3110 N North Rd	10 yrs ago we had problems. Installed 2 sump pumps. Have not had to use them. I have owned this house for 5 yrs. I haven't had water in my basement in this time.
3111 W Brentwood Blvd	sent letter
3111 W Stolley Park Rd	worst in 2007 - if continues we'll have to take measures
3112 Brentwood Cir	we have lived here only 3 mos but have not seen or heard anything about such a problem at this residence.
3115 Brentwood Cir	we have a sump to mitigate water problems. I ran it 10 yrs ago but have not since.
3115 Bntwood Blvd	we were very upset about water being pumped into lake in brentwood. It raised the groundwater level and contributed to our current problem. There are many people pumping water this year that never have before. Any questions please contact us. We have spent substantial money trying to resolve this.
3118 Brentwood Dr	the builders did a good job when our house was built. Solid foundation & fill set up to drain water away from foundation
3120 Briarwood Blvd	I have lived in this home since 1982 & hasve not had problems to this point
3120 S Blaine St	previous owner had problems. I would gladly pay a monthly fee if that is what it takes to pump the water table down.
3121 Brentwood Cir	partial basement - 5' into ground
3121 Brentwood Dr	have a crawl space
3122 Brentwood Blvd	built house without a basement when we built 10 yrs ago. We were advised of flooing & potential of high ground water levels.
3123 W Stolley Park Rd	we have an on going problem with water intrusion. We are constantly pumping ground water.
3126 N Webb Rd	it is my understanding when my home was built, it was built up higher on foundation to get away from groundwater intrusions.
3128 Briarwood Blvd	when we built home we put in a drainage system. Also drilled & gravel filled thru a clay pan problem that caused water to stand
3129 Briarwood Blvd	taxpayers should not have to bail out people with water problems - in low areas of town.
3131 Woodridge Blvd	6' deep basement. We are living in the Platte River Valley - it's a low area & we will always have groundwater problems in some areas of town.
314 Villa Mar Dec	please fix drainage problems in field south of us so our ditch isnt' full of water from the pump running!
3143 Woodridge Blvd	we have a sump pump it runs every 3-4 minutes
3144 Briarwood Blvd	we are utilitzing a beaver system which has been effective
316 E Phoenix Ave	when it rains flows to my intersection it goes to the lawn and forces water to come up in my basement.
316 Holcomb St	in 1999 spent \$7500 on drain tile system with 3 sump pumps draining in to backyard. System ran non stop may thru aug of '07

Address	Comment
3180 S Blaine St	no problem
3206 N Webb Rd	have a sump pump - it's never run. Our house was newly built in 2006
321 Holcomb St	I pay an extra \$50-\$60 a month for the 2 sump pumps it takes to keep the water out. My basement smells damp even though I have 2 dehumidifiers running.
323 Redwood Rd	haven't used mitigation measures as of yet
323 S Plum St	I've lived here for 14+ years and have never had a problem with groundwater
324 Wainwright St	the only time we've had problems was 10+ years ago. The drainage ditch to the south of us need to be cleaned out and since that was done we had no more problems, but it needs done again! Thank you!
326 S Vine St	Tom Ummel Jr - owner of property.
329 S Vine St	1966 Flood - 1 inch of seepage - none since then. House located on the high ground in the block.
3317 E Seedling Mile Rd	no basement
3318 Gregory Ave	4' crawl space - in the past have had up to 9" of water in it
3349 W Capital Ave	salon business - no problems
3404 Andrew Ave	we have a molley system - works for the most part. We have had water 3 times in the last 18 yrs because the sump pumps couldn't keep up
3406 W Capital Ave	this is a commercial building with no basement. We have not had trouble with groundwater as of yet
3412 E Gregory Ave	tri level home. Last time we had problems was in 1986. thankful we have no full basement. We're only 1/2 -4' in ground, but we've had wtaer twice since 1976.
3423 E Seedling Mile Rd	have no basement
3424 Andrew Ave	we've had water in our basement off & on since 1967. we raised the whole east side of our basement installing perforated pipes to drain to the west side & pump out.
344 Dodge St	flood project worked in my neighborhood
3507 Andrew Ave	end of May '07 we had 3 inches of water throughout the entire length of our basement. We pumped it out.
3519 Curran Ave	we aer new to Grand Island - seem strange it would take the city so long to correct a long existing problem. Welcom, Mr. Pederson.
353 Redwood Rd	Our home is 2 yrs old & was built with the city code de-watering system
3532 W Capital Ave	No ground water problem. Had a basement backup problem during flood 2 years ago.
3604 E Seedling Mile Rd	can't use basement because of groundwater - what a waste. Insurance company doesn't want to do anything. I have a big family and NEED the extra rooms, but can't use them because of ground water.
3617 Curran Ave Apt 9	no basement - I live in an upstairs apartment
3617 Hidden Pointe Dr	GI msut be very concerned about the under ground water supply. Soon it will be lost to us
3619 Curran Ave Apt 6	rental unit condo. Sump pump installed basement 10% of structure
3620 Hidden Pointe Dr	recently built - storm shelter. Small 6x6 below grade shelter off garage for potential storm problems
3633 Hidden Pointe Dr	I have owned two different homes - both had water problems. I installed 2 water systems costing me about \$15k. I feel this should be each ones own fix - not tax payers fix. Who don't?
3704 E Seedling Mile Rd	no basement - we have a fruit cellar in the ground about 3'. We have lived here 37 years and had water table up that high 3 times.
3716 E Seedling Mile Rd	we still ge groundwater, but it isn't as bad as it was before the beaver system
3820 E Seedling Mile Rd	sump pump on stand by at all times! Quit having this worthless council do studies and surveys! Just get rid of the stinch out here before anymore school bonds, jail bonds, etc. are passed! It is annoying and a disgrace for air quality!
3937 W Capital Ave	have not had trouble after water level went down

Address	Comment
3949 W Capital Ave	we did install a mitigation measure but when the groundwater level was so high we still had a little water seep in. If the groundwater levels should rise to the heights like back in 1984-86 and again in 93-94 we would probably have water on the floor. The dewatering systems work but if a pump fails or we would loose electrical power we would have a very serious problem. It is a constant concern & certainly adds much stress when the water table is high. We will appreciate any help that can be given to help solve the groundwater problems. Thank you, mr. pedersen, for your concerns.
3951 W Capital Ave	the B-DRY system put in 8/93 with 3 pumps. The ground water level has been lower and the system was tested 3 times for short periods in the years following. We can depend on the groundwater lowering when the farmer starts irrigating south of our house. Our concern is when the land around us is no longer irrigated.
4005 Boston Cir	we have had water come up in the sump. The water came up in the sump but didn't get deep enough to start the pump. We do have a problem with surface water during a heavy rain. The storm sewer isn't large enough to take it all and North Road is too high so water tends to accumulate & flood.
4005 Kay Ave	we have had water 5 times in our basement but not recently. Our basement is ruined we have 1 sump pump there
4005 Sacramento Cir	my house is built up higher than a lot of them
4006 Edna Dr	I have lived here for 26 yrs and the flood of May 2005 is the 1st and only time we have had groundwater in the basement. We had about 3 inches of water
4006 Kay Ave	ground water came very close to our basement floor level this summer - within inches
4007 Kay Ave	installed drainage system with 2 sump pumps. Hasn't run for several years but worked 1 year since installation
4009 Kay Ave	only lived here 6 mos. We have a sump pump
4009 Mason Ave	1993 had water in basement - ruined carpet, but nothing since then
4010 Manchester Rd	Have a beaver system - have sump pump attached but as water table has dropped past several years pump has not cycled
4011 Sacramento Cir	know the groundwater level before you buy. We bought a sump pump but never used it. Water was 4" below basement floor. I believe everyone is responsible for their own water problems
4012 Boston Cir	spring of '97 was very wet & groundwater was high. Our house was built with a beaver system to collect & pump out water. We used it that spring for 1 day because the water was just below the floor level
4012 Kay Ave	the previous owners put in drain tile around basement perimeter and added an additional sump pump
4012 Mason Ave	I have a beaver system but the water level has been down the last few years. If it ever got as high as in the 1980's I'd have problems
4013 Kay Ave	finished basement completely ruined due to water 6"-8" high for 3 months.
4013 Mason Ave	cannot pay for a dewatering system. Plus if outside water gets too high this system will have to turn off to avoid walls caving in.
4014 Mason Ave	we have lived here since 1987 we have had 1" water in some part of basement, not all over, three times. We glued down thin carpet/water proof glue easy to clean up.
4015 Kay Ave	I used one sump pump there was always some water in basement - low or deep - for about 5-6 years. Replaced furnace about 1983
4016 Edna Dr	when building basement under floor drainage system was installed. Had to run pump in pre-installed gathering pit for 2 days in May of 2005
4016 Kay Ave	beaver system installed
4018 Reed Rd	new housing in our location is higher than our property. Water drainage in area is not right. Utility/trail easement not done.
4019 Kay Ave	when we installed a dewatering system it was a two pump system. Even with a two pump system it was unable to keep up with the amount of water coming into the basement
4019 W Faidley Ave	house has basin but not plumbed (no pump) in unti - house fairly new
4020 Cannon Rd	measures work fairly well
4022 Driftwood Dr	city has taken measures. We have not had groundwater problems since city placed well or something in northwest area of city
4027 W Capital Ave	don't know if measures work - never needed in 3 mos. of owning home

Address	Comment
4028 W Faidley Ave	rain drainage in our egress windows
4030 Roth Rd	my house is split level
4031 Sacramento Cir	we just moved in here 5/07. there is a beaver system. We have had water 3 times since moving in. We did figure out a couple of solutions. We are sure we will have more problems.
4032 Craig Dr	Waste of time & money you'll do whatever you want anyway. Would rather the time spent on getting paychecks out on time!!!!
4035 Edna Dr	we only get water in the basement when it rains a lot
4035 Greenwood Dr	lived in house over 5 yrs - have never had a problem
4036 Sandalwood Dr	just moved in this summer. Measures work as far as we know.
4037 Norseman Ave	beaver/tile drainage system installed \$\$
4039 Cannon Rd	house was built at higher level
404 Holcomb St	I have neighbors with basements that have and have had groundwater intrusion problems
4042 Sandalwood Dr	it has a dewatering system - but we have not had to use it.
4043 Patchwork Pl	mitigation measures worked most of the time. I put a beaver system in in 1985. had water on floor in summer of 1993 & close other times
4045 W Airport Rd	I have no basement, but I was flooded out in '05 because the city did not take care of the silver creek
4046 Horseshoe Place	we have as much of a concern/problem with drainage from about ground-when rain comes and the water has no where to go-as we do with concerns about groundwater. We are ver concerned about damage to our home from either of these sources.
4047 Reed Rd	are on privates wells here & septic systems
4049 Cannon Rd	we have lived at this address for over 12 yrs and have never had groundwater in our basement
405 W Stolley Park Rd	how will a dewatering plan affect my private well??
4051 Craig Dr	new house, beaver system installed during construction. Never water problems, not even in system holding bins. Not in flood zone
4051 Manchester Rd	my house is built up off & above the street with beaver plumbing under floor. Never had to pump
4051 Zola Ln	we have lived here 7 yrs and have had no problems
4052 Allen Ave	New home - built up over crown of road. Beaver system installed.
4056 David Ave	lower level no water problems. Everyone with water problems put in a beaver system. I guess it works well for them. Big wells will pump the water down where there is no problem and not do any good where the problem is. Everyone with water problems should put in beaver system in their basement
4060 Cannon Rd	my 35" dep sump has 13" of water in the bottom as of 11/15/07
4060 Stauss Rd	have a crawl space
4063 Manchester Rd	built the lot up. Don't build basements in low area - old drain, slough area & check before you buy/build
4064 Allen Ave	Neighbors on both sides of us and across the street have all had water problems
4067 Allen Ave	problems with surface water. Sent letter.
4067 Northview Dr	newly constructed house (Nov '06) house built up higher than ground lever - 3 to 4'. Dirt filled in around house slopping outward from house- beaver system installed in house when built
4075 Edna Dr	house was built on a raised level we have poor street drainage.
4075 W Airport Rd	I have purchased 2 sump pumps but they have not kept up with the ground water coming in several times in the past.
4078 Dack Ave	our neighbors have had problems
4088 Nevada Ave	concerned w/ stagnatn water. We have a crawl space. We are concerned w/ surface flooding & poor drainage.

Address	Comment
409 Rosewood Cir	we have sump pump & serves it's purpose
410 Rosewood Cir	I can't answer the last question as I have not had any water problems to know whether the drain tile installed works - I'm assuming it does. My home was built in 02-03
4103 Allen Ave	we have not had problems - but others on our street have
4106 Manchester Rd	buy the highest house in your neighborhood and spend money on a dewatering system when you buy a house.
411 E South St	there's only one house on this block with a basement
411 Hall St	I have a crawl space at my home
411 N Shady Bend Rd	use of sump pump
4110 - 4130 Cannon Rd	we put in a thrasher system
4110 - 4130 Cannon Rd	we put in a trasher system
4111 Driftwood Dr	we moved here in 1999 and have had no water problems so far.
4111 Hartford St	drainage problem from groundwater is horrible in our backyard. Sometimes the utility cases are more than 1/2 covered with water. These are the ones that feed 1/2 our block
4111 Manchester Rd	building codes shouldn't allow basements in some parts of town. I don't feel all of us should have to pay for this problem. When houses are sold the buyers should be told of groundwater problems.
4112 Manchester Rd	Have never had water in the basement
4115 Prairie Ridge Ln	our house is 3 yrs old & the previous owners didn't put on downspout off shoots so we got water through one of our windows this summer
4115 W Airport Rd	in cellar
4115 West Ridge Ln	this is new construction so I don't know if I will have water in the basement - we do have a sump pump
4116 Allen Ave	the ditch behind our house needs to be redone so that water drains properly
4119 Cannon Rd	we have never had ground water problems and will never have ground water problems in the future.
4119 W Airport Rd	no basement because of high groundwater. We built a new house in 1994 w/ foundation only because of high ground water in this area. Did not want problems!
412 Nebraska Ave	installed sump pump this August, water was 12" from the top of the floor. Is now 20" from top of floor. Don't think sump pump will help any
4122 Prairie Ridge Ln	I worry about the rising ground water. I've never lived in a house with a basement before.
4127 Manchester Rd	have beaver system
4128 Prairie Ridge Ln	the house is 4 yrs old so code required drains were installed. No problems with water in the past 3 yrs we've lived here.
4129 Cannon Rd	we took into account the high water table when we built our house. We have had no problems.
4136 Mason Ave	we have w sump pump if water gets too high we still get water
4137 W Faidley Ave	have never had any ground water problems
4138 Arizona Ave	4' crawl space. Problems especially with flood & now all water bgeing pushed on us due to new housing development. Plan to call Thrashers to see if we can afford a sump pump. To the east of our property the ditch is not cared for - weeds & junk help impede drainage. We are concerned about how bad the drainage ditch drains. The city invested a lot of money & it was constructed wrong. Also we have constant back up from the new lake to the east so constant mosquitos and smell in the summer
4139 Allen Ave	our builder of our house did a good job to avoid wate rin the basement issues. We only have water in the backyard issues which are the direct result of poor development of the neighborhood.
4139 W Ridge Ln	this is a new construction house. We moved in in February of this year.
4140 Driftwood Dr	had water in 1993, year our house was built. Small amount in basement.
4142 Liberty Ln	Groundwater at freedom acres subdivision is 20+ feet below surface. Never been closer than 10'

Address	Comment
4144 W Faidley Ave	even when we had the 10" rain we didn't have groundwater problems
4145 W Airport Rd	have beaver system w/ 2 sump pits. Works usually but has not been able to handle the flow several times in the past. Ground water has cost me approx. \$50k in damage in last 22 yrs. of living here.
4146 Prairie Ridge Ln	just completed our updates and there has not been any rain since.
4146 West Ridge Ln	we have only lived in our new constructed house for 2 yrs. And have not had to run the system yet. But we do have a standing water problem in our yard & the park behind us. Poor drainage planning on the subdivision plans.
415 E Phoenix Ave	on borderline area for flooding during severe rain storms
4155 Texas Ave	just built our house & moved in weekend of 11/23/07
4159 W Faidley Ave	we built the house in 2003. additional precautions to guard against water infiltration were taken. Window well drains, internal & external drain tile, less depth of basement relative to normal depth. No water problems have been experienced.
416 Holcomb St	only once in the past
4160 Arizona Ave	have 4" tile under the basement floor leading to sump pump.
4164 Allen Ave	new home design with under floor and perimeter drain tile, drains to sump pit with sump pump
4165 Nevada Ave	Split level home - lowest level is 3 foot below ground. So far no water problems - not even during the flood
4166 Mason Ave	have sump pumps
4167 Mason Ave	power outage disables system
4170 Manchester Rd	we put in a beaver system. But haven't had groundwater problems for a few years.
4170 Norwood Dr	Drain Tile/Beaver System. Just moved here 8/07 so it's hard to answer some of these. Home is 3 yrs old, has had no water that time as far as I know.
4172 Redwood Ct	have lived at this address for 2 yrs
4175 W Airport Rd	concrete slab, no basement. Water level very high almost comes in front door when rains
4177 Mason Ave	think the measures taken are working but don't know we haven't had water problems in our area since. We put in a \$6k dewatering system - 3 big pumps & it started in 1983 - had 7 pumps running Easter Sunday morning of 1984. Water again in 1997 & then installed system in April of 1997
4177 W Capital Ave	have owned home for 20 yrs - no water problems unless heavy rains. We then have water in window wells and some seepage through blocks
418 Stagecoach Rd	have a storm shelter under sun room. Have lived here close to 3 yrs. Have not had water in there.
4182 Norseman Ave	we moved here in 1993 (summer). No one told us about past ground water problems in Capital Heights. We had problems in 93 & 98.
4185 W Airport Rd	our sump pump does keep up with the water most of the time. However, we are having more & more times when the sump pump can't keep up.
4186 Mason Ave	the measures I did take worked after the city or county installed wells & pumps & pipe to lower water level which I think were about 2 to 3 wells for whole area
4187 Mason Ave	water problems were very close this year - few inches below the floor. Would have had 6' of water in the basement in 1984 if I had not been pumping. Knocked a hole in the basement floor at it's lowest point many years ago & pumped out of that hole. Had water in the basement '83, '84, '85 and several other years after that clear up into the 90's. Would be willing to pay for dewatering this area.
4188 Norseman Ave	home has drainage system & we installed a sump pump the first year we were here. No problems since '96 & '97
419 Wyandotte St	the only time we had water in basement was several years ago when had so much rain 1/2 the town shut down.
4192 New Mexico Ave	a concrete drainage ditch runs along my property line - works very well.
4195 Iowa Ave	this is a new house we only have been in it since May
4196 Arizona Ave	I have a crawl space but have never had ground water problems
4196 Iowa Ave	we have only lived here since July so we haven't had any problems yet

Address	Comment
4196 Nevada Ave	didn't do any mitigation
4201 Michigan Ave	we have 2 sumps & pits to pump water out as soon as it gets in the pits. We haven't had any water in the pits in 7 yrs - still dry!
4203 Nevada Ave	have only been in this house for 6 years. There is a history of water problems
4205 Manchester Rd	it's been a long time and it don't work well so we took it off and using city water.
4206 Nordic Rd	bought home in 6/07 - home has sump pump & beaver system - no water intrusion problems to date
4207 Michigan Ave	problems in 80-81. since the city compelled the channel system in Capital Heights we have had zero problems
4208 Michigan Ave	split level - 4th level. Problems briefly in 1983
4209 Lariat Pl	in the past, we had flooding in the basement but a beaver system was installed. Only problems now are when electricity goes out...pump stops working
421 Stagecoach Rd	no problem as the wood river project took care of any problems
4210 New York Ave	put 5 12" holes 30" deep in basement floor with pumps. Helped some but did not keep it dry. When the land on east side of Independence was farmed and the irrigation well was turned on, it would drop our water level down to where our holes would be dry. It would only take 24 hrs to drop the water level. Now that the land is being developed the well won't be used to help us if the ground water comes up. So we are concerned as to what the future is going to bring.
4211 Manchester Rd	have never had water problem at this location
4212 Nordic Rd	garden level house
4216 Nevada Ave	the pumps you installed in our area have helped a lot - Thank you.
4216 Vermont Ave	1980's ran 2 sump pumps & 1 skimmer pump for 3-4 months. 1990's ran 1 sump pump for 1-2 months
4218 Spur Ln	as a taxpayer, I (we) would be willing to pay for dewatering processes in the city of Grand Island. The cost of health care with water issues, ie mold, is unmeasurable.
4219 Lariat Pl	we just moved in 10/07 & are not aware of any problems or measures taken
4220 Nordic Rd	have not had water problems since dewatering wells were drilled in this area
4221 Nevada Ave	I have 5 sump pumps, this year they ran almost all summer long
4221 W Capital Ave	no basement - no water in cellar
4222 Arizona Ave	basement is garden level not a full depth basement
4222 Kay Ave	garden level basement - groundwater level was 28" from top of ground in front yard next to the house
4222 Utah Ave	We do not have a basement but have had water before in the crawl space.
4223 Manchester Rd	when the drainage ditch was changed so the water drained out to North Rd the water problem was solved
4224 Michigan Ave	we had bad water problems in 1995 or 1996. they did work in our area to help & since then we have had very little water in the basement for the last 10 years.
4224 Nordic Rd	put in a tile system under basement floor. Works as long as water table does not get too high.
4224 Texas Ave	We pray that it will work if necessary. Haven't needed it in about 10 years.
4228 Utah Ave	thanks for asking & monitoring.
4229 Norseman Ave	have a beaver system - sump pump runs continuously every few minutes. After the dewatering well was installed out in our area, a few years ago ground water problems stopped in a very short time. They have not returned. We support dewatering wells (pumps) as do many of our neighbors.
4230 Arizona Ave	only 1 time did we have problems in 30 yrs. We only had water in the basement one time - 1984 I think. We don't want to pay for a groundwater system.
4230 Lariat Ln	we only had water 1 time in 1984 or 1985/86 began on Good Friday. The water table was very high in NW GI that spring
4231 Pennsylvania Ave	we built up dirt around our foundation and added another down spout. So far no more water!

Address	Comment
4233 Norseman Ave	have a sump pump - not sure if it helps
4234 Nevada Ave	All of our neighbors got water in their basements the flooding of May '05 except us.
4236 Spur Ln	have owned this home one year and during the heavy rains and area flooding. We were dry.
4236 W 13th St	when we had water for 2 yrs back in late 80's the city didn't worry about it then. So why do you now??
4237 Pennsylvania Ave	twice there was minimal water in different places since 2002
4239 Norseman Ave	we have not had any water in our basement since we moved here in 1992
4239 W Capital Ave	I think something should be done to eliminate this problem
4240 Nevada Ave	I have a split level house with a shallow basement. If I had a deeper basement I'm sure my water problems would be worse
4240 Utah Ave	we just have a crawl space. It may get damp I don't know
4241 Michigan Ave	1983 had ground water intrusions
4242 Michigan Ave	put in 3 sump pumps
4242 W Capital Ave	We had water in the early '80s
4243 Texas Ave	in 1983 we had 2 inches of water on our basement floor for 2 weeks. In 1993 about 1 inch for a week we used floor sump pumps to get rid of it.
4245 Nevada Ave	only lived here 18 mos. We have a sump pump and there is a city dewatering well next door that has run 24/7 since April.
4245 New York Ave	had water in basement short time in 80's. No problem since
4246 Nevada Ave	septrn \$6k on b-dry system with corogated pipe under basement floor. Alos, have dewatering well on our street which helps immensely for all neighbors.
4246 Vermont Ave	new gutters
4247 Branding Iron Ct	After heavy rains we have water come up thru our well. So far we've only used shop vac to clean up.
4247 Kay Ave	problems in 1993. we have a sump pump and a second hole for another pump. I am concerned that water has risen to within 3 feet of the surface in our second hole. If we have a wet spring, I'm guessing we could have problems.
4248 Manchester Rd	sent page letter
4249 Texas Ave	we had water in our basement in 1984 & 1994 and we placed sand points thru the basement floor - they have been removed
4252 Lariat Ln	high elevation - good drainage ditch
4252 Nevada Ave	sump pumps run occasionally. Sump pumps help & dewatering well in the area helps the most. No major problems since it was put in
4253 Vermont Ave	lived here since 8/05. our sump pump is 10 1/2' below ground level. In the 2 years living here I haven't seen any water in the well yet.
4255 Michigan Ave	we have lived in this home with a full basement for 34 years & have never had water in our basement. The city needs to stay out of this.
4255 Pennsylvania Ave	intrusion problem once in 1984
4258 New York Ave	I believe measures have worked - we will see
4258 Utah Ave	I have not had problems with water intrusion in my crawl space. My ditch out fornt sometimes has problems since my neighbor to the east doesn't have a good drain under his driveway
4259 Spur Ln	no problems that we know of - purchased 9/04. previous owner put in 3 sump pits
4261 Michigan Ave	in 1983 we used 3 sump pumps to pump 3k gallons a day from water below the basement floor. Carpet was wet
4262 Pennsylvania Ave	last incident was in 1993. prior was 1984. installed "B dry" system w/ 2 pumps
4264 Utah Ave	our water intrusion problems are minor. Our basement is for storage only. We keep everything up on wood pallets. Rarely do we have more than a puddle.

Address	Comment
4265 Vermont Ave	no problems with water in basement
428 Holcomb St	Ground water intrusion is a natural occurrence & is the responsibility of the land owner to correct or prevent. GI SHOULD NOT be involved when these limited number of intrusions are known to be possible before construction/purchase of said property.
4303 Michigan Ave	we keep good down spouts to take water from house
4304 Blauvelt Rd	measures taken - purchased a home w/out water problems. Am strongly opposed to city paying for dewatering for several reasons.
4305 Manchester Rd	we just moved in so we don't know if there has ever been water in the basement
4306 Blauvelt Rd	we got wet-damp no standing water in the 80's. Never since!
4306 Michigan Ave	let farmers pump ther water rather than the city
4308 Saddle Horse Ct	I am opposed to any plan that would require involuntary participation
4309 Blauvelt Rd	garden level
4312 Sherwood Rd	We moved here in 1992. there were sump pumps installed already. We haven't had problems.
4313 Blauvelt Rd	no problems
4317 Manchester Rd	mitigation worked but would be concerned if water table rose any highter than it has.
432 Dodge St	my groundwater is usually between five & six feet at the sidewalk. The plumber told me.
4320 Claussen Rd	performed pumping of groundwater. Don't use tax dollars to pump down the acquifier, it is a waste of money. If people want to attempt to alter nature let them use their own money
4321 Blauvelt Rd	split level
4323 Manchester Rd	city opened drainage cell so it would drain. This solved our problem. You would have better response if you had enclosed a return envelope.
4326 Cambridge Rd	our basement is shallower than many others.
4328 Manchester Rd	I have not lived here very lone (1 1/2 yrs) so can't relate to any problem except that we hear the sump pump start every so often
433 Stagecoach Rd	prior to the building of the wood river diversion canal I got groundwater in my basement only when wood river was at flood stage. Since the canal has been in place I have no problem
4331 Kay Ave	our hosue seems to set up higher in our yard - water usually gathers in our back yard. We have 3 sump pumps
4334 Cambridge Rd	don't know past problems/presently purchase home
4337 W Capital Ave	neighbors on all sides of us have experienced water in their basements. We have just been fortunate to date.
4338 Kay Ave	I have lived here for 10+ years and have not had water. Close once in 1997 I believe. But my basement has had approx. 12" of water sometime in the 80's.
4341 W Capital Ave	tri-level home - beaver system
4342 Cambridge Rd	there has been a dewatering well installed across the street at residence
4343 Kay Ave	after I added an additional sump pump (now have 3) city put in a well in our area. I have not pumped water since - around 7-8 yrs ago
4345 Manchester Rd	no problems in the 6 yrs we have lived here. It appears there were groundwater problems in this neighborhood and this house prior to installation of the drainage ditch between Manchester Rd & Laramie St.
4349 Sherwood Rd	we never had water in basement have a beaver system but hasn't run for 5 yrs after city put in detention centers
435 E South St	no basement crawl space only - no water problems
435 Hall St	Should be sent only to areas with basements
435 Holcomb St	do not have a basement

Address	Comment
435 Stagecoach Rd	have lived here since 2002 and had no problem - do have a sump pump - never used it
4355 Cambridge Rd	problem was very bad until we got the dewatering well. We probably would have groundwater in our basement right now, but we have a dewatering well in our back yard. We are VERY grateful for this
4356 W Capital Ave	we don't have groundwater problems, but we do get water in our basement from Engleman School runoff during moderate to heavy rains
4357 Lariat Ln	measures have worked so far - we got a beaver system in the back half of our basement
4357 Manchester Rd	only lived in home 2 yrs
4362 Lariat Ln	problems in '84 from Easter to July 4th & in '94/'95 briefly - less than a month. Have 1 sump pump and the well in our area helps
503 Memorial Dr	I rent & took measures myself - you know how landlords are in the town, rent don't fix anything. Heavy rain - walls cinder block - water seeping through - last flood soaked soil outside & sewer street backup to basement sink & run out on floor. Quite when rain water slowed. Vac water out of 2 rooms about 20 gallons. Was home lucky - I am in the morning.
504 Wyandotte St	lived here 4 yrs and have had none of the above problems
509 Memorial Dr	I have lived here for 18 months. What has happened in the past I don't know.
509 S Vine St	bi-level - I have to control too much rainwater due to heavy rains.
510 S Vine St	we have a garden level house but have not had a problem
511 Memorial Dr	we have a split level
512 Plum Rd	we built up dirt around the foundation which helps unless we have a lot of rain all at one time
512 Wyandotte St	during flood had problems. Only had water once since we lived here the past 31 yrs. It was in '92 or '93 when we had a lot of rain
516 Plum Rd	against dewatering developer, buyers & sellers should be responsible
519 E Ashton Ave	every time we get a heavy rain the street floods & runs into my basement. Also through basement floor.
519 Holcomb St	I have lived in this house for 50 yrs. Not yet had problems but they built my basement high & only 1/2 basement. Do not live in it. Storage only.
520 Wyandotte St	haven't had water since 1993
527 Holcomb St	ground water has been within twelve inches of our basement floor before the wood river diversion project. This fall (2007) it was within 24 inches of the floor.
529 E Memorial Dr	the sump pump I had installed several years ago probably presents ground water intrusion this spring/summer.
557 Stagecoach Rd	had problems before the flood control project the city has. No problems in basement since the flood control project on the wood river was completed.
578 Stagecoach Rd	have a crawl space that has had problems
580 Stagecoach Rd	storm cellar only - no problems to my knowledge. I've only lived here since 11/06
584 Stagecoach Rd	south GI is in the original Platte River & will have ground water with about average rainfall. Dewatering is a waste of money
604 Fleetwood Rd	newer construction - builder took measures
607 Plum Rd	we have owned the property since 3/03. never had a problem previous owner said he put a sump point well in around 1986 or 87. had to run it 24 hrs. a day for several days shortly after installation. He had no problem after that year. Never ran it after that for the next 17 yrs.
611 Fleetwood Rd	we have not had problems, but have pumps installed in case this becomes an issue
611 Plum Rd	never very much for problems - none this year. It has never been a problem. Water level was close a couple of times a few years ago, but not this year.
615 Hagge Ave	I placed a large sump pump in the middle of my basement floor in 1993. it lowered the water level which was just below the basement floor. If we had a significant rainfall during this period it would not have been enough to keep water out of the basement.

Address	Comment
617 Plum Rd	Grand Island has had ground water problems for years. We built our home in 1975 and knew about the ground problem. We elevated our home 2 feet and then put in partial basement 7 foot deep. 7 foot basement keeps us from having groundwater problems
617 Stagecoach Rd	minor problems starting in July '07, have only lived in house since 1/06. I installed a sump pump in early 8/07 - now have 2. since then, I've had very minor (a bit of dampness along outer wall in one corner) on a few occasions. I assume my response is confidential.
623 Roush Ln	don't have water problems - have no basement
633 Macarthur Ave	have not had groundwater problems since we have lived here 28 yrs
635 Memorial Dr	had ground water in basement - once in the 11 yrs we have lived here
636 Memorial Dr	no water in basement since flood of '67. however have water on the floor of garage (detached) quite often, even though there is no rain or reason for it.
639 E Ashton Ave	just moved in 8/07. from what I can tell there has never ben groundwater in the basement
641 Macarthur Ave	previous owner had sump pit installed after flood in 70's or 80's. Been in house since 2000. have had no problems
643 E Ashton Ave	we had seepage from the flood of '67. that was the only time. Pier lake flooded
648 Meves Ave	replaced gutters - added dirt
649 Macarthur Ave	in 1967 seepage thru cracks 6-10" deep. Have never been dumb enough to finish basement as apparetnly many others have. Responsibility and cost should fall on developers of flooded basement properties - building dept & planning people are equally responsible for allowing basements NOT the taxpayers responsibility
651 E Memorial Dr	sump pump has worked so far
651 Groff St	I think people should check into things before they buy, not after stuff happens then expect everyone to help pay for it.
657 Martin Ave	Have lived at this address since 1974 and have never had water in our basement.
659 E Ashton Ave	there hasn't been water in our basement since the floods in 60's- we've had no problem since we've owned this house. Basement walls & floors are sealed w/ cement paint.
668 Groff St	I feel that the property owner should be responsible for their property. I have had to pay for all repairs & improvements personally.
703 W Hedde St	don't have a basement
704 Hagge Ave	crawl space
704 Redwood Rd	we do have a sump pump system in place. It has never needed to operate
704 S Cherry St	why does the city & county continue to allow building homes in areas with groundwater problems (basements). The odor problem in GI is still a BIG problem (25 yrs)
705 Fleetwood Rd	New home, moved into home 11/2001, has 2 sump pumps. They've never kicked on. French Drains (3) in backyard - works pretty well in a heavy rain.
706 Fleetwood Rd	never had ground water
707 Church Rd	past problems are unknown. In the 5 yrs I've lived here, I have had no problems with water intrusions
709 Church Rd	I have lived here 5 years & haven't had problems. I have a sump pump but don't know if that matters or not.
710 W Hedde St Apt 7	None
711 Church Rd	we have a sump pump hole but no pump. This year we had a little water come into the hole, but it dried up & no harm done
711 Stagecoach Rd	we also own island inn - 2311 S Locust St
712 Hagge Ave	partial basement
713 Church Rd	I have owned my house for approx. 2 yrs. There are water marks on the basement walls about 3" up - so, there was groundwater intrusion problem at one time. I was told the house was in a flood zone prior to the wood river re-routing project. I also installed a sump pump - had a sump tank full of water when I took possession, but no pump

Address	Comment
715 Hagge Ave	not sure if mitigation measures have worked
715 W Stolley Park Rd	sump pump in basement when we moved in 7 1/2 yrs ago. We believe water was in basement years ago. No water in basement in past 7 1/2 yrs.
720 S Oak St	just moved into the apartment in September
725 Church Rd	we have a sump pump we've never used.
731 Church Rd	we have lived at this address for over 10 yrs with no water problems so far
801 W Stolley Park Rd	I do have a 2 foot deep hole about 6" in diameter that I think is for checking the groundwater depth. In the past 6 yrs it is usually dry or has a couple of inches of water in it. This year it was within a foot of the top most of the year
804 S Cherry St	I purchased my home because I knew it was a concrete slab on grad because I knew ground water is prevelant in the neighborhood
806 S Kimball Ave	partial basement
806 Sweetwood Dr	installed a sump pump and beaver system when house was built
809 E Bismark Rd	Have not had any problems - lived here 1 yr
809 S Pine St	problems during flood of 1967
809 S Vine St	when we built our home in 1976 the City would not let us have a basement because we were south of Bismark St & in the flood plain. But we still had to buy flood insurance. Many of the new homes being built should not ever have basements. You should have very strick rules & regulations on basement in low areas
811 E Delaware Ave	water got close to coming in about 8 years ago
811 Sweetwood Dr	we just moved into our house 3/07. we've had no problems. Basement has 2 sump pumps
816 E Oklahoma Ave	problems during flood 1967. we let water in through windows to help stabalize foundation in '67 then let water drain away a week or so later. In '80 we were hit by tornado & rebuilt house
817 Sweetwood Dr	we have put 2 18"x4' pits in basement 10 yrs ago. Had water in them 1st 2 yrs but has been dry since
820 S Arthur St	installed sump pump
821 Sun Valley Dr	dump pumps were installed but did not take care of the problem. Through much effort a dewatering well was installed across the street. It has kept our basement dry. Thank you!
822 E Delaware Ave	depth to water on 11/17/07 was 8'8" below the top of our foundation or 1.5' below our basement floor - that's the highest since 1997 sent letter
823 S Oak ST	the sewer line was rebuilt. It had a manhole cover at ground level. Now is totally underground & doesn't leak.
827 Driftwood Ct	we had water in the basement in 1984 when the water table was very high - none since - do have a sand pint outside wall.
827 E Bismark Rd	no problem
828 Driftwood Ct	in '93 water table came up, basement floor just became damp. No problems since
828 E Sunset Ave	our house is 12 years old we haven't had any groundwater problems at all!
830 E Sunset Ave	No problems since moved in 2001
831 E Delaware Ave	we have only lived here 4 yrs
831 E Phoenix Ave	no problems since 1967
832 Sweetwood Dr	bought home 1998 - started running dewatering system april 1999 - worked and ran every 20-25 minutes until July 1999 - no problems since. Except for the 2005 heavy rains when the detention cell plugged up on sweetwood and the water backed up thru the basement windows
833 E Bismark Rd	I have lived at this address since 1979 & have never had any groundwater problems
838 Redwood Rd	house was built with tile system
840 E Phoenix Ave	only problem during the '67 flood.

Address	Comment
902 E Sunset Ave	No problems in this area
903 E Oklahoma Ave	it would be a waste to send water down the river
903 S Cherry St	dewatering well to the east @ 927 E Phoenix may have helped. The drought of last 7 yrs has lowered water table
903 S Kimball Ave	When we bought the property the sump pump wasn't hooked up - three years ago during the big summer rain we had approx. 2" in the basement - last summer the pump ran twice & that was it
903 S Pine St	we are new owners there is a water mark on wall about a foot high. We have gutters.
904 S Greenwich St	there have been no ground water problems
905 Phoenix Cir	we moved here purposely because of no basement. July '06 - Sept '07 we lived at 2426 Del Mar Ave and these questions would have been answered yes, except the last
906 E Delaware Ave	the city put in a dewatering pump. Appreciated the city pump. No problem since it was installed
907 Claussen Ave	I do feel individuals should be somewhat responsible where they build, having basements. If they live/build in flooding areas they must realize the problems/cost they may have.
907 Sun Valley Dr	I purchased a tri level home because I knew there was problems with ground water in the neighborhood
908 S Locust St	I moved into this home 7/9/07 and to the best of my knowledge there were no problems. On 11/11, 11/20/2007 I am having thrasher basement systems install a perimeter drain system and a sump pump
908 S Oak St	we have a dewatering system but still a system to work in our area. Even more important we need much better street drainage
910 E Sunset Ave	so far we have been lucky. But when you live in GI you never know when it could happen to you.
910 S Vine St	not sure if previous owner had problems
911 E Phoenix Ave	put surveys online
914 S Vine St	no problems since 1967 when flood waters of the wood river overflowed into our locality
916 E Bismark Rd	Problems only with very heavy rainfall - 54 inches at one time.
916 S Sycamore St	haven't a clue what this about! Sorry.
918 S Oak St	everytime it rains heavy in a short time or long time our street floods causing water to completely flood our yard to the alley. When the water goes down water fills our basement about 3-5 inches
920 S Greenwich St	we live in a bi-level our lower level is street level
922 E Delaware Ave	split level
922 S Sycamore St	wood river project was supposed to take care of groundwater problems
923 E Phoenix Ave	the reason I have no groundwater problems in my basement is because the city & nrd put in a 300 gal/minute pump one property east of mine. There would be water in my basement now had this no taken place. I have no sump pumps in my basement.
923 S Vine St	after the '67 flood I cut 2 16" wide cut in the floor and put 4" drain pipe 16" below top of floor. I've had to dewater 4 times since then.
927 E Phoenix Ave	city installed a well in our back yard to dewater.
927 Nebraska Ave	water in ditch on Fonner Park Rd. When it's gone so is mine.
928 Pleasant View Dr	had water in basement in 1968
931 S Oak St	the sump pump runs continually twenty four hours a day
934 S Eddy St	I've had some water in basement when it rains. I've lived here 2 1/2 yrs. I just rent this from Action Property.
936 Sun Valley Dr	built my house and crawl space because I was aware of ground water in GI
937 S Sycamore St	we have 2 sump pumps & at times they can't keep up with all the water
940 S Pine St	We have water in basements a block away- have had all summer

Address	Comment
941 S Sycamore St	I believe pumping sand pits will do more good than a deep well. Check and clean wood river out to move water out.. Why? Had water in basement after flood most of the time. Except the year the pit was dug for ground for burington road bed. Also when Island Oasis was built because they had to pump water to do the job. Most of the water started after all the sand pits and detention cells were put in.
943 S Kimball Ave	have had water in basement 5 times in the past 37 yrs. The last time was when we had the 8" rain.
949 S Kimball Ave	city wells already in place if re piped could go a long way in reducing this problems.
949 S Sycamore St	Water in 1983, 1993 and two times this year. The water just came to fast and the rains too heavy and the sump system couldn't catch up.

City council trims sails on dewatering study resolution

By Harold Reutter
The Independent

The Grand Island City Council approved a dewatering study report Tuesday night but only after doing major surgery on the resolution giving the council's OK.

That surgery deleted three paragraphs, plus part of a fourth paragraph, to avoid giving any hint that the council was approving any implementation of the study findings.

The council's reluctance to approve implementation was due to the paucity of details on how the dewatering project would be financed.

The estimated price tag for the project is just more than \$13 million. The amortized cost over 20 years is \$1.23 million a year. The project also will need an estimated \$341,000 each year for operations and maintenance.

Public Works Director Steve Riehle said after Tuesday night's meeting that the altered resolution means the council agrees with the concept of dewatering outlined in the study but not much else.

For the record

In other action, the council:

- Amended the salary ordinance for zoo employees. The amendment authorized \$10,356 of retroactive pay to zoo employees who worked for the city before a pay scale had been approved.
- Abolished the need for individual permits to do open burning during two-week periods during the spring and fall.

"They're saying that Grand Island can be dewatered," he said.

Riehle had earmarked \$100,000 in this year's budget to design a series of vertical pumping wells and pipeline to carry groundwater to the Platte River. The idea is to lower the groundwater level and keep water out of basements.

After the meeting, he said he understands why the council is reluc-

tant to begin spending that \$100,000 when the much larger question of how to come up with the \$13 million remains unanswered.

"As I said in (Tuesday's) paper, it's a monster project," Riehle said.

The city has four general methods of paying it.

Those are making the project a general cost of the city, assessing the cost against individual homeowners in the dewatered areas, selling the water to downstream interests or completing a "cost shift" between the city's wastewater treatment plant and the dewatering district.

Councilman Larry Seifert said he had a call from a person within one of the proposed dewatering districts whose basement is not affected by high groundwater levels.

Kevin Prior of Olsson Associates said it might be possible to do a multilevel assessment against homeowners. Assessments would be contingent upon the severity of the groundwater problem for an individual homeowner.

But Seifert said he is concerned

about plunging ahead and then discovering an individual homeowner might be facing a \$300 bill.

Councilman Gale Larson also wondered whether the city and the Hall County Airport Authority could strike a cooperative arrangement on dewatering to improve cost efficiency. Airport officials have said they must lower the water table on airport land to complete runway repair work.

After the meeting, Riehle said water sales could be done to finance the project. Grand Island's own Water Department might be a potential buyer.

Riehle said the city is getting most of its water supply from the Platte River well field south of town. City officials have been concerned that, when the Water Department needs to drill new wells, it will be forced to put an equal amount of water back into the Platte River.

"If they have wells pumping 7,500 gallons of water from the well field, they would have to put 7,500 gallons of water back into the Platte," Riehle said.

If that happens, it makes sense to get the replacement water from the dewatering wells proposed for western and southeastern Grand Island.

Riehle admitted, however, that the Water Department may never be required to provide replacement water for what it pumps from the well field.

However, other cities or conservation interests downstream from Grand Island could be potential buyers, he said.

Riehle also pointed out that Grand Island's wastewater treatment plant is incurring extra costs because of the city's high water table.

Those costs come from groundwater seeping into the city's sanitary sewer pipes. They also come from homeowners who pump water directly into the city's sanitary sewer system to help keep their basements dry.

A lower water table would mean reduced costs for the wastewater plant.

If that happens, perhaps those

cost savings could be shifted from the wastewater plant to help finance the dewatering project, Riehle said.

While the council slowed things down Tuesday night, it did not want the dewatering project to screech to a halt.

Larson said he wanted progress to continue. If buyers for water eventually materialize, he said, Grand Island must be in a position to make those sales.

Also Tuesday night, the city council approved a policy with North-Western Public Service Co. to contribute \$2 per resident to a Grand Island economic development fund.

That will generate \$86,000 for Grand Island. The city will use that money for specific projects that encourage industrial development and growth of natural gas usage.

A committee will make recommendations to the council on which projects get financing. City Attorney Charlie Cuypers told the council that the committee could be a specially formed group or the Grand Island Economic Development Council.

CITY OF

Grand Island

NEBRASKA

PUBLIC WORKS

Dewatering Well Program



CITY OF Grand Island NEBRASKA

PUBLIC WORKS

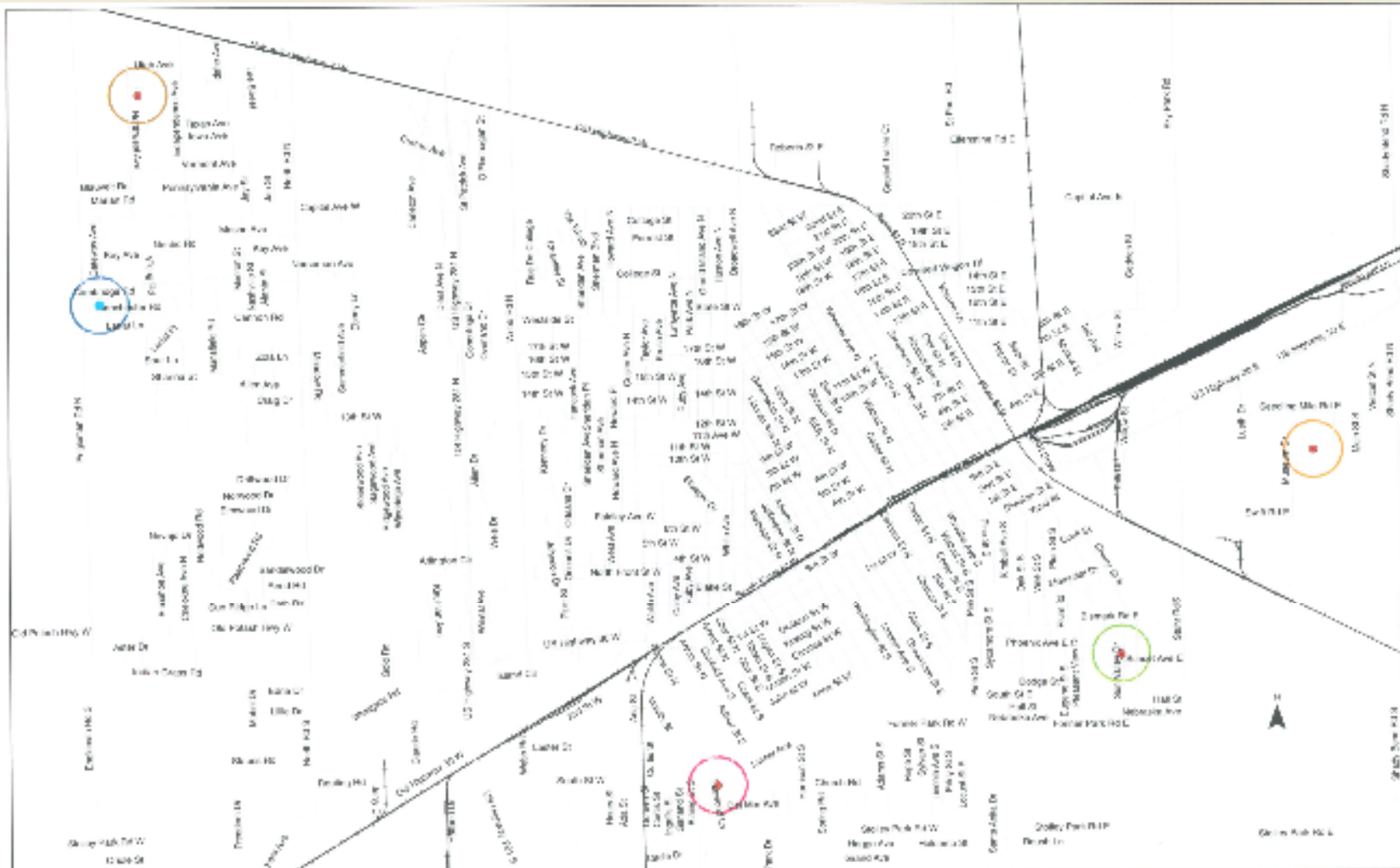

Benefit

- ➊ Dewatering wells are beneficial to all within the cone of influence.
- ➋ Dewatering wells may be beneficial to some outside the cone of influence; but this will be inconsistent.
- ➌ A single dewatering well does not have a significant affect much beyond the cone of influence, and cannot dewater the entire City.

*Note that the subject 5 wells dewater 171 properties, with some additional benefit to an additional 182.

Concerns

- 🌊 Dewatering without proper drainage may move the water issue to other properties.
- 🌊 Dewatering in some locations may pull ground water contamination toward the well.
- *Note that there are no known issues with the subject wells at this time.

Purpose

- There is no question that dewatering is beneficial to those within its cone of influence.
- Only Authorization is in question.

Authorization

🏞 December 21, 1998 agreement with the NRD established a 36 month limit; stating:

“The Interlocal Cooperation Agreement shall remain in full force and effect during the term of the demonstration project, this being a period not to exceed thirty-six (36) months from the date of execution by the City and District.”

*Note that the only amendment reiterated this 36 month limit.

Council Action

- When approving the resolution to approve the report, the City Council deleted 3 paragraphs and part of a fourth to “avoid giving any hint that the Council was approving any implementation of the Study’s findings.”

Ownership

- 🌐 The NRD retained ownership until the conclusion of the project:

“All personal property and fixtures acquired and used in the demonstration project shall be owned by the District. In the event the demonstration project is terminated and is not superseded by a permanent dewatering project any remaining equipment and fixtures shall become the property of the City....”

Liability

- 🌐 Disposal is the responsibility of the City:
“All cost of removal of the equipment and fixtures and abandonment and capping of wells shall be part of the actual expenses subject to reimbursement by the City ...”

Expectation

There was an expectation that either a City wide dewatering program would be established or that the wells would be removed (see Liability quote).

“In the event the City and District mutually agree that the demonstration project is successful and beneficial for the City and District, the Interlocal Cooperation Agreement may remain in full force and effect pursuant to amendment to be approved and adopted by the parties until superseded by a permanent dewatering project of some nature.”

Installation

🌊 Cambridge Road, Sun Valley Avenue, and Phoenix Avenue, were installed as part of the NRD contract.

🌊 Villa Mar Dee Avenue was installed to dewater the area to accommodate water and sewer line construction, and meant to be temporary.

🌊 The origin of the Nevada Avenue is uncertain.

*Note that the wells at Villa Mar Dee and Nevada do not require authorization, but were included for operational consistency.

Operation

- 🌐 The City has operated wells at Cambridge Road, Sun Valley Avenue, and Phoenix Avenue without Council authorization since September 2000.

Discussion

Resolution is for **Authorization**

*Note that the benefit of dewatering is not in question.

RESOLUTION 2011-162

WHEREAS, on December 21, 1998, by Resolution 98-333, the City of Grand Island approved an agreement with the Central Platte Natural Resources District (CPNRD) for the installation of test wells and monitoring wells for studying the success of the wells at lowering groundwater levels; and

WHEREAS, said agreement was amended on October 25, 1999, by Resolution 99-340;
and

WHEREAS, said agreement specifically limited this endeavor to no more than 36 months;
and

WHEREAS, in order for these dewatering wells to remain in operation the Public Works Department needs authorization for the funding of the existing dewatering wells.

NOW, THEREFORE, BE IT RESOLVED BY THE MAYOR AND COUNCIL OF THE CITY OF GRAND ISLAND, NEBRASKA, that the Public Works Department shall establish a dewatering program to operate, maintain, and repair dewatering wells. The program shall initially consist of facilities located at:

- 330 Villa Mar Dee Avenue; and
- 4351 Cambridge Road; and
- 4255 Nevada Avenue; and
- 2513 Phoenix Avenue; and
- 910 Sun Valley Drive.

- - -

Adopted by the City Council of the City of Grand Island, Nebraska, June 28, 2011.

Jay Vavricek, Mayor

Attest:

RaNae Edwards, City Clerk

Approved as to Form	☐ _____
June 24, 2011	☐ City Attorney