



City of Grand Island

Tuesday, September 28, 2010

Council Session

Item G8

#2010-258 - Approving Acquisition of Utility Easement - South of Capital Avenue and West of Lynn Lane in Merrick County - Joel Leetch & Janet Stryker

This item relates to the aforementioned Public Hearing Item E-2.

Staff Contact: Gary R. Mader

RESOLUTION 2010-258

WHEREAS, a public utility easement is required by the City of Grand Island, from Joel A. Leetch and Janet Stryker, to survey, construct, inspect, maintain, repair, replace, relocate, extend, remove, and operate thereon, public utilities and appurtenances, including lines and transformers; and;

WHEREAS, a public hearing was held on September 28, 2010, for the purpose of discussing the proposed acquisition of an easement located in Merrick County, Nebraska. The center line of the twenty (20.0) foot wide utility easement and right-of-way being more particularly described as follows:

Commencing at the northwest corner of Schwarz Subdivision, Merrick County, Nebraska; thence southerly along the westerly line of said Schwarz Subdivision on an assumed bearing of S0°59'06"E, a distance of five hundred thirty three (533.0) feet to the southwest corner of Lot Five (5), Block One (1) said Schwarz Subdivision being the ACTUAL Point of Beginning; thence N89°21'37"W, a distance of three hundred twenty one and sixty five hundredths (321.65) feet; thence S0°13'45"E, a distance of fifty five (55.0) feet. The side lines of the above described tract shall be prolonged or shortened as required to terminate on the boundary of Grantor's property.

The above-described easement and right-of-way containing 0.173 acres, more or less, as shown on the plat dated 9/3/2010, marked Exhibit "A", attached hereto and incorporated herein by reference,

NOW, THEREFORE, BE IT RESOLVED BY THE MAYOR AND COUNCIL OF THE CITY OF GRAND ISLAND, NEBRASKA, that the City of Grand Island be, and hereby is, authorized to acquire a public utility easement from Joel A. Leetch and Janet Stryker, on the above-described tract of land.

- - -

Adopted by the City Council of the City of Grand Island, Nebraska, September 28, 2010.

Margaret Hornady, Mayor

Attest:

RaNae Edwards, City Clerk

Approved as to Form	☐ _____
September 23, 2010	☐ City Attorney

CAPITAL AVENUE

SECTION LINE

NORTHWEST CORNER-
SCHWARZ SUBDIVISION

EAST LINE-
CEDAR LANE
SUBDIVISION

WESTERLY LINE,
SCHWARZ SUBDIVISION

PART OF THE NW 1/4, NE 1/4
SECTION 7-T11N-R8W
(MERRICK CO., NE)

S 0°59'06" E (ASSUMED)
533.0'

LOT 1

LOT 2

SCHWARZ

LOT 3

LOT 4
BLOCK 1

LOT 5

SOUTHWEST CORNER,
LOT 5, BLK 1, SCHWARZ SUB.

LOT 6
SUBDIVISION

LOT 7

LANE

LYNN

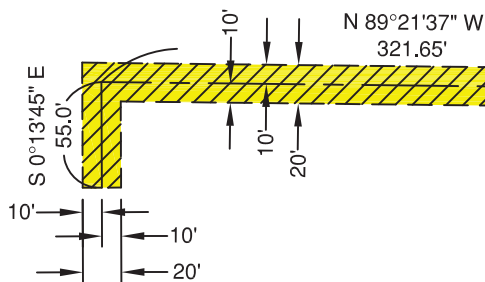

POINT OF
BEGINNING

LEGEND



INDICATES 20 WIDE
UTILITY EASEMENT



CITY OF
GRAND ISLAND
UTILITIES DEPARTMENT

EXHIBIT "A"

DRN BY: K.J.M.

SCALE: 1"= 100'

DATE: 9/3/2010

FILE: SEC- 7.11.8