



City of Grand Island

Tuesday, October 10, 2006

Council Session

Item G6

**#2006-288 - Approving Final Plat and Subdivision Agreement for
Summerfield Estates Subdivision**

Staff Contact: Chad Nabity

Council Agenda Memo

From: Regional Planning Commission

Meeting: October 10, 2006

Subject: Summerfield Estates Seventh Subdivision – Final Plat

Item #'s: G-6

Presenter(s): Chad Nabity AICP, Regional Planning Director

Background

This final plat proposes to create 35 lots on a tract of land consisting of a part of the West Half of the Southwest Quarter (W1/2 SW1/4) of Section 12, Township 11 North, Range 10 in the city of Grand Island, Hall County, Nebraska. This land consists of approximately 15.50 acres.

Discussion

The Final Plat for Summerfield Estates Seventh Subdivision was considered by the Regional Planning Commission at their meeting on October 4, 2006. A motion was made by Ruge and seconded by Brown to approve the Final Plat as presented. The subdivision agreement for this development will include provisions for the future extension of Summerfield Avenue north of the property platted with this subdivision to provide an emergency exit or entrance from the north. Also the water line in Summerfield Avenue will be extended to connect with the water line in State Street with this phase of the development. This will provide adequate water pressure to the new sections of the development. A roll call vote was taken and the motion carried with 8 members present voting in favor (Miller, O'Neill, Ruge, Reynolds, Monter, Brown, Niemann, Snodgrass).

Alternatives

It appears that the Council has the following alternatives concerning the issue at hand. The Council may:

1. Move to approve
2. Refer the issue to a Committee
3. Postpone the issue to future date
4. Take no action on the issue

Recommendation

City Administration recommends that the Council approve the final plat as presented

Sample Motion

Motion to approve as recommended.

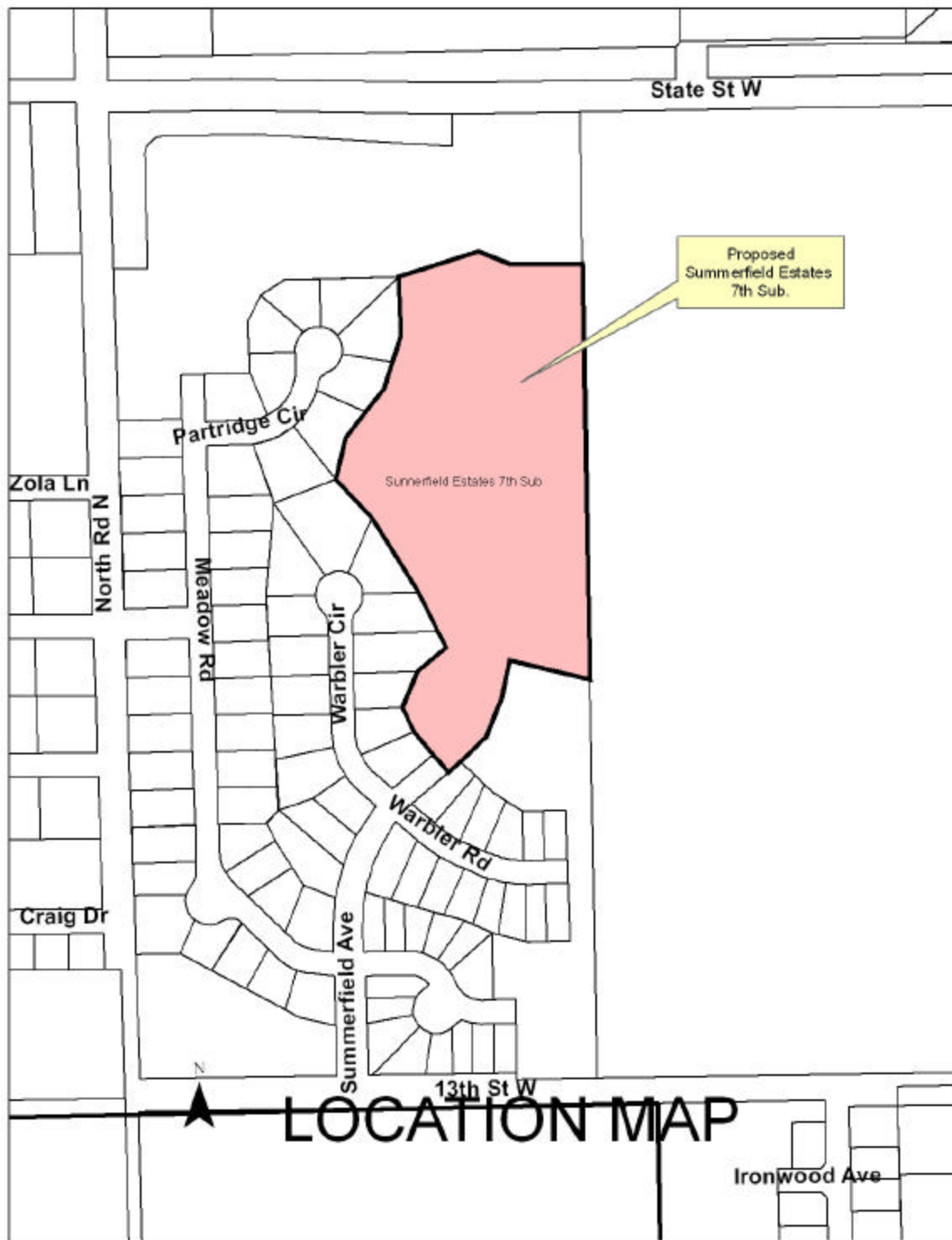

OLSSON
ASSOCIATES

221 First 2nd Street
P.O. Box 8302
Oxnard Island, NJ 08850-1072

TEL 303.386.8700
FAX 303.386.8702 www.olssonnj.com

SOUTHEAST COR. W/2. S40/4. SEC. 12. T11N. R10W
 FOUND PK NAIL
 38.26' NINE TO NAIL IN POWER POLE
 155.70' WSW TO PK NAIL W/WASHER STAMPED LS 458 IN LIGHT POLE/POWER POLE
 34.26' S TO NAIL IN POWER POLE
 177.25' ESE TO PK NAIL N/WASHER STAMPED LS 458 IN LIGHT POLE/POWER POLE

RESOLUTION 2006-288

WHEREAS, Little B's Corporation, a Nebraska corporation, as owner, has caused to be laid out into a lot, a tract of land comprising a part of the West Half of the Southwest Quarter (W ½ SW ¼) of Section Twelve (12), Township Eleven (11) North, Range 10, West of the 6th P.M. in the City of Grand Island, Hall County, Nebraska, under the name of SUMMERFIELD ESTATES SEVENTH SUBDIVISION, and has caused a plat thereof to be acknowledged by them; and

WHEREAS, a copy of the plat of such subdivision has been presented to the Boards of Education of the various school districts in Grand Island, Hall County, Nebraska, as required by Section 19-923, R.R.S. 1943; and

WHEREAS, a form of subdivision agreement has been agreed to between the owners of the property and the City of Grand Island.

NOW, THEREFORE, BE IT RESOLVED BY THE MAYOR AND COUNCIL OF THE CITY OF GRAND ISLAND, NEBRASKA, that the form of subdivision agreement hereinbefore described is hereby approved, and the Mayor is hereby authorized to execute such agreement on behalf of the City of Grand Island.

BE IT FURTHER RESOLVED that the final plat of SUMMERFIELD ESTATES SEVENTH SUBDIVISION, as made out, acknowledged, and certified, is hereby approved by the City Council of the City of Grand Island, Nebraska, and the Mayor is hereby authorized to execute the approval and acceptance of such plat by the City of Grand Island, Nebraska.

- - -

Adopted by the City Council of the City of Grand Island, Nebraska, October 10, 2006.

Jay Vavricek, Mayor

Attest:

RaNae Edwards, City Clerk

Approved as to Form	<input type="checkbox"/>	_____
October 6, 2006	<input type="checkbox"/>	City Attorney