



# **Hall County Regional Planning Commission**

**Wednesday, August 12, 2015  
Regular Meeting**

## **Item J5**

### **C.A.A.P. East Railroad**

**Staff Contact: Chad Nabity**

July 28, 2015

Dear Members of the Board:

**RE: Final Plat – C.A.A.P. East Railroad Second Subdivision.**

For reasons of Section 19-923 Revised Statutes of Nebraska, as amended, there is herewith submitted a final plat of C.A.A.P. East Railroad Second Subdivision, in Hall County Nebraska.

This final plat proposes to create 1 lot, on a tract of land comprising all of Lot Three (3), a part of the Southwest Quarter (SW1/4), and a part of the Southeast Quarter (SE1/4), all being in Section Eighteen (18), Township Eleven (11) North, Range Ten (10) West of the 6<sup>th</sup> P.M. in Hall County, Nebraska, said tract containing 4.623 acres.

You are hereby notified that the Regional Planning Commission will consider this final plat at the next meeting that will be held at 6:00 p.m. on August 12, 2015 in the Council Chambers located in Grand Island's City Hall.

Sincerely,

Chad Nabity, AICP  
Planning Director

Cc: Hall County Clerk  
Hall County Attorney  
Hall County Public Works  
Hall County Zoning Department  
Manager of Postal Operations  
Benjamin & Associates, Inc

This letter was sent to the following School Districts 1R, 2, 3, 19, 82, 83, 100, 126.





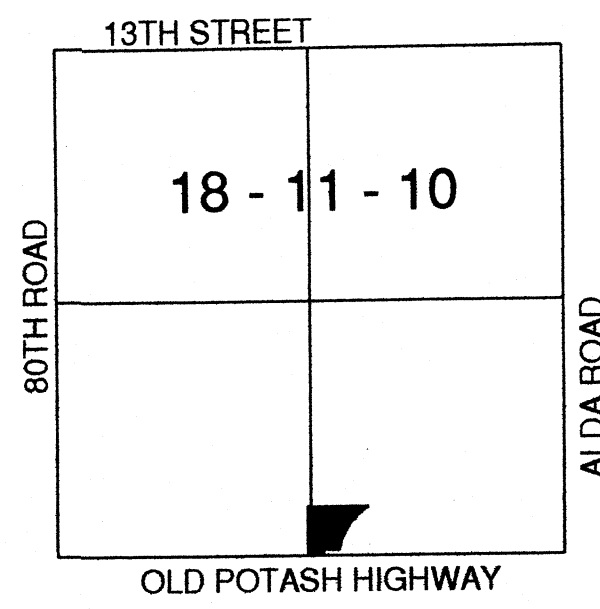

R1. = RECORDED DISTANCE ON SURVEY DATED JUNE 29, 2013,  
BY LEE D. WAGNER, L. S. NO. 557 (CAAP TRACT G)  
R2. = RECORDED DISTANCE AND/OR BEARING ON PLAT OF C.A.A.P.  
RAILROAD EAST SUBDIVISION  
A. = ACTUAL DISTANCE AND/OR BEARING

(L) = LENGTH OF CURVE DISTANCE  
(C) = CHORD DISTANCE  
(LCB) = LONG CHORD BEARING

- - INDICATES PK NAIL WITH DISK FOUND IN ASPHALT PAVEMENT
- - INDICATES 1/2" IRON PIPE FOUND

NOTE: ALL RAILROAD TRACK CENTERLINES (TANGENT AND CURVE) ARE THE  
ACTUAL PHYSICAL LOCATION OF THE RAILROAD TRACK CENTERLINE.

UNPLATTED

LOT 2  
CAAP RAILROAD  
EAST SUB.

LOT 1  
4.417 ACRES±

LOT 1  
CAAP RAILROAD  
EAST SUB.

UNPLATTED

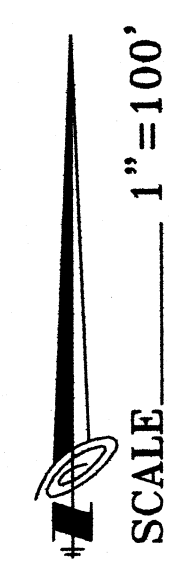

S.W. CORNER SW1/4  
SECTION 18-T11N-R10W  
FOUND ALUMINUM CAP IN  
ASPHALT PAVEMENT  
59.98' N.W. TO 1/2" IRON PIPE  
55.73' N.E. TO 1/2" IRON PIPE  
89.48' S.W. TO 1/2" IRON PIPE

2,644.90' R1.  
2,644.96' A.  
N89°46'46"W A.

S.E. CORNER SW1/4  
SECTION 18-T11N-R10W  
FOUND ALUMINUM CAP IN  
ASPHALT PAVEMENT  
96.42' N.W. TO NAIL IN 34" TREE  
112.01' S.E. TO NAIL IN POWER POLE  
158.65' S.W. TO NAIL IN POWER POLE

DEDICATE FOR PUBLIC  
ROAD RIGHT OF WAY

OLD POTASH HIGHWAY

SECTION LINE

# C.A.A.P. EAST RAILROAD SECOND SUBDIVISION

## HALL COUNTY, NEBRASKA

BENJAMIN & ASSOCIATES, INC. - ENGINEERS & SURVEYORS - GRAND ISLAND, NEBRASKA