



City of Grand Island

Tuesday, March 08, 2005

Council Session

Item F1

**#8953 - Consideration of Annexation of Land Proposed for
Platting as Preisendorf Subdivision Located North of Oklahoma
Avenue and East of Washington Street (Second Reading)**

Staff Contact: Chad Nabity

Council Agenda Memo

From: Regional Planning Commission
Meeting: March 8, 2005
Subject: Annexation (Second Reading)
Item #'s: F-1
Presenter(s): Chad Naby AICP, Regional Planning Director

Background

This application proposes to annex property located in the NW ¼ NE ¼ 21-11-9 into the City of Grand Island. This land is directly adjacent to the current City limit lines, and is proposed for platting as Preisendorf Subdivision.

Discussion

The owner of this property is proposing to subdivide the property into two lots as an addition to the City of Grand Island. The property is contiguous with the Grand Island Corporate Limits and was part of the county industrial tract. This property may not be annexed by the City as long as it is part of the County Industrial Tract, however the Hall County Board is processing an application to remove this property from that tract. This should be completed prior to council action on this property and must be done prior to final action on the property. City water and sewer are available to the property. The subdivider will extend the water line along the front of the property between Lincoln Street and across the Washington Street Right-Of-Way as part of the subdivision agreement.

Alternatives

It appears that the Council has the following alternatives concerning the issue at hand. The Council may:

1. Approve the annexation as presented
2. Modify the annexation to meet the wishes of the Council
3. Deny the request for annexation
4. Table the issue

Recommendation

A motion was made by Miller and seconded by Amick to **approve** and recommend that the Grand Island City Council **approve** the annexation of this land into the City of Grand Island.

A roll call vote was taken and the motion passed with 10 members present (Amick, Haskins, Lechner, O'Neill, Brown, Niemann, Miller, Eriksen, Ruge, Monter, Hayes, Wagoner) voting in favor.

Sample Motion

Approve this annexation as presented.

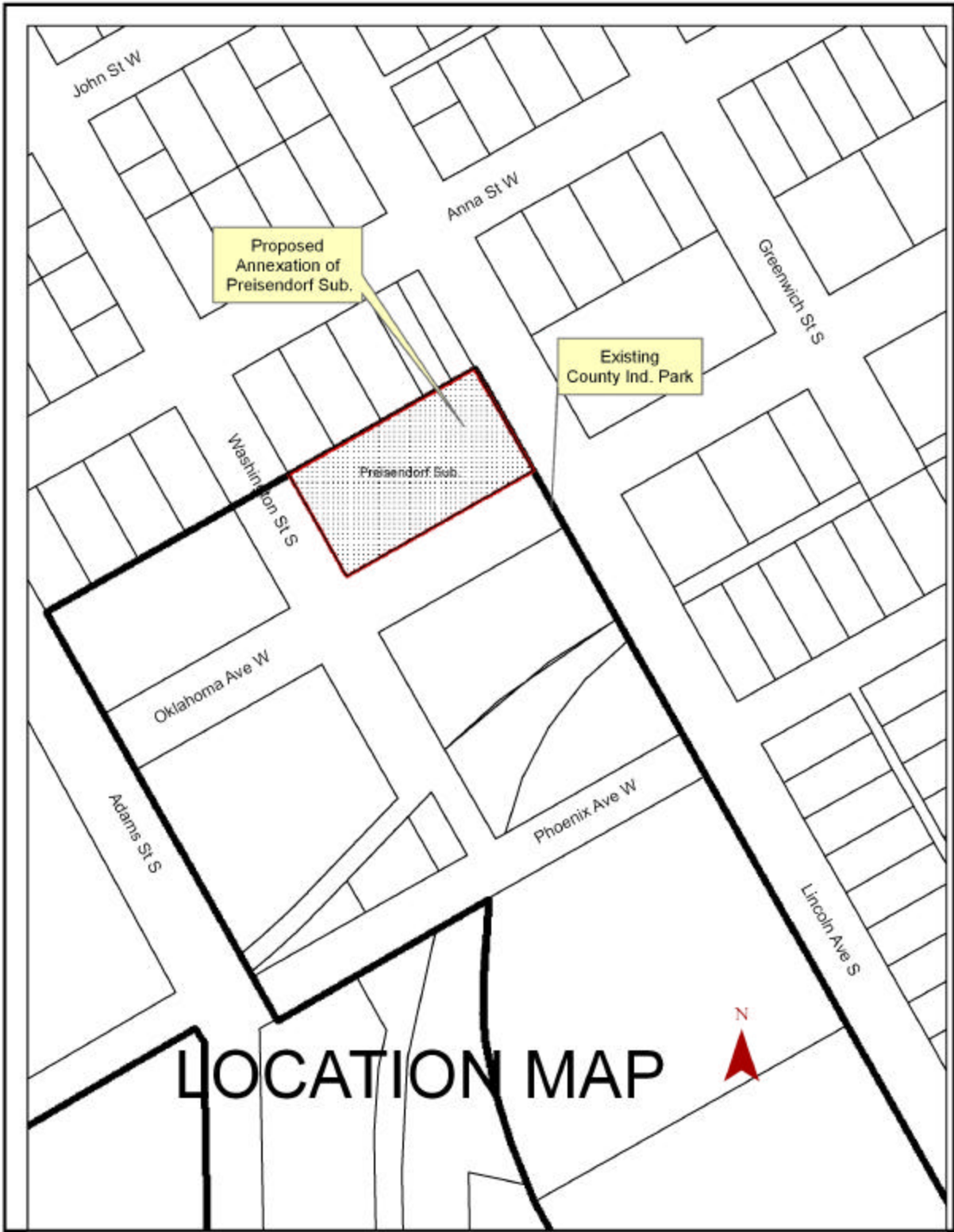

* This Space Reserved for Register of Deeds *

ORDINANCE NO. 8953

An ordinance to annex Preisendorf Subdivision into the City of Grand Island; to repeal any ordinance or parts of ordinances in conflict herewith; and to provide for publication and the effective date of this ordinance.

WHEREAS, Preisendorf Plumbing & Heating, Inc., a Nebraska corporation, as owner, has caused to be laid out into lots, a tract of land comprising a part of the Northwest Quarter of the Northeast Quarter (NW1/4, NE1/4) of Section Twenty One (21), Township Eleven (11) North, Range Nine (9) West of the 6th P.M. in Hall County, Nebraska, under the name of PREISENDORF SUBDIVISION, which is proposed to be an addition to the City of Grand Island; and

WHEREAS, after public hearing on February 2, 2005, the Regional Planning Commission recommended the approval of annexing such addition into the City of Grand Island; and

WHEREAS, after public hearing on February 22, 2005, the City Council found and determined that such annexation be approved on first reading.

Approved as to Form _____
March 3, 2005 City Attorney

ORDINANCE NO. 8953 (Cont.)

BE IT ORDAINED BY THE MAYOR AND COUNCIL OF THE CITY OF GRAND ISLAND, NEBRASKA:

SECTION 1. That Preisendorf Subdivision is hereby annexed into the City of Grand Island, and shall be entitled to all the rights and privileges, and shall be subject to all the laws, ordinances, rules, and regulations of the City of Grand Island

SECTION 2. Any ordinances or parts of ordinances in conflict herewith be, and hereby are, repealed.

SECTION 3. This ordinance shall be in force and take effect from and after its passage and publication, within fifteen days in one issue of the Grand Island Independent as provided by law.

Enacted: March 8, 2005.

Jay Vavricek, Mayor

Attest:

RaNae Edwards, City Clerk