



City of Grand Island

Tuesday, May 20, 2003

Council Session

Item G5

#2003-133 - Approving Final Plat and Subdivision Agreement for Grand Island Farmstead Project 4th Subdivision

Richard & Helen Strehle, owners, have submitted the final plat for Grand Island Farmstead Project 4th Subdivision, located west of Stuhr Road and south of Highway 34, Hall County within the Grand Island 2 mile jurisdiction. This plat proposes to create 2 lots on a parcel of land containing part of Lot 2, Grand Island Farmstead Project 2nd Subdivision, and part of the E1/2NE1/4 Section 34-11-9. These lots will be served by individual wells and on-site waste water treatment systems as city services are not available. This plat has been reviewed by the Planning, Public Works and Utilities Departments. The Regional Planning Commission, at their meeting of May 7, 2003, unanimously voted to recommend approval. See attached RESOLUTION.

Staff Contact: Chad Nabity

May 8, 2003

Honorable Jay Vavricek, Mayor
and Members of the Council
City Hall
Grand Island NE 68801

Dear Mayor and Members of the Council:

RE: FINAL PLAT – Grand Island Farmstead Project Fourth Subdivision, located West of Stuhr Road, and South of Hwy 34, Hall County, Nebraska, within Grand Island 2 mile jurisdiction.

At the regular meeting of the Regional Planning Commission, held May 7, 2003 the above item was considered. This final plat proposes to create 2 lots on a parcel of land containing part of lot 2 Grand Island Farmstead Project Second Subdivision, and part of the E ½ NE ¼ Section 34, Township 11, Range 9. This property consists of 4.57 acres and is zone TA Transitional Agriculture. The minimum lot size in the TA zone is 20,000 sq. ft. Nability said they would be required to meet DEQ regulations for septic systems on both the lots.

A motion was made by Eriksen and seconded by Hayes to **approve** and recommend that the City Council **approve** the final plat and subdivision agreements of Grand Island Farmstead Project Fourth Subdivision.

The Planning Commission passed this motion with 12 members present voting in favor (Amick, Haskins, Lechner, O'Neill, Hooker, Eriksen, Miller, Obst, Ruge, Obermeier, Hayes, Wagoner).

Yours truly,

Chad Nability AICP
Planning Director

cc: City Attorney
Director of Utilities
Director of Public Works
Director of Building Inspections
Manager of Postal Operations
Olsson & Associates

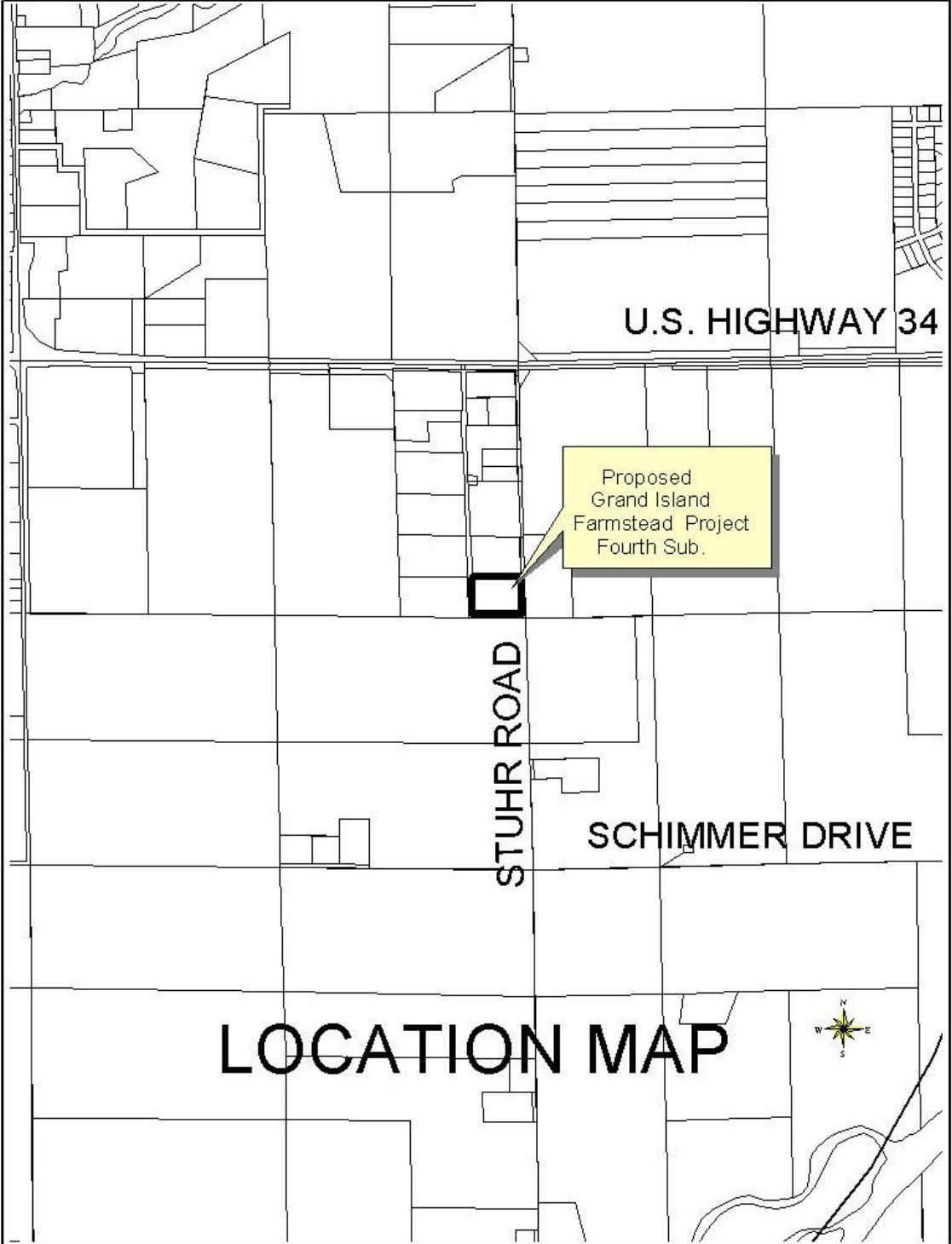

RESOLUTION 2003-133

WHEREAS, Richard J. Strehle and Helen K. Strehle, husband and wife, as owners, have caused to be laid out into lots, a tract of land comprising a part of Lot 2, Grand Island Farmstead Project Second Subdivision, located in the East Half of the Northeast Quarter (E1/2, NE1/4) of Section Thirty Four (34), Township Eleven (11) North, Range Nine (9) West of the 6th P.M. in Hall County, Nebraska, under the name of GRAND ISLAND FARMSTEAD PROJECT FOURTH SUBDIVISION, and have caused a plat thereof to be acknowledged by them; and

WHEREAS, a copy of the plat of such subdivision has been presented to the Boards of Education of the various school districts in Grand Island, Hall County, Nebraska, as required by Section 19-923, R.R.S. 1943; and

WHEREAS, a form of subdivision agreement has been agreed to between the owners and the City of Grand Island.

NOW, THEREFORE, BE IT RESOLVED BY THE MAYOR AND COUNCIL OF THE CITY OF GRAND ISLAND, NEBRASKA, that the form of subdivision agreement hereinbefore described is hereby approved, and the Mayor is hereby authorized to execute such agreement on behalf of the City of Grand Island.

BE IT FURTHER RESOLVED that the final plat of GRAND ISLAND FARMSTEAD PROJECT FOURTH SUBDIVISION, as made out, acknowledged, and certified, is hereby approved by the City Council of the City of Grand Island, Nebraska, and the Mayor is hereby authorized to execute the approval and acceptance of such plat by the City of Grand Island, Nebraska.

- - -

Adopted by the City Council of the City of Grand Island, Nebraska, May 20, 2003.

RaNae Edwards, City Clerk

Approved as to Form	☐ _____
May 15, 2003	☐ City Attorney