GIAMPO – Policy Board

Tuesday, May 27, 2014

Regular Session

Item H4

**Discuss & Approve Adjusted 2010 Urbanized Boundary Map &
Resolution 2014-2**

Staff Contact: John Adams

GRAND ISLAND

HALL COUNTY
NEBRASKA
POPULATION 48,534 (2010 CENSUS)
2014

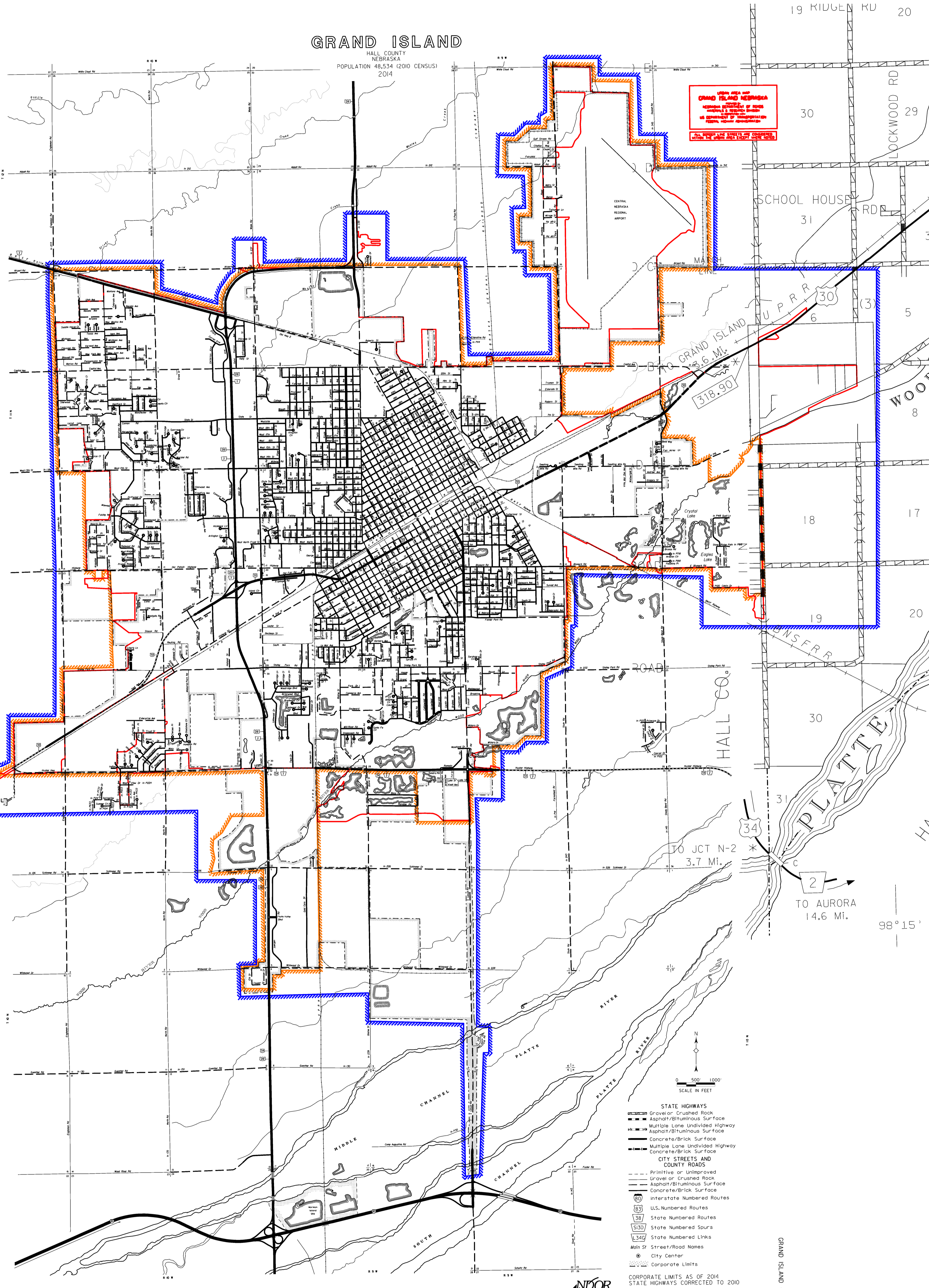

URBAN AREA OF GRAND ISLAND, NEBRASKA
 2014
 PREPARED BY NDOR
 AS PART OF THE 2014 URBANIZATION STUDY

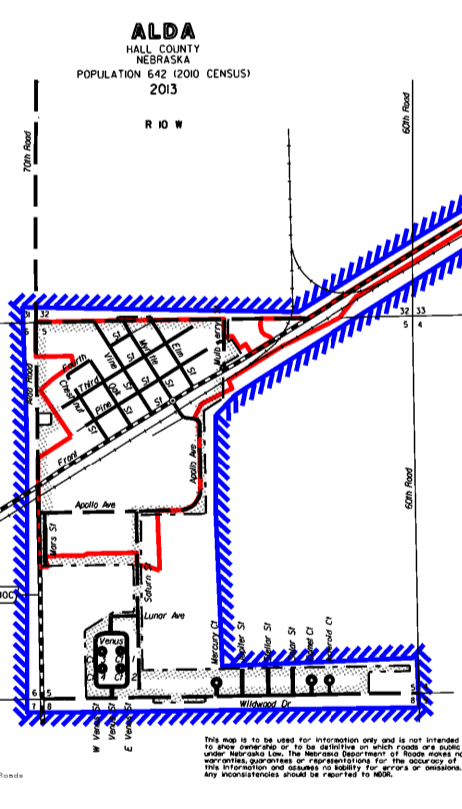

- STATE HIGHWAYS**
- Gravel or Crushed Rock
 - Asphalt/Bituminous Surface
 - Multiple Lane Undivided Highway
 - Asphalt/Bituminous Surface
 - Concrete/Brick Surface
 - Multiple Lane Undivided Highway
 - Concrete/Brick Surface
- CITY STREETS AND COUNTY ROADS**
- Primitive or Unimproved
 - Gravel or Crushed Rock
 - Asphalt/Bituminous Surface
 - Concrete/Brick Surface
 - Interstate Numbered Routes
 - U.S. Numbered Routes
 - State Numbered Routes
 - State Numbered Spurs
 - State Numbered Links
 - State Street/Road Names
 - City Center
 - Corporate Limits
- CORPORATE LIMITS AS OF 2014
STATE HIGHWAYS CORRECTED TO 2010

LEGEND
 CENSUS BOUNDARY
 EXISTING URBANIZED BOUNDARY
 PROPOSED URBANIZED BOUNDARY

- STATE HIGHWAYS**
- Gravel or Crushed Rock
 - Asphalt/Bituminous Surface
 - Multiple Lane Undivided Highway
 - Asphalt/Bituminous Surface
 - Concrete/Brick Surface
 - Multiple Lane Undivided Highway
 - Concrete/Brick Surface
- CITY STREETS AND COUNTY ROADS**
- Primitive or Unimproved
 - Gravel or Crushed Rock
 - Asphalt/Bituminous Surface
 - Concrete/Brick Surface
 - Interstate Numbered Routes
 - U.S. Numbered Routes
 - State Numbered Routes
 - State Numbered Spurs
 - State Numbered Links
 - State Street/Road Names
 - City Center
 - Corporate Limits
- CORPORATE LIMITS AS OF 2014
STATE HIGHWAYS CORRECTED TO 2010

GRAND ISLAND - 40

GIAMPO Resolution 2014-2

Grand Island Area Metropolitan Planning Organization (GIAMPO)

A Resolution Adopting the Adjusted 2010 Urbanized Boundary Map

WHEREAS, the Policy Board of the Grand Island Area Metropolitan Planning Organization (GIAMPO), is designated by agreement as the Metropolitan Planning Organization (MPO) for the Grand Island Urbanized area, by the Governor acting through the Nebraska Department of Roads in cooperation with locally elected officials; and

WHEREAS, Moving Ahead for Progress in the 21st Century Act, (MAP-21) Section 101(a) of Title 23 U.S. Code, requires the adjusted urbanized boundary within a metropolitan planning area be determined in cooperation with the state; and

WHEREAS, the Census Bureau has published an Urbanized Boundary Map based on the 2010 census data; and

WHEREAS, the Nebraska Department of Roads and the Grand Island Area Metropolitan Planning Manager have reached concurrence on the proposed adjustments of the 2010 Urbanized Boundary Map; and

WHEREAS, the MPO Program Manager recommends to the Grand Island Area Metropolitan Planning Organization (GIAMPO) Policy Board, approval of the adjusted 2010 Urbanized Boundary.

NOW, THEREFORE, BE IT RESOLVED by the Policy Board of the Grand Island Area Metropolitan Planning Organization for the Grand Island Urbanized Area adopts:

The adjusted 2010 Census Urbanized Boundary (illustrated on the attached map).

Certification:

The foregoing resolution was approved by the Grand Island Area Metropolitan Planning Organization Policy Board at its regularly scheduled meeting on May 27th, 2014.

By:

Attest:

Mayor, Jay Vavricek, City of Grand Island
GIAMPO Chairperson

John Collins, PE
GIAMPO Director/Secretary

Dated:

Dated: