



# City of Grand Island

Tuesday, November 25, 2014

Council Session

## Item G-8

**#2014-351 - Approving Temporary Construction Easements for South Blaine Street Bridge Replacements; Project No. 2014-B-1 (William H. Baasch)**

Staff Contact: John Collins, P.E. - Public Works Director

# Council Agenda Memo

**From:** Terry Brown PE, Assistant Public Works Director

**Meeting:** November 25, 2014

**Subject:** Approving Temporary Construction Easements for South Blaine Street Bridge Replacements; Project No. 2014-B-1 (William H. Baasch)

**Item #'s:** G-8

**Presenter(s):** John Collins PE, Public Works Director

## Background

This bridge project will replace the north bridge structure with two (2) box culverts and the south bridge structure with two (2) Arch RCP culvert pipes. The roadway will also be widened to improve traffic flow.

Temporary Construction easements are needed to accommodate the construction activities for South Blaine Street Bridge Replacements; Project No. 2014-B-1, which must be approved by City Council. The temporary construction easements will allow for the drainage improvements to this area.

A sketch is attached to show the temporary construction easement areas.

## Discussion

Temporary construction easements are needed from one (1) property owner for South Blaine Street Bridge Replacements; Project No. 2014-B-1 to be constructed.

There will not be any compensation for use of the temporary construction areas.

## Alternatives

It appears that the Council has the following alternatives concerning the issue at hand. The Council may:

1. Move to approve
2. Refer the issue to a Committee

3. Postpone the issue to future date
4. Take no action on the issue

### **Recommendation**

City Administration recommends that the Council approve the Temporary Construction Easements between the City of Grand Island and the affected property owner for South Blaine Street Bridge Replacements; Project No. 2014-B-1.

### **Sample Motion**

Move to approve the temporary construction easements.

RESOLUTION 2014-351

WHEREAS, temporary construction easements are required by the City of Grand Island, from affected property owners in the South Blaine Street Bridge Replacements; Project No. 2014-B-1 project area:

William H. Baasch –

Southeast Quarter of Section 29, Township 11 North, Range 9 West of the Sixth Principal Meridian in Hall County, Nebraska, and more particularly described as follows:

**West side of Blaine Street:**

Referring to the Easterly most corner of the East Half of Said Lot 8, thence S42°41'46"W a distance of 25.91 feet to the point of beginning; thence S42°41'46"W a distance of 34.89 feet; thence N10°11'04"W a distance of 142.00 feet; thence S34°54'25"E along the west Blaine Street Right-of-Way line a distance of 79.01 feet; thence S42°41'46"W a distance of 25.91 feet; thence S34°54'25"E a distance of 36.92 feet to the point of beginning. Containing an area of 2,507.98 square feet or 0.058 acres more or less.

**East side of Blaine Street:**

Referring to the Southerly most corner of the East Half of Said Lot 6, thence N34°54'25"W along east Blaine Street Right-of-Way line a distance of 37.95 feet to the point of beginning; thence N34°54'25"W a distance of 36.91 feet; thence N81°05'45"E a distance of 52.61 feet; thence S59°13'30"E a distance of 41.33 feet; thence S42°41'46"W a distance of 37.72 feet; thence N34°54'25"W a distance of 37.95 feet; thence S42°41'46"W a distance of 28.12 feet to the point of beginning. Containing an area of 2,058.75 square feet or 0.047 acres more or less.

WHEREAS, such Temporary Construction easements have been reviewed and approved by the City Legal Department.

NOW, THEREFORE, BE IT RESOLVED BY THE MAYOR AND COUNCIL OF THE CITY OF GRAND ISLAND, NEBRASKA, that the City of Grand Island be, and hereby is, authorized to enter into the Agreement for Temporary Easements on the above described tracts of land.

BE IT FURTHER RESOLVED, that the Mayor is hereby authorized and directed to execute such agreement on behalf of the City of Grand Island.

---

Adopted by the City Council of the City of Grand Island, Nebraska, November 25, 2014.

\_\_\_\_\_  
Jay Vavricek, Mayor

Attest:

\_\_\_\_\_  
RaNae Edwards, City Clerk

Approved as to Form	☐ _____
November 21, 2014	☐ City Attorney

# TEMPORARY ACCESS EASEMENT

## CITY OF GRAND ISLAND, HALL COUNTY, NEBRASKA



### TEMPORARY ACCESS EASEMENT DESCRIPTION (WEST SIDE OF BLAINE STREET)

A TEMPORARY ACCESS EASEMENT. A TRACT OF LAND LOCATED IN RIVERSIDE FARM SUBDIVISION IN THE EAST HALF OF LOT 8, LOCATED IN THE SOUTHEAST QUARTER OF SECTION 29, TOWNSHIP 11 NORTH, RANGE 9 WEST OF THE SIXTH PRINCIPAL MERIDIAN IN HALL COUNTY, NEBRASKA, DESCRIBED AS FOLLOWS:

REFERRING TO THE EASTERLY MOST CORNER OF THE EAST HALF OF SAID LOT 8, THENCE S42°41'46"W, A DISTANCE OF 25.91 FEET TO THE POINT OF BEGINNING; THENCE S42°41'46"W, A DISTANCE OF 34.89 FEET; THENCE N10°11'04"W, A DISTANCE OF 142.00 FEET; THENCE S34°54'25"E, ALONG THE WEST BLAINE STREET RIGHT OF WAY LINE, A DISTANCE OF 79.01 FEET; THENCE S42°41'46"W, A DISTANCE OF 25.91 FEET; THENCE S34°54'25"E, A DISTANCE OF 36.92 FEET TO THE POINT OF BEGINNING. CONTAINING AN AREA OF 2,507.98 SQUARE FEET, 0.058 ACRES.

### TEMPORARY ACCESS EASEMENT DESCRIPTION (EAST SIDE OF BLAINE STREET)

A TEMPORARY ACCESS EASEMENT. A TRACT OF LAND LOCATED IN RIVERSIDE FARM SUBDIVISION IN THE EAST HALF OF LOT 6, LOCATED IN THE SOUTHEAST QUARTER OF SECTION 29, TOWNSHIP 11 NORTH, RANGE 9 WEST OF THE SIXTH PRINCIPAL MERIDIAN IN HALL COUNTY, NEBRASKA, DESCRIBED AS FOLLOWS:

REFERRING TO THE SOUTHERLY MOST CORNER OF THE EAST HALF OF SAID LOT 6, THENCE N34°54'25"W, ALONG EAST BLAINE STREET RIGHT OF WAY LINE, A DISTANCE OF 37.95 FEET TO THE POINT OF BEGINNING; THENCE N34°54'25"W, A DISTANCE OF 36.91 FEET; THENCE N81°05'45"E, A DISTANCE OF 52.61 FEET; THENCE S 59°13'30"E, A DISTANCE OF 41.33 FEET; THENCE S 42°41'46"W, A DISTANCE OF 37.72 FEET; THENCE N34°54'25"W, A DISTANCE OF 37.95 FEET; THENCE S42°41'46"W, A DISTANCE OF 28.12 FEET TO THE POINT OF BEGINNING. CONTAINING AN AREA OF 2,058.75 SQUARE FEET, 0.047 ACRES.

#### LEGEND

- WOOD RIVER CENTERLINE
- PROPERTY LINE
- TEMPORARY ACCESS EASEMENT AREA

#### LOCATION MAP

NOT TO SCALE

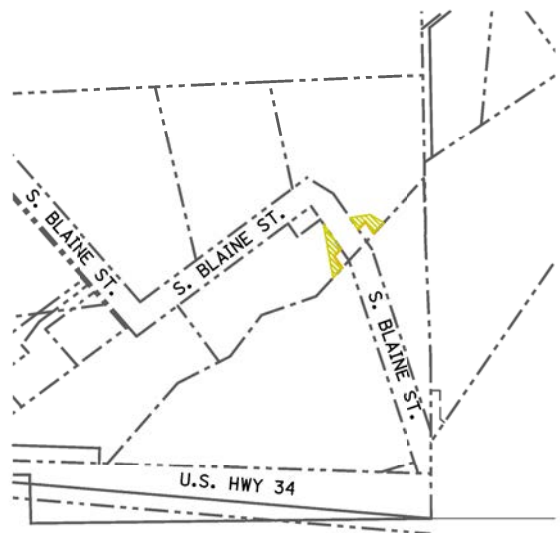

#### CERTIFICATION

I, JOHN R. EGGER, A PROFESSIONAL REGISTERED LAND SURVEYOR UNDER THE LAWS OF THE STATE OF NEBRASKA, CERTIFY THAT THIS MAP WAS PREPARED BY ME OR UNDER MY DIRECT SUPERVISION ON OCTOBER 5TH, 2014. I FURTHER CERTIFY THAT THE INFORMATION SHOWN IS CORRECT TO THE BEST OF MY KNOWLEDGE AND BELIEF. ALL DISTANCES SHOWN ARE REPRESENTED IN FEET AND DECIMALS OF A FOOT.

EXHIBIT	PROJECT NO: 110919.00
1	DRAWN BY: TAG
	DATE: 09/15/2014

BLAINE STREET BRIDGE REPLACEMENT NO. 2014-B-1  
GRAND ISLAND, NEBRASKA

