



City of Grand Island

Tuesday, April 12, 2022

Council Session

Item G-18

#2022-94 - Approving Acquisition of Drainage Easement in Nikodym Subdivision- 655 S Cherry Street (Nikodym)

This item relates to the aforementioned Public Hearing item E-3.

Staff Contact: John Collins, P.E. - Public Works Director

RESOLUTION 2022-94

WHEREAS, a public drainage easement is required by the City of Grand Island, from John J Nikodym, in part of Lot 2, Nikodym Subdivision, City of Grand Island, Hall County, Nebraska and more particularly described as follows:

COMMENCING AT THE NORTHEAST CORNER OF LOT 2, SIAD POINT BEING THE POINT OF BEGINNING; THENCE ON AN ASSUMED BEARING OF S00°18'06"W, ALONG THE EAST LINE OF SAID LOT 2, A DISTANCE OF 150.00 FEET; THENCE N40°37'50"W A DISTANCE OF 197.65 FEET TO A POINT ON THE NORTH LINE OF SAID LOT 2; THENCE N90°00'00"E, ALONG THE NORTH LINE OF SAID LOT 2, A DISTANCE OF 129.49 FEET TO THE POINT OF BEGINNING. SAID DRAINAGE EASEMENT CONTAINS A CALCULATED AREA OF 9712.09 SQUARE FEET OR 0.223 ACRES MORE OR LESS

NOW, THEREFORE, BE IT RESOLVED BY THE MAYOR AND COUNCIL OF THE CITY OF GRAND ISLAND, NEBRASKA, that the City of Grand Island be, and hereby is, authorized to acquire such public drainage easement from the property owner on the above described tract of land.

- - -

Adopted by the City Council of the City of Grand Island, Nebraska, April 12, 2022.

Roger G. Steele, Mayor

Attest:

RaNae Edwards, City Clerk

Approved as to Form	☐ _____
April 7, 2022	☐ City Attorney

DWC: F:\2021\08001-08500\021-08391\40-Design\Survey\SRV\Sheets\V_EASE_02108391.dwg
DATE: Mar 28, 2022 4:12pm
USER: jjimenez
XREFS: V_XTOPO_LDP_02108391 V_XRWAY_LDP_02108391

LOT 2
NIKODYM
SECOND
SUBDIVISION

NORTHEAST CORNER
LOT 2
NIKODYM SUBDIVISION

129.49'(E)
N90°00'00"E

P.O.B

N40°37'50"W
197.65'(E)

EXISTING 16'
UTILITY EASEMENT
INST NO 202200690

S00°18'06"W
150.00'(E)

LOT 2
NIKODYM
SUBDIVISION
(NOT A PART)

LOT 1
NIKODYM
SUBDIVISION
(NOT A PART)

CHERRY STREET

BISMARK RD

LEGEND

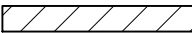
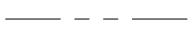
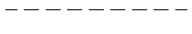
-  DRAINAGE EASEMENT
-  PROPERTY LINE
-  EXISTING EASEMENT LINE
- E EASEMENT DISTANCE
- P.O.B. POINT OF BEGINNING

DRAINAGE EASEMENT DESCRIPTION

A DRAINAGE EASEMENT LOCATED IN PART OF LOT 2, NIKODYM SUBDIVISION, CITY OF GRAND ISLAND, HALL COUNTY, NEBRASKA, AND MORE PARTICULARLY DESCRIBED AS FOLLOWS:

COMMENCING AT THE NORTHEAST CORNER OF LOT 2, SAID POINT BEING THE POINT OF BEGINNING; THENCE ON AN ASSUMED BEARING OF S00°18'06"W, ALONG THE EAST LINE OF SAID LOT 2, A DISTANCE OF 150.00 FEET; THENCE N40°37'50"W A DISTANCE OF 197.65 FEET TO A POINT ON THE NORTH LINE OF SAID LOT 2; THENCE N90°00'00"E, ALONG THE NORTH LINE OF SAID LOT 2, A DISTANCE OF 129.49 FEET TO THE POINT OF BEGINNING. SAID DRAINAGE EASEMENT CONTAINS A CALCULATED AREA OF 9712.09 SQUARE FEET OR 0.223 ACRES MORE OR LESS.

LOCATION MAP

SEC. 15, T11N, R9W
NOT TO SCALE

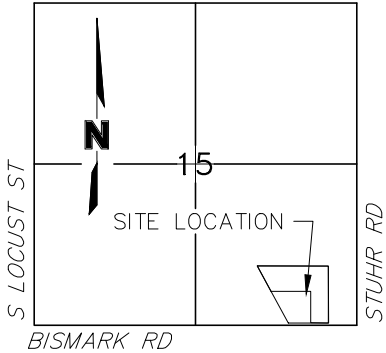

N



PROJECT NO: 021-08391

DRAWN BY: JMJ

DATE: 2022-03-28

DRAINAGE EASEMENT

Council Session - 4/12/2022

oisson

201 East 2nd Street
Grand Island, NE 68801
TEL 308.384.8750

EXHIBIT

1 Page 3 / 3