



City of Grand Island

Tuesday, November 20, 2018

Council Session

Item E-3

Public Hearing on Annexation of Property Located at 2610 So. Engleman Road (Rowe Second Subdivision)

Council action will take place under Ordinances item F-3.

Staff Contact: Chad Nabity

Council Agenda Memo

From: Regional Planning Commission

Meeting: November 20, 2018

Subject: An Ordinance to include Rowe Second Subdivision as an Addition to the City of Grand Island, Nebraska and the adjoining right-of-way

Presenter(s): Chad Nabity, AICP Planning Director

Background

The Annexation Component of the Grand Island Comprehensive Development Plan as adopted by the Grand Island City Council on July 13, 2004 sets as the policy of Grand Island that any and all property subdivided adjacent to the Corporate Limits of the City of Grand Island be annexed into the City at the time of subdivision approval.

Gary P. Rowe and Dee Rowe, husband and wife, as owners of the property submitted a plat of Rowe Second Subdivision an Addition to the City of Grand Island. The Hall County Regional Planning Commission recommended approval of the subdivision at their meeting on November 7, 2018.

Discussion

Staff has prepared an ordinance in accordance with the requirements of Nebraska Revised Statute §16-117. Annexation ordinances must be read on three separate occasions. This is the first reading of the ordinance. This ordinance includes exhibits showing the property to be considered for annexation and the legal descriptions of that property.

Annexation of this property will not result in the extension of the Grand Island Zoning Jurisdiction.

One residential lot would be added to the City as a result of this annexation. This property is located north of North Lane (in Westwood Park Mobile Home Park) and west of Engleman Road.

Alternatives

It appears that the Council has the following alternatives concerning the issue at hand. The Council may:

1. Move to approve
2. Refer the issue to a Committee
3. Postpone the issue to future date
4. Take no action on the issue

Recommendation

City Administration recommends that the Council pass the annexation ordinance.

Sample Motion

Move to approve the annexation ordinance on first reading.

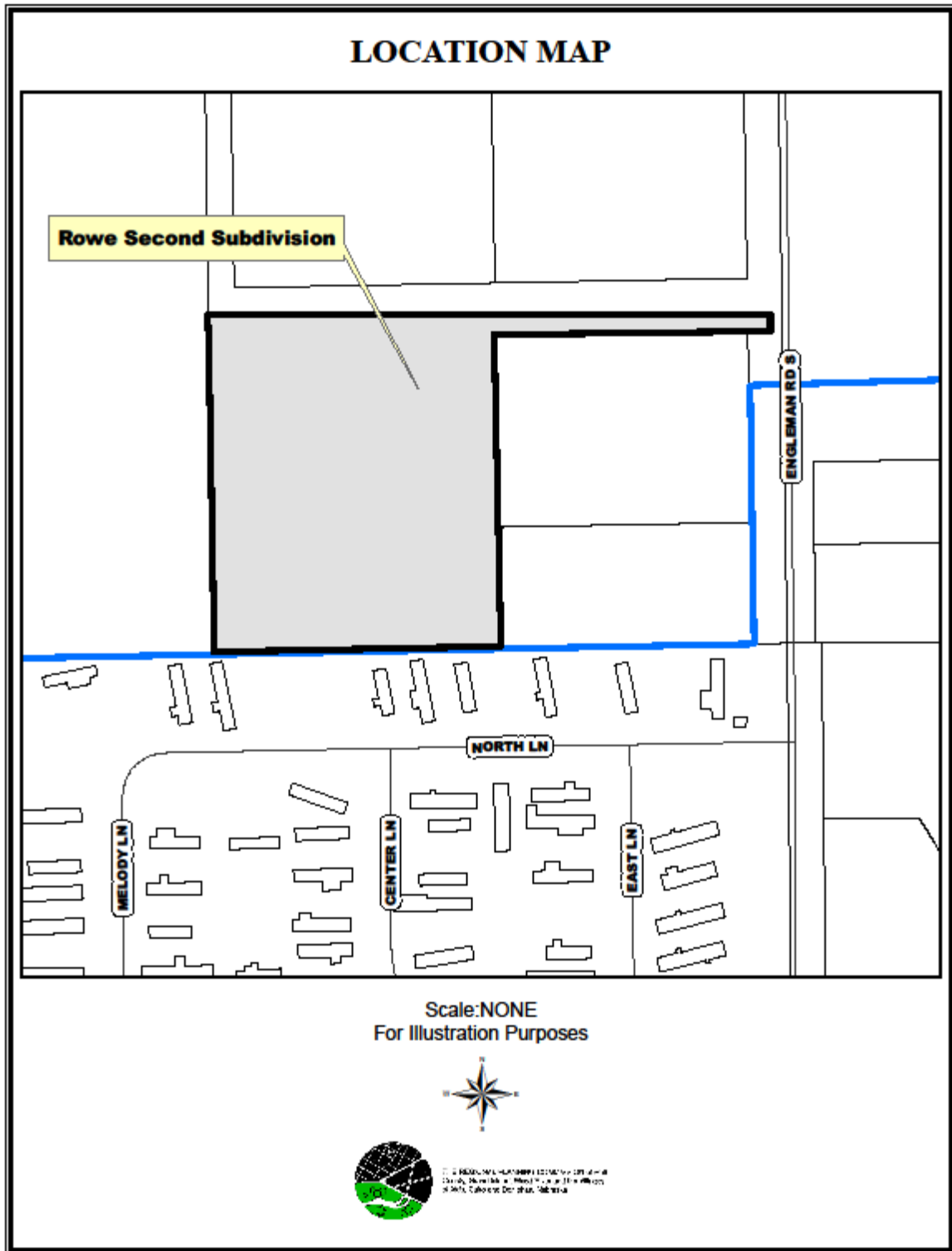

Developer/Owner
Gary P. & Dee Rowe

2550 S. Engleman Road
Grand Island, NE 68803

To create 1 lot west of Engleman Road and north of U.S. Highway 30 adjacent to Grand Island, Nebraska.

Size: 1 lot 3.1922 acres

Zoning: LLR Large Lot Residential

Road Access: Engleman Road is a City Street 24' Asphalt

Water Public: City water is available.

Sewer Public: City sewer is available.

