



# **Hall County Regional Planning Commission**

**Wednesday, October 3, 2018  
Regular Meeting**

## **Item J4**

### **Final Plat - Ummelville Third Subdivision**

**Staff Contact:**

September 20, 2018

Dear Members of the Board:

**RE: Final Plat – Subdivision List.**

For reasons of Section 19-923 Revised Statutes of Nebraska, as amended, there is herewith submitted a list of Subdivision Plats, for properties located in Hall County, Nebraska as attached.

You are hereby notified that the Regional Planning Commission will consider these Subdivision Plats at the next meeting that will be held at 6:00 p.m. on October 3rd, 2018, in the City Council Chambers located in Grand Island's City Hall.

Sincerely,

Chad Nabity, AICP  
Planning Director

CC: City Clerk  
City Attorney  
City Public Works  
City Utilities  
City Building Director  
County Assessor/Register of Deeds  
Manager of Postal Operations  
Applicant's Surveying Company  
Applicant

This letter was sent to the following School Districts 2, 19, 82, 83, 100, 126.

<b>Name</b>	<b>Acres</b>	<b>Lots</b>	<b>Legal Description</b>
Cedar Knoll Subdivision	1.15	1	A tract of land being all of lot one (1), Lepant Subdivision in the City of Grand Island, Hall County, Nebraska, and a part of the Southeast Quarter (SE1/4) of Section One (1), Township Eleven (11) North, Range Ten (10) west of the 6 <sup>th</sup> Principal Meridian, Hall County, Nebraska.
Crossroads Subdivision	10.82	5	A tract of land being part of Southeast Quarter of the Northeast Quarter (SE1/4NE1/4), Section Thirty-Three (33), Township Eleven (11) North, Range Nine (9) West of the 6 <sup>th</sup> Principal Meridian, Hall County, Nebraska.
Gooseberry Falls Subdivision	3.298	1	A tract of land comprising a part of the Northeast Quarter (NE1/4) Section Twenty Seven (27), Township Twelve (12) north, Range Twelve (12) west of the 6th P.M., Hall County, Nebraska.
Nancy Archer Acres Subdivision	3.146	1	A tract of land consisting of part of the Northwest Quarter (NW1/4) of Section Twenty (20), Township Eleven (11) North, Range Eleven (11) west of the 6th P.M., Hall County, Nebraska.
Ummelville Third Subdivision	2.11	2	A tract of land being all of Lot One (1), Concept Fourth Subdivision, in the City of Grand Island, Hall County, Nebraska.



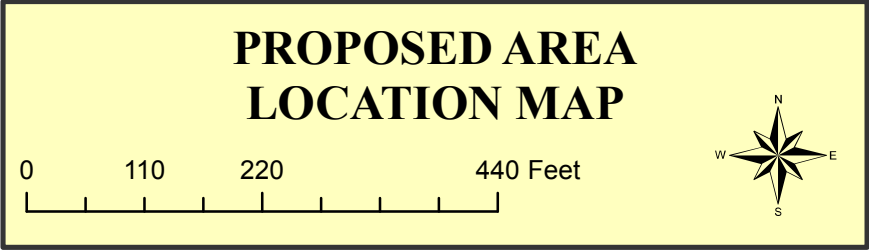
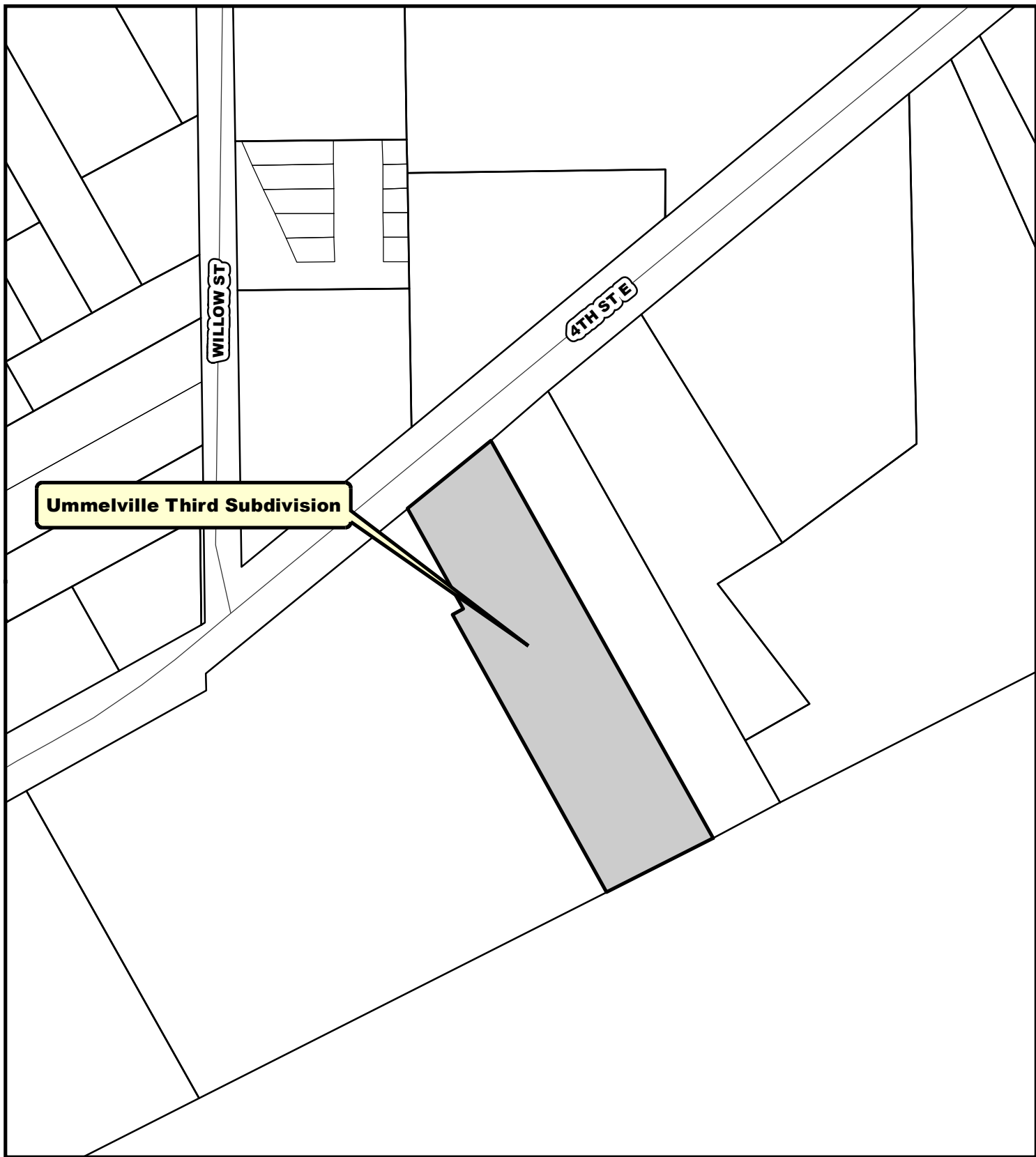



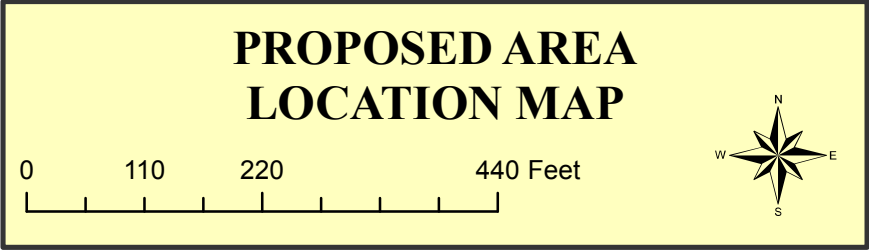



PLOTTED:9/13/2018 11:35 AM G:\Projects\149\149-LS\2018\149-LS-1548-18 Ummel Sub\Civil-Dwgs\Design Drawings\Survey Design\EX\_BASE\149-LS-1548-18 UMME.dwg

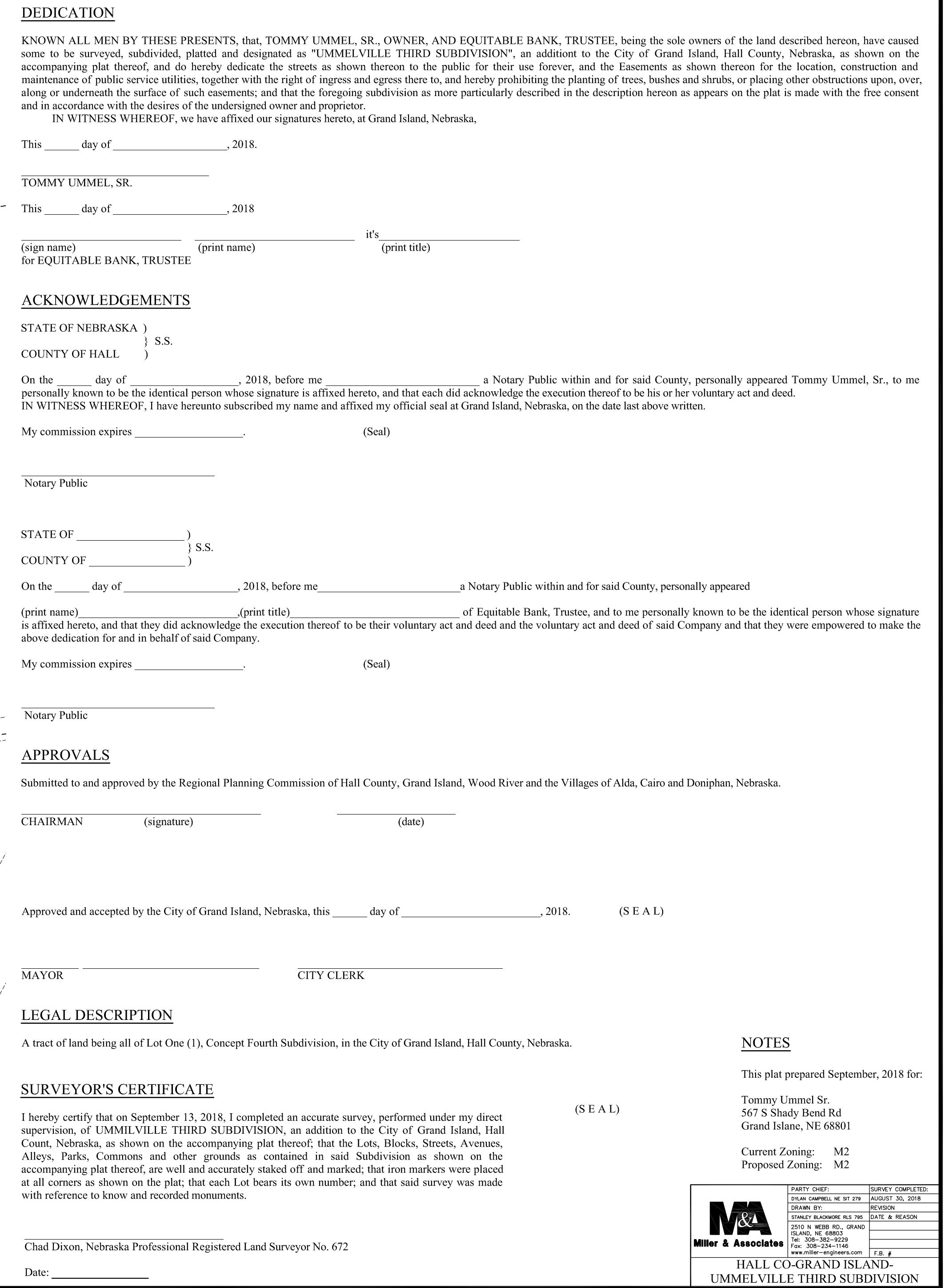

# **Hall County Regional Planning Commission**

## **SUBDIVISION APPLICATION**

This application must be submitted a minimum of 20 calendar days prior to a planning commission meeting to be considered at that meeting. Planning Commission meetings are typically held on the first Wednesday of the month.

### **Owners Information**

Name Tommy Ummel Sr.

Address 567 S. Shady Bend Road,

City Grand Island, State NE Zip 68801

Phone (308) 379-1313

Attach additional information as necessary for all parties listed as an owner on the plat and any other party such as: partners, Deed of Trust holders, etc...

All owners, lien holder's etc... will be required to sign the dedication certificate on the final plat.

As the applicant for this subdivision I do hereby certify that I have provided complete information regarding the ownership of the property included in this application:

By: \_\_\_\_\_  
(Applicant)

### **Surveyor/Engineers Information**

Surveyor/Engineering Firm Miller & Associates Consulting Engineers, P.C.

Address 1111 Central Avenue

City Kearney, State NE Zip 68847

Phone (308) 234-6456

Surveyor/Engineer Name Chad Dixon License Number 672

**SUBDIVISION NAME:** UMMELVILLE THIRD SUBDIVISION

#### **Please check the appropriate location**

- ☒ Grand Island City Limits
- ☐ 2 Mile Grand Island Jurisdiction
- ☐ Hall County
- ☐ City of Wood River or 1 Mile Jurisdiction
- ☐ Alda or 1 Mile Jurisdiction
- ☐ Cairo or 1 Mile Jurisdiction
- ☐ Doniphan or 1 Mile Jurisdiction

#### **Please check the appropriate Plat**

- ☐ Preliminary Plat
- ☒ Final Plat
- ☐ Administrative Plat (Grand Island, Alda, Doniphan, and Cairo)

Number of Lots 1

Number of Acres 2.11

#### **Checklist of things Planning Commission Needs**

- ☒ 10 + 15 copies if in City limits or the two mile jurisdiction of Grand Island
- ☐ 5 + 15 copies if in Hall County, City of Wood River, Village of Cairo, Doniphan or Alda.
- ☐ 5 copies if Administrative Plat
- ☒ Closure Sheet
- ☒ Utilities Sheet – See Preliminary Plat
- ☒ Receipt for Subdivision Application Fees in the amount of \$ \_\_\_\_\_

Providing false information on this application will result in nullification of the application and forfeiture of all related fees. If you have any questions regarding this form or subdivision regulations administered by the Hall County Regional Planning Department call (308) 384-3341.

**FEE SCHEDULE ON REVERSE SIDE**