



City of Grand Island

Tuesday, October 10, 2017

Council Session

Item E-1

Public Hearing on Request from Whitey's, Inc. dba Whitey's Sports Bar & Grill, 2118 No. Webb Road for a 20' x 20' Addition to their "Class C" Liquor License

Council action will take place under Consent Agenda item G-3.

Staff Contact: RaNae Edwards

Council Agenda Memo

From: RaNae Edwards, City Clerk

Meeting: October 10, 2017

Subject: Public Hearing on Request from Whitey's, Inc. dba Whitey's Sport Bar & Grill, 2118 No. Webb Road for an Addition to Class "C-093291" Liquor License

Presenter(s): RaNae Edwards, City Clerk

Background

Whitey's, Inc. dba Whitey's Sports Bar & Grill, 2118 No. Webb Road has submitted an application for an addition to their Class "C-093291" Liquor License. The request includes the addition on the liquor license for storage.

Discussion

City Council action is required and forwarded to the Nebraska Liquor Control Commission for issuance of all licenses. This application has been reviewed by the Clerk, Building, Fire, and Health Departments.

The request is to add a 20' x 20' area to the north of their current license for storage purposes only. Staff is recommending approval contingent upon final inspections.

Alternatives

It appears that the Council has the following alternatives concerning the issue at hand. The Council may:

1. Approve the application.
2. Forward to the Nebraska Liquor Control Commission with no recommendation.
3. Forward to the Nebraska Liquor Control Commission with recommendations.
4. Deny the application.

Recommendation

Based on the Nebraska Liquor Control Commission's criteria for the approval of Liquor Licenses, City Administration recommends that the Council approve the application contingent upon final inspections.

Sample Motion

Move to approve the application for an addition to Whitey's, Inc. dba Whitey's Sports Bar & Grill, 2188 No. Webb Road Liquor License "C-093291" for an addition of a 20' x 20' area for storage use only contingent upon final inspections.

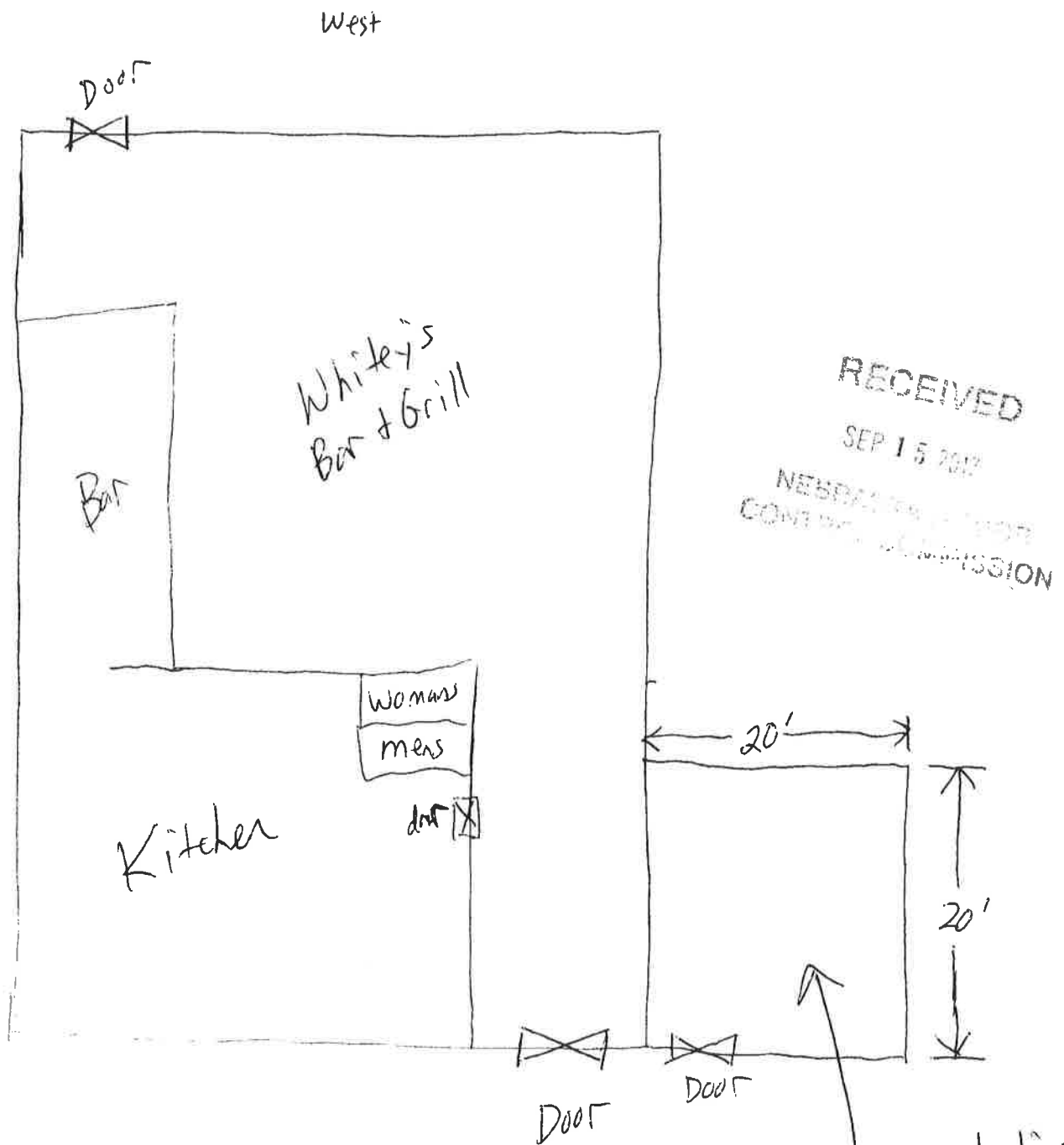

new addition,
this 400' sq. ft
room will be used
for storage only

East