



Hall County Regional Planning Commission

Wednesday, October 04, 2006
Regular Meeting

Item J5

Summerfield Estates Seventh Subdivision

*Summerfield Estates Seventh Subdivision, located east of North Rd. and north of 13th St.
(35 acres)*

Staff Contact: Chad Nabity

September 21, 2006

Dear Members of the Board:

RE: Final Plat – Summerfield Estates Seventh Subdivision.

For reasons of Section 19-923 Revised Statutes of Nebraska, as amended, there is herewith submitted a final plat of Summerfield Estates Seventh Subdivision, located east of North Road and north of 13th Street.

This final plat proposes to create 35 lots on a tract of land consisting of a part of the West Half of the Southwest Quarter (W1/2 SW1/4) of Section 12, Township 11 North, Range 10 West of the 6th P.m., City of Grand Island, Hall County, Nebraska. This land consists of approximately 15.50 acres more or less.

You are hereby notified that the Regional Planning Commission will consider this final plat at the next meeting that will be held at 6:00 p.m. on October 4, 2006 in the Council Chambers located in Grand Island's City Hall.

Sincerely,

Chad Nabity, AICP
Planning Director

cc: City Clerk
City Attorney
Director of Public Works
Director of Utilities
Director of Building Inspections
Manager of Postal Operations
Rockwell & Associates

This letter was sent to the following School Districts 1R, 2, 3, 8, 12, 16, 19, 82, 83, 100, 126.

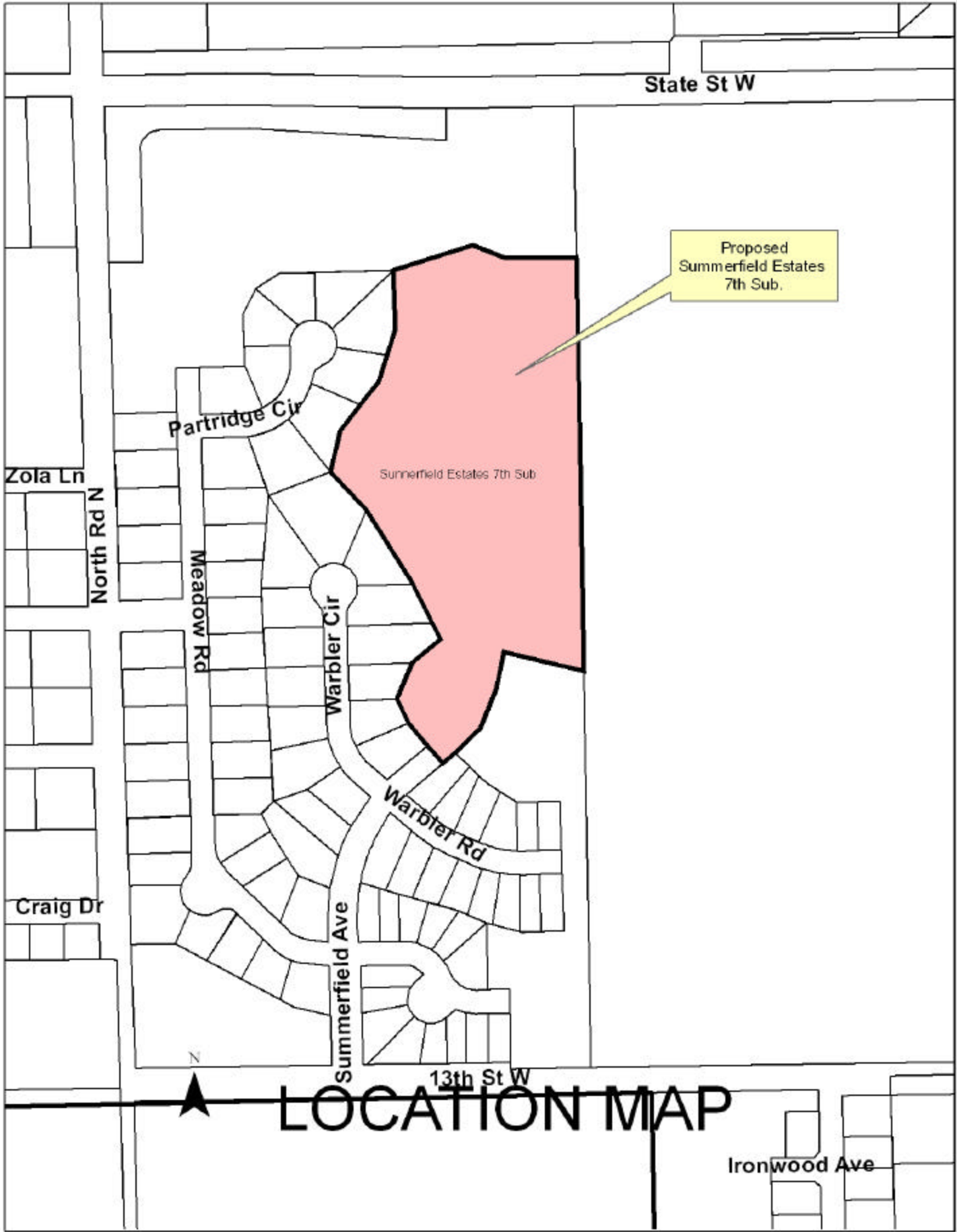

State St W

Proposed
Summerfield Estates
7th Sub.

Summerfield Estates 7th Sub

Partridge Cir

Zola Ln

North Rd N

Meadow Rd

Warbler Cir

Warbler Rd

Craig Dr

Summerfield Ave

13th St W



LOCATION MAP

Ironwood Ave

